

W² SECTION 23
 WILLIAM H REEDER
 W PE-54G-H-1
 ANCHOR EASEMENTS

COUNTY ROAD NO. 263
 W. PE - 54B
 R/W WIDTH 40 FT

OREGON SECONDARY STATE HWY. NO. 335
 (HAVANA - HELIX)
 W. PE.-54A
 R/W WIDTH 60 FT.

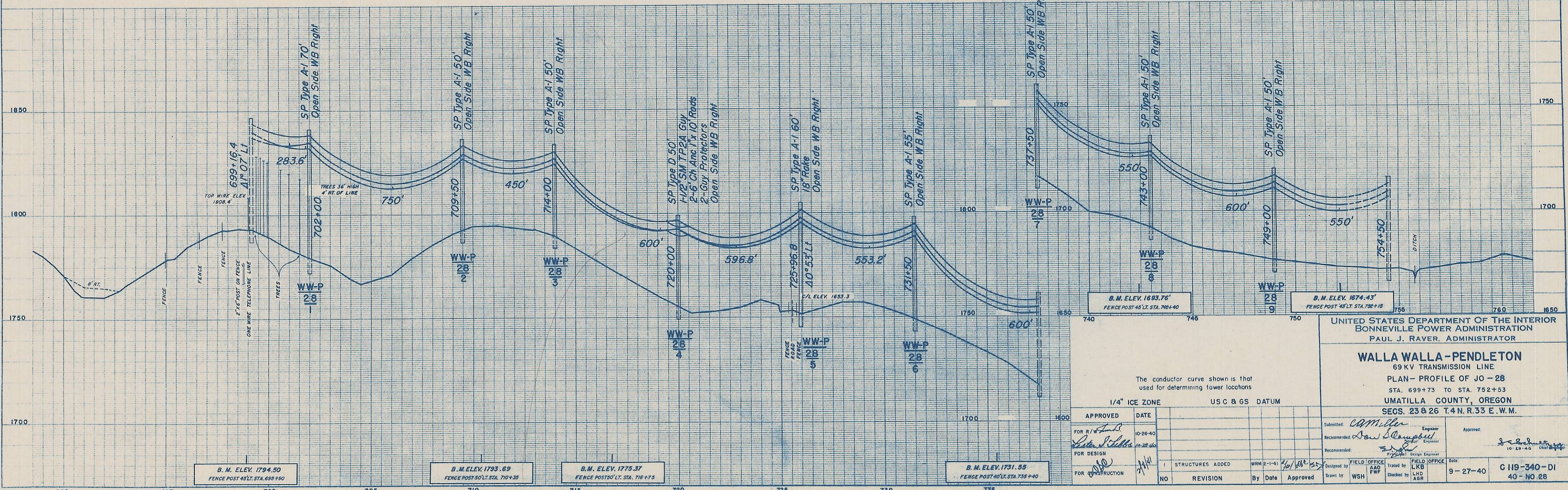
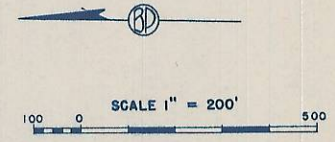

B. M. ELEV. 1794.50
 FENCE POST 45' LT. STA. 698+50

B. M. ELEV. 1793.69
 FENCE POST 50' LT. STA. 710+35

B. M. ELEV. 1775.37
 FENCE POST 50' LT. STA. 716+75

B. M. ELEV. 1731.55
 FENCE POST 40' LT. STA. 735+40

The conductor curve shown is that used for determining tower locations
 1/4" ICE ZONE USC & GS DATUM

APPROVED	DATE
FOR R/W	10-26-40
FOR DESIGN	10-28-40
FOR CONSTRUCTION	3/11/41

UNITED STATES DEPARTMENT OF THE INTERIOR
 BONNEVILLE POWER ADMINISTRATION
 PAUL J. RAVER, ADMINISTRATOR

WALLA WALLA - PENDLETON
 69 KV TRANSMISSION LINE
 PLAN - PROFILE OF JO - 28
 STA. 699+73 TO STA. 752+53
 UMATILLA COUNTY, OREGON
 SECS. 23 & 26 T.4 N. R.33 E. W.M.

Submitted: *CAM Miller* Engineer
 Recommended: *Don Campbell* Engineer
 Approved: *[Signature]* Chief Engineer

Designed by: *[Signature]* Design Engineer
 Checked by: *[Signature]* LHO AGR
 Date: 9-27-40

FIELD OFFICE: AAD PWF
 WSH

NO REVISION By Date Approved

C 119-340-DI
 40 - NO 28