

E² SECTION 12
 S.E. BROGOITTI, ADA R. BROGOITTI
 & MARTHA J. McALAVY
 W. PE.-49

NE⁴ SECTION 13
 AUGUST KUPERS
 W. PE.-50 3.01ACRES
 C/L R/W LENGTH 2624 FT.

S² SECTION 13
 S.E. BROGOITTI, ADA R. BROGOITTI
 & MARTHA J. McALAVY
 W. PE.-51 3.12 ACRES
 C/L R/W LENGTH 2722 FT.

NE⁴ NE⁴ SECTION 24
 GEORGIA B JOHNSON
 W. PE.-52
 ANCHOR EASEMENT
 OREGON SECONDARY STATE HWY. NO. 334
 (ATHENA - COLD SPRINGS)
 W. PE.-51A
 R/W WIDTH 60 FT

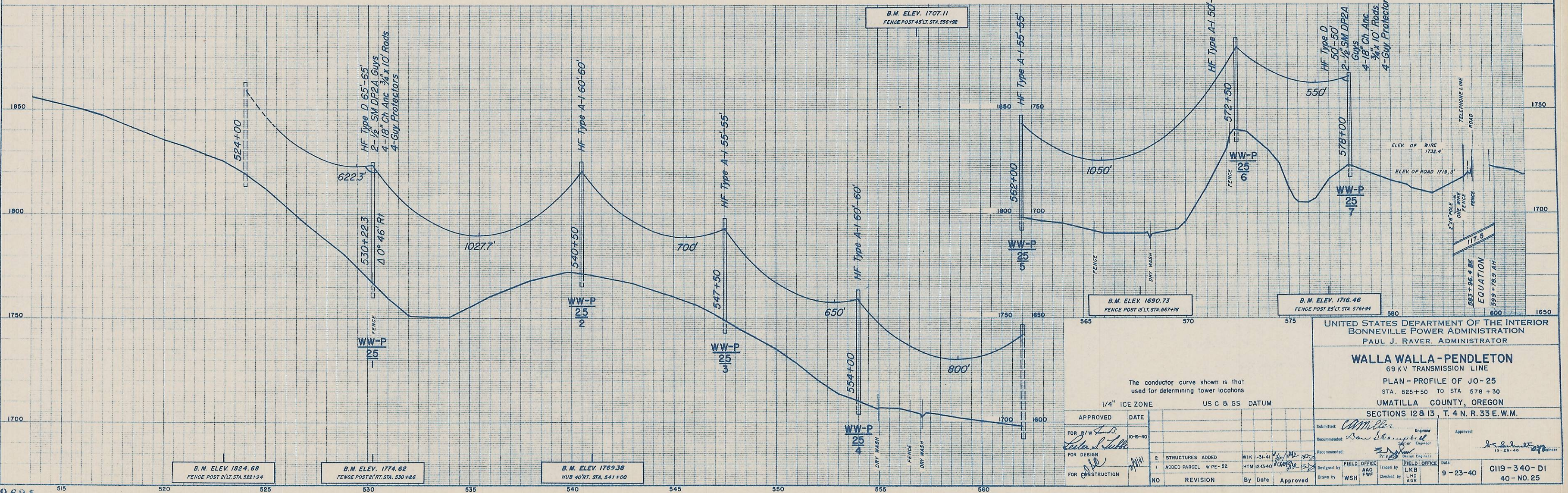

The conductor curve shown is that used for determining tower locations

1/4" ICE ZONE US C & GS DATUM

APPROVED	DATE	FOR DESIGN	FOR CONSTRUCTION
<i>Levin S. Latta</i>	10-19-40	<i>Levin S. Latta</i>	<i>Levin S. Latta</i>

NO	REVISION	By	Date	Approved
2	STRUCTURES ADDED	WIK	11-31-41	<i>WIK</i>
1	ADDED PARCEL W PE-52	HTM	12-15-40	<i>HTM</i>

DESIGNED BY	FIELD OFFICE	TRACED BY	FIELD OFFICE	DATE
WSH	WSH	LKB	LKB	9-23-40

Submitted	Recommended	Approved
<i>Camille</i>	<i>Camille</i>	<i>Camille</i>

UNITED STATES DEPARTMENT OF THE INTERIOR
 BONNEVILLE POWER ADMINISTRATION
 PAUL J. RAVER, ADMINISTRATOR

WALLA WALLA - PENDLETON
 69 KV TRANSMISSION LINE
 PLAN - PROFILE OF JO-25
 STA. 525+50 TO STA. 578+30
 UMATILLA COUNTY, OREGON
 SECTIONS 12 & 13, T. 4 N. R. 33 E. W.M.

9-23-40 C119-340-DI
 40-NO.25