

18 T. 2 N R. 36 E

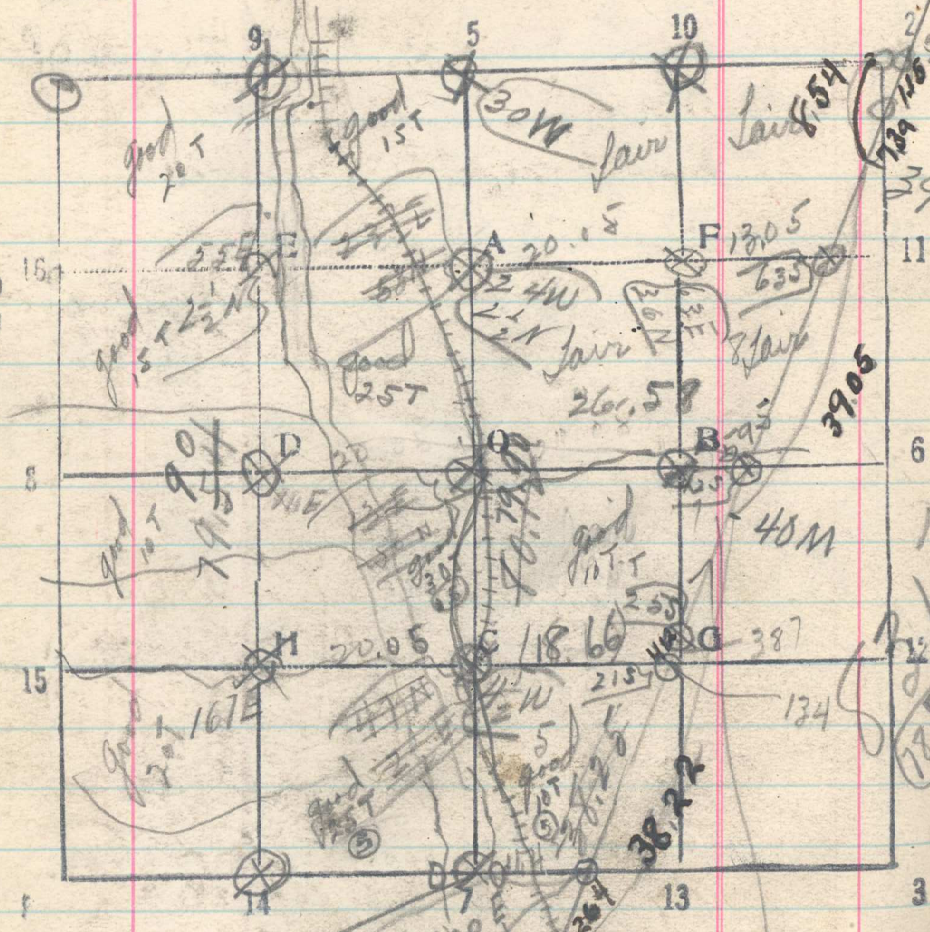

W.C. 120°E
130°W
560' S

40M cor. bears
N70°W 200 lks

570

12/20-21 line 9-14 South three west half
Set 20-40-60
1954 1/4 cor. 14 bears E 222 lks

11/20 Rechar Boundary N from C of 18+14
Set 21 - 25.12 - 4/2 - 63
35.5 F 40 M. Cor.
74.63 39 1/2 M. cor.

72.02 C.C. of 17+15
83.17 C.C. 17+8
1/2 line 5-7 Plymouth from center
Set 20-40-60
20.38 1/4 cor. bears W 44 lks
40.36 " " " " " 28 lks
60.36 " " " " " W 2 lks
79.90 1/4 cor bears E 12 lks

Exit from center to Boundary
20.05 Set Imp. 1/4 Cor B.
26.58 Bdy. Cor. lts 7+8 bears S 190 lks.
East from A to Boundary Set 20.05
34.22 (+112) Bdy. c. lts 8+9 bears N 6 lks