

19

Sec. 35 T. 2 N 34 E

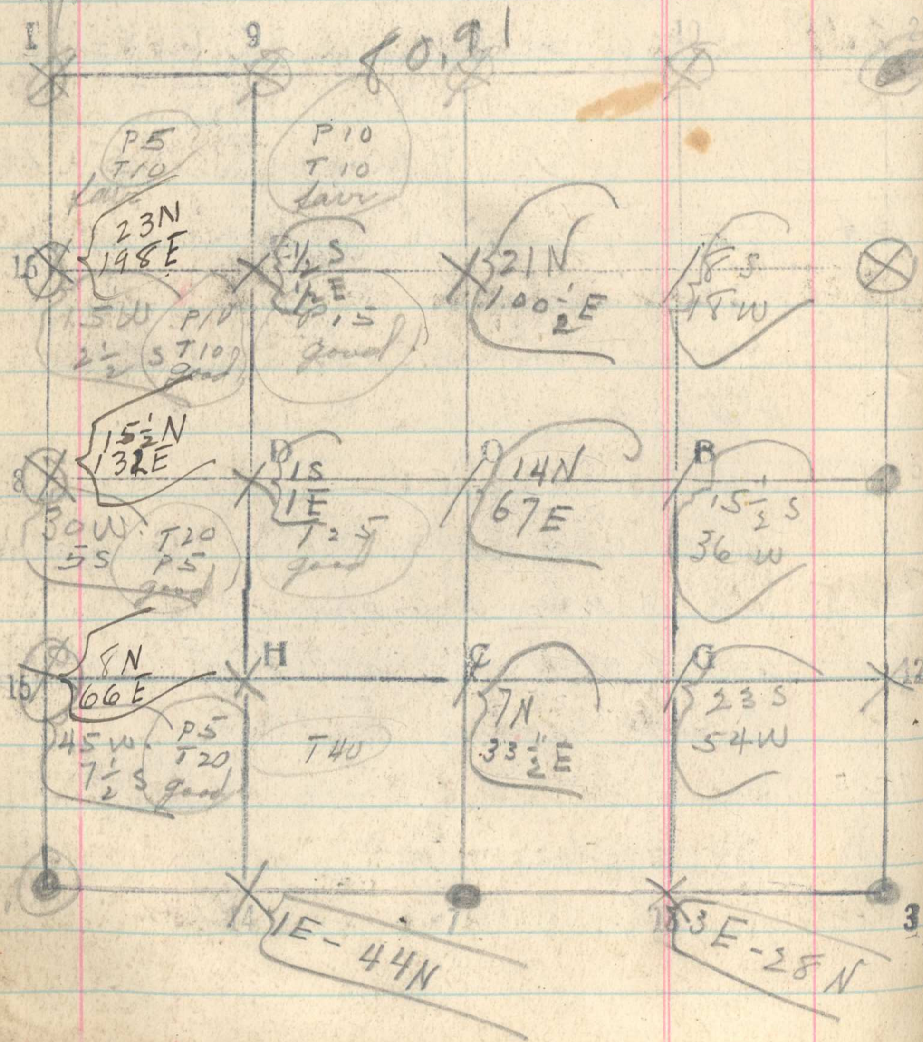

495

4/23

Line 10-13 South thru East half

Set 20-40-60

5 Road N30W - S30E

80.31 1/4 cor 13 bears W. 72 lks.

4/23

Line 7-5 North thru center

Set 20-40-60. 35 Creek 3 lks N.W.

80.28 1/4 cor. 5 bears. E. 134 lks.

4/25 line 1-4 South thru 34 1/35

Set 20.08-40.16-60.24

23 Creek 3 lks N 30 W.

60.42 old trap 1/6 cor. 15 bears W. 78 lks.

80.42 Sec. cor. 4 bears W. 60 lks.

4/28 line 9-14 South thru west half

10 Creek 5 lks N 60 W.

Set 20-40-60

43 Creek 5 lks N W.

80.02 1/6 cor 14 bears E. 2 lks.