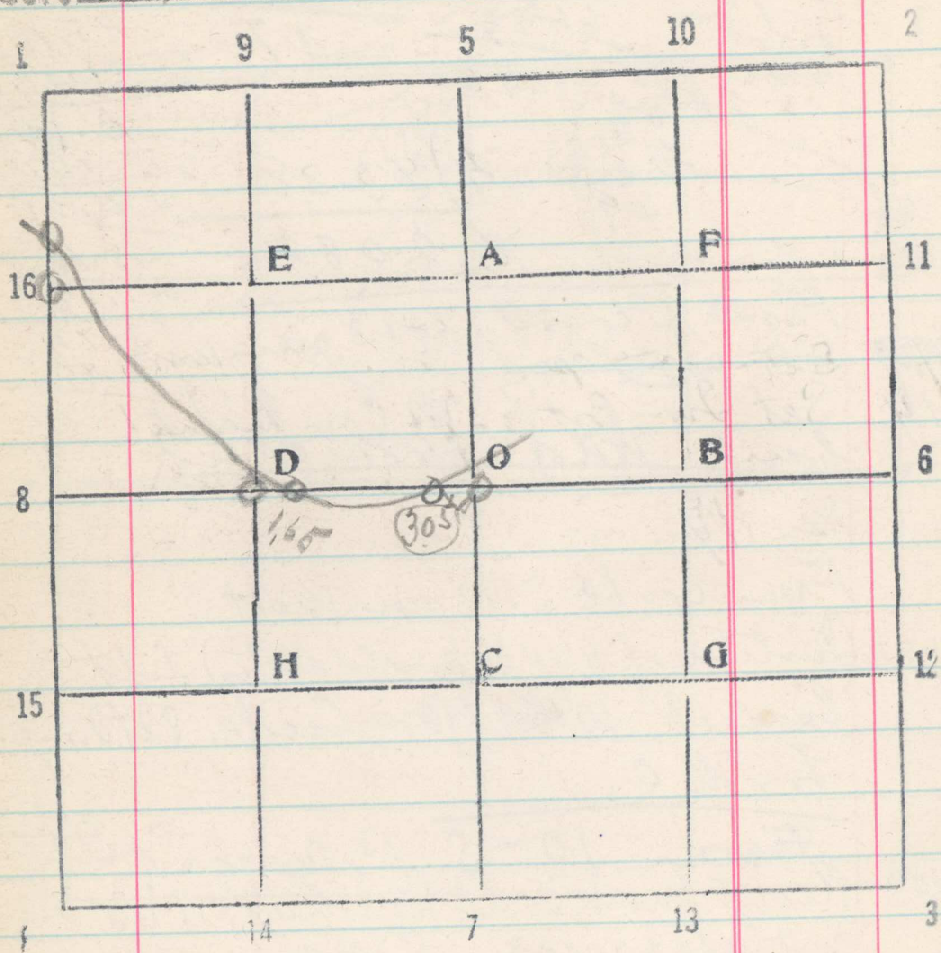

37

Sec. 18 T. 3N R. 96E

319

Jan 19, 1920,

From D-S. 18 run west
 305 Right bank of Wild Horse
 Creek $S 70^{\circ} W$ Set iron post for
M.C.

From D-S. 18 run East
 1.65 Right bank of Wild
 Horse creek $N 79^{\circ} W$.
 Set iron post for M.C.
 1/19/20