

36  
 Ser. 31 T. 2N 36E

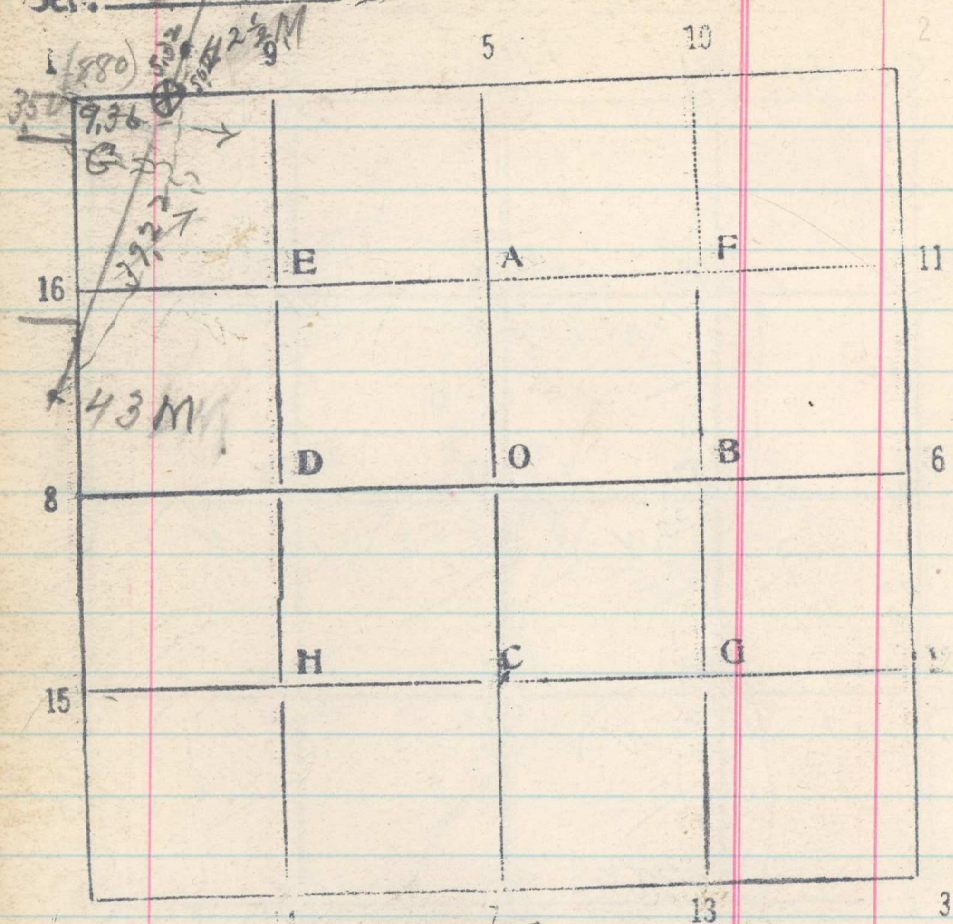

Aug. 12.  $S 89^{\circ} 29' E$  bet 30 + 31

8.80 No trace of c.c.

9.36 Intersect E bdy, Res. 5.22 Chrs

$S 20^{\circ} E$  of  $42 \frac{1}{2} M$  Cor. (supposed  
 to be  $50 \frac{1}{2}$  Chrs.  $S 20^{\circ} E$ )

271