

Surveyed for W.A. Coughanour March 8 1889
By J.W. Kimbrell County Surveyor Plat No 69

I commenced at the
1/4 Sec corner on North
Side Sec 22 in T6S R39 E
thence I run west var 20°
2000 Chain set stake for
1/8 corner
3991 the corner to Sec 15-16
21 1/2 24 25 lks South
of corner
from which I run
S 89° 30' E on line line
1995 Set Post for 1/8 corner
2656 the County S E & N W
3991 the 1/4 sec corner between
Sec 15 & 22

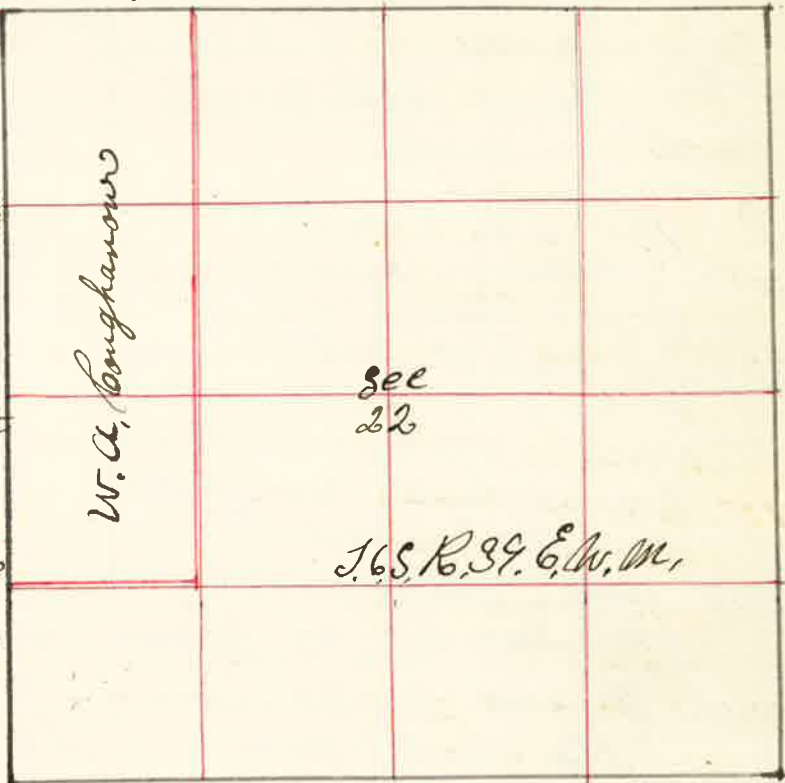

the corners to Sec 22 = 23 = 26 & 27 thence west var 18° 30' E
2000 Road N & S
4000 ditch N & S
4400 Willow brush offset 203 links South thence west
122 links across North powder River
5200 Set back North on line
6000 Set Stake for temporary 1/8 corner
7926 the corner to Sec 21 = 22 = 27 & 28 92 lks North of corner
from which I run East var 19° E
1981 1/2 Set Post for 1/8 corner
thence North var 20° E
2000 Set Stake for 1/16 corner in center S.W. 1/4 Sec 22
the corner to Sec 21 = 22 = 27 & 28 thence North var 20° E
2000 Set Stake for 1/8 corner
4000 the 1/4 sec corner between Sec 21 & 22 17 lks East from
from which I run South
2004 Set Stake for 1/8 corner on west side of W 1/4 Sec 22
J.W. Kimbrell County Surveyor

Surveyed for B.W. Grandy March 19th 1889
by J.W. Kimbrell County Surveyor Plat No. 70

for the establishment of
the corner to Sec. 5
5 = 6 = 7 & 8
I started at the
corner to Sec 7 = 8 = 17 & 18
thence North var 20° E
8000 Set Stake for temporary
corner
thence North var 21° E
4005 the 1/4 sec corner
between Sec 5 & 6
from which I run
South 1° E
4005 Set Stone 8 x 12 x 20
for corner to Sec.
5 = 6 = 7 & 8



J.W. Kimbrell County Surveyor

Surveyed for Wm Booth J.M. Sussett Warren Chandler & E.E. Willard March 20 1889
by J.W. Kimbrell Co. Surveyor Plat No. 71



for field notes see next page

Surveyed for Wm. Booth J. M. Sisset Warren Chandler & C. Willard March 2 1847

By Wm. Kimball County Surveyor Plat No 71

The corner to Sec 17=18=19 & 20 and 19 & 20=29 & 30 and 20=21=28 & 29 and the 1/4 Sec corners between Sec 17 & 2 and 19 & 21 and 20 & 21 and 20 & 29 and 19 & 30 and 19 & 21 being out of place or lost and obliterated, before commencing the survey I proceeded to re-establish the same as per instructions from the Hon. Commissioners of the General Land Office to U.S. Deputy S. as follows to wit:

I commenced at the S.W. corner Sec 19 on public meridian a mound pits & c.

Chains
 3997 Thence East var 20° E. on Offset of 500 links North
 Set Back South 500 links on line found no 1/4 Sec corner
 7997 U.S. Survey found no Sec corner Set Stake for temporary corner to Sec 19=20=28 & 30
 Thence East var 20° E.
 3990 Set Stake for temporary 1/4 Sec corner
 7980 Set Stake for temporary corner to Sec 20=21=28 & 29
 Thence East var 20° E.
 4000 Set Stake for temporary 1/4 Sec corner
 8148 the corners to Sec 21=22=28 & 29 making an Excess of 188 links as per U.S. Field notes I therefore run West
 4033 Set Stake for 1/4 Sec corner between Sec 21 and 28
 8066 the corners to Sec 20=21=28 & 29
 Thence West
 4023 1/4 Sec corner between Sec 20 & 29
 8046 the corner to Sec 19=20=28 & 30
 Thence West
 8063 the S.W. corner Sec 19

Chains
 The N.W. corner Sec 19
 Thence East var 20° E.
 the 1/4 Sec between Sec 18 & 19 in place
 Thence East var 20° E.
 4000 Set Stake for temporary corner to Sec 17=18=19 & 20
 Thence East var 20° E.
 3975 Set Stake for temporary 1/4 Sec corner
 8073 the corners to Sec 16=17=20 & 21 making an Excess of 123 links as per U.S. Field notes I therefore run West
 4016 Set Stake for 1/4 Sec corner to Sec 17=18=19 & 20
 8032 Set Stake for corner to Sec 17=18=19 & 20
 Thence West
 3991 the 1/4 Sec corner between Sec 18 & 19 this established the corners East and West only
 I then started at the corners Sec 32 & 33 on T. spine and run North between Sec 32 & 33
 4000 found no corner
 8000 found no corner
 Thence North between Sec 28 & 29
 4000 found no corner
 8000 set Stake for temporary corner

to Sec 20=21=28 & 29
 Thence North between Sec 20 & 21
 4000 Set Stake for 1/4 Sec corner
 4000 Set Stake for temporary 1/4 Sec corner
 6000 Set Stake for temporary 1/4 Sec corner
 8126 the corners to Sec 16=17=20 & 21 making an Excess of 126 links as per U.S. Field notes I therefore run South
 2010 Set Stone 4x9x21 inches for 1/4 Sec corner
 4021 Set Stone 4x7x26 inches for 1/4 Sec corner between Sec 20 & 21
 6031 Set Stone 8x10x32 inches for 1/4 Sec corner
 8042 Set Stone 9x10x24 for corners to Sec 20=21=28 & 29

I then started at the T. spine at corners to Sec 31 & 32 and run North between Sec 31 & 32 var 20° E.
 4000 found no corner
 8000 found no corner
 Thence North var 20° E.
 4000 found no 1/4 Sec corner
 8000 Set Stake for temporary corner to Sec 19=20=28 & 30
 Thence North var 20° E.
 4000 Set Stake for temporary 1/4 Sec corner
 8000 Set Stake for temporary corner to Sec 17=18=19 & 20
 Thence North
 4000 found no corner 1/4 Sec
 8163 the corners to Sec 8=9=17 & 18 making an Excess of 163 links as per U.S. Field notes I therefore run South
 8039 Set Stone 10x12x20 for corner to Sec 17=18=19 & 20
 Thence South var 20° E.
 4020 Set Stone 9x10x18 inches for 1/4 Sec corner between Sec 19 & 20
 8040 Set Stone 10x11x25 inches for corner to Sec 19=20=28 & 30
 the 1/4 Sec corner on North side Sec 21
 Thence South through Sec 21
 1992 Set Stone 8x12x18 for 1/4 Sec corner
 3984 Set Stone 9x12x24 for center

Sec. 21
 5976 Set Stone 10x12x23 for 1/16 corner in center of Sec 21
 7968 the 1/4 Sec corner on South side Sec 21. 0 Stake
 the 1/4 Sec corner on South side Sec 20 a Stone 8x10x24
 Thence North through Sec 20
 4021 center of Sec 20
 8041 the North boundary Sec 20
 55 links west of 1/4 Sec corner
 the 1/4 Sec corner on North side Sec 20 a Stone 9x10x20
 the 1/4 Sec corner on East side Sec 20 Thence West through Sec 20
 center a Stone 9x10x30
 4036 the 1/4 Sec corner on West side Sec 20
 Thence West through center Sec 19
 2009 1/4 corner - Stone 8x12x16
 8035 the 1/4 Sec corner on West side Sec 19
 the 1/4 Sec corner on North side Sec 19 Thence East
 the corner to Sec 17=18=19 & 20 from which I run West
 2027 Set Stone 6x9x18 for 1/4 corner
 Edward & Willard & Functionaries lost out of S.E. of NW 1/4 Sec 20
 the center Sec 20 a Stone 8x10x30
 Thence West 68 rods a Stone 6x16x30 inch
 Thence N 52° E 30 1/2 rods
 a Stone 8x10x23 inch
 Thence North 16 rods a Stone 8x10x19 inch
 Thence East 3x3x20 inch
 Thence South 3 1/4 rods 11 lbs to center Sec 20
 Wm. Kimball County Surveyor