

78 Surveyed for Mr Sailing Dec 29 1888

By J.W. Kimbrell County Surveyor Plat No 67

I commenced at the 1/4 Sec Point North & South on the East side Sec 30 thence west 7776 to the 1/4 Sec corner on west side Sec 30 from which I run East and at 3861 Chains set Stone for Center Sec 30

I commenced at the N.W. Corner Sec 30 thence South 8025 Chains to the S.W. corner Sec 30 from which I run North 4012 Chains set Stone marked 148 to 1/4 Sec corner on East side Sec 30

I then started at the S.W. South West corner Sec 30 thence East 3875 - Chas find No 14 Sec corner 7859. thence North fence runs N. 87 S, 7875 - find no Sec corner thence East 3860 chains wire fence 3950 chains wire fence 7906 chains the corner to Sec 28-29 = 32823 making a deficiency of 82 links in the 2 miles I therefore run West allowing 21870 links deficiency to each 1/2 mile and I marked a point for the 1/4 Sec corner on South side of Sec 30 from which I run North through center Sec 30 4021 chains I intersect first line E of W. at center Sec 30 8034 chains the 1/4 Sec corner on North side Sec 30

J.W. Kimbrell County Surveyor

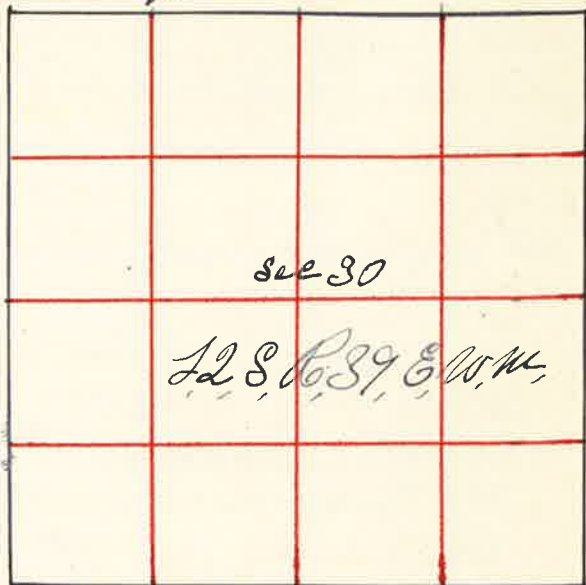

79 Surveyed for J.L. Carniss Feb. 14 1889

By J.W. Kimbrell County Surveyor Plat No. 68

I commenced at the S.E. corner Sec 2 thence North $\text{Var } 21^\circ \text{ E}$ 1100 chains Slough 2613 " Grand Pound River 104 links across 4000 " Set stake for temporary 1/4 Sec corner between 1 & 2 7973 chas I marked North boundary of Sec 2 127 links west of corner to Sec 1-2 = 35836 from which I run South $\text{Var } 20^\circ \text{ E}$ and at

3965 and I marked a point for 1/4 Sec corner from which I run West $\text{Var } 20^\circ$

- 1700 Grand Pound River or Slough 25 links wide
- 2200 Slough 25 links wide
- 3965- Slough 30 links wide &
- 4010 Set Stake for Center Sec 2
- 4800 Offset 87 links South thence West on offset
- 4900 Slough 50 links wide
- 5400 Set back North on line 59 links thence West
- Slough 30 links wide
- 6000 Set North 26 links on first line
- 7000 Offset North 50 links thence West on offset
- 7750 Slough 35 links wide
- 8085 West boundary Sec 2 Set back South 50 links 10 links South of 1/4 Sec corner on East side Sec 2

J.W. Kimbrell County Surveyor

