

By J.W. Kimbrell County Surveyor Plat No. 51

For the Subdivision of Sec. 27 and the Re-establishment of the 1/4 Sec corner between Sec 27 and 34 and 26 and 27 and the corner to Sec 26=27=34&35-

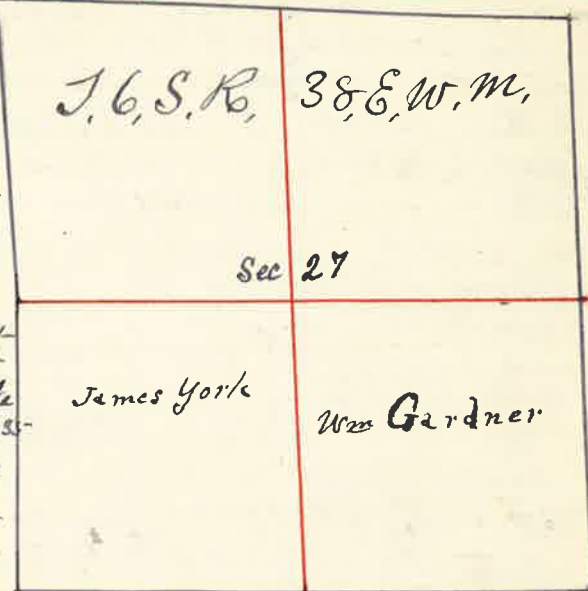

I commenced at the corner to Sec 25=26=35 & 36 thence west var 20° 15' East at 8070 chains set stake for temporary corner to Sec 26=27=34&35- in East side of James Hutchinsons Hay corral offset north 50 links to get passed Hay Stack 100 chains set back south on line on west side of Hay Stack thence west var 20° E 3995 chains set temporary stake for 1/4 Sec line 8013 chains west boundary Sec 27. 75 links North of corner to Sec 27=28=33 & 34 from which I run East on true line having an excess of 18 links in the 2 mile or 4 1/2 links to each 1/2 mile I therefore at 4000 chains set post in slough marked U.S. for 1/4 Sec line between Sec 27 & 34 and at 7999 chains brought me to the East side of Hutchinsons Hay Stack could not plant corner. and drove witness stakes 2 East respectively 10 and 24 links East and 30 & 50 links North of true corner which is under the East side and 28 links South of North end of Hay Stack Oct. 13, 1888

I started at light tree on Township line between Sec 33 & 34 thence East 1650 chains 1/4 Sec 5650 chains corner to Sec 3=4 34 & 35 thence East 80 chains found no corner thence East 4042 chains the 1/4 Sec corner between Sec 27 & 35 making an excess of 42 links in 2 miles U.S. field notes I started at N.E. corner Sec. 27 thence South 2° 45' E at 4000 chains set barrel stake for 1/4 Sec. corner 8084 chains corner under Hay Stack 4125 chains 1/4 Sec corner between Sec 34 & 35 making an excess of 125 links over U.S. field notes. thence North 4041 chains corner to Sec 26=27=34 & 35- thence North 4042 chains planted stake and stake for 1/4 Sec corner between Sec 26 & 27 thence West through Sec 27 40 chains set post for temporary center Sec 27 7860 chains the 1/4 Sec corner on west side Sec 27 I then started at 1/4 corner on South side Sec. 27 thence North through Sec 27 var 22° E 4020 the center 8290 chains North boundary 90 links East of 1/4 Sec corner on North side Sec 27 thence South 4270 chains set stone 14x18x20 inch for center Sec 27

J.W. Kimbrell County Surveyor

By J.W. Kimbrell County Surveyor Plat No. 52

I commenced at the corner to Sec 20=21=28 & 29 thence West 5911 chains toward River 347 links across 5962 1/2 chains set post for temporary 1/4 corner 7950 set stake for temporary Sec corner thence West 40 chains set stake for temporary 1/4 Sec corner 8117 chains West boundary Sec. 30 making an excess 197 links over the U.S. field notes in the 2 miles I therefore run East on line between Sec 29 and 30 and at 3968 chains set stone 6x10x27 for 1/4 Sec corner between Sec 19 and 30 and at 8020



chains set stone 5x7x18 for corner to Sec 19=20=29 & 30 2011 chains set stone marked 1/2 for 1/2 corner on South side of S.W. 1/4 Sec. 20 I then started at N.E. corner of Sec 30 thence South 40 chains set temporary stake for 1/4 Sec corner 8052 chains the corner to Sec 29=30=31 & 32. from which I run North and at 4026 chains set stone marked 1/4 for 1/4 Sec corner between Sec 29 & 30 thence West through center Sec 30 4055 chains center Sec 30 and at 8023 chains West boundary Sec 30 I then started at S.E. corner Sec. 30 thence West 4000 chains set temporary stake for 1/4 Sec. corner 7983 chains West boundary at corner to Sec 30=31=25 & 36 making an excess of 83 links over U.S. field notes I therefore run East 3941 chains set stake for initial point 35 links West of a stone set by Moses Austin County Surveyor for 1/4 Sec corner between Sec 30 & 31 I then started at my initial point for 1/4 Sec corner on South side Sec 30 and run North through center Sec 30 at 4022 chains the center Sec 30 at 8040 chains 1/4 Sec corner on North side Sec 30. from which I run South 4021 chains and set stone marked C.S. for center Sec 30 in T. 1 S. R. 39 E. W. M.

P.S. Before commencing this survey I started at the S.W. corner Sec 30 and ran North on range line between T 1 S Ranged 38 & 39 to test the correctness of corners claimed by residences as original U.S. survey corners and find them to correspond with all corners planted on this range line between known corners. i.e. 12 to 13 links excess on each 1/2 mile over U.S. Survey field notes

J.W. Kimbrell County Surveyor