

PLAT AND RECORD OF SURVEY No. 7617

Charged for J. Vincent & A. Newman and Sarah M. Banks July the 24 1898-

State Line 36 N 63 58

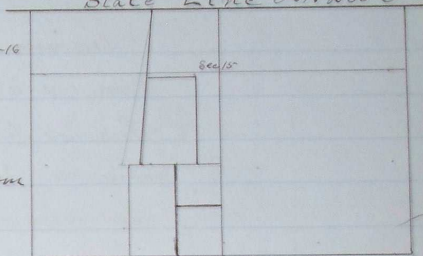

I commenced at the cor to Sec 15-16
21 822 which is a Stone
in place

Hence I run East on random
line bet Sec 15 & 22

Var 19° E

- 8 57 Bluff descend
10 52 foot of Bluff course NW & SE
16 50 Rough course N
40 00 could find no 1/4 Sec cor none of the old littles have cor seen it
40 30 creek runs NW
78 66 The corner to Sec 14-15-22 & 23 set in back said to have
been set by county surveyor several years ago
Hence I run west on true line
39 33 set Stone 12+6+6 for 1/4 Sec cor in center of Road
Hence I run North through center Sec 15-

Var 21° E

- 10 50 set temporary 1/2 cor
19 95 the 1/4 corner set by L. A. Wilson
37 95 the 1/4 corner set " " for center Sec 15-
58 10 the 1/4 Sec corner of State line on North Body Sec 15
set Stone 15+6x4 marked 1/4 on S face
Hence I run west along State line on North Body Sec 15
14 03 to J. D. Vincents NW corner
Hence I 4° 30' W on West Body of Vincents land
18 73 J. D. Vincents SW cor and Mrs Sarah M. Banks NW cor
38 17 S west cor of Mrs Banks land
Hence East on South Body Mrs Banks land
11 35 Mrs Banks SE corner and J. D. Vincents S W cor
16 52 the center Sta. Sec 15-

Course. Degrees. Minutes. Chains. Links.

- J. S. Vincents Land described as follows tract
 Commenced at the center of S 1/2 Sec 15
 ran North through center Sec 15
 33 15 to State line at the 1/4 Sec corner on North Bdy Sec 15
 thence west on North Bdy Sec 15
 140 3 to NW corner set Stone 12 x 6 x 5
 thence S 4° 30' W on West Bdy
 137 3 to SW cor. set Post
 thence East
 990 to Interior corner which is also Mrs Banks N E cor.
 thence south on West Bdy ^{set Stone 12 x 6 x 4}
 1942 to SW corner also Mrs Banks S E cor. set Stone 12 x 6 x 5
 thence East on South Bdy
 517 to S E corner and Place of Beginning a Stone 10 x 6 x 5

Mrs. Sarah Banks Land described as follows tract
 Commenced at a Point 517 chs west of the center of Sec 15
 thence North 1942 chs thence west 990 chs thence S 4° 30' W
 1944 thence East 1185 chs to Place of Beginning

F A Newmans Land The N 6 1/4 of the S 6 1/4 of the S 8 1/4 of
 the S W 1/4 Sec 15

I commenced at the center S 1/2 Sec 15
 thence west through center S W 1/4 Sec 15

39 35 State lot line bet. Sec 15 & 16

thence ran East on Town line

29 51 1/4 set Stone 9 x 6 x 5 South 995 chs set Stone 11 x 6 x 4 for S W cor

thence East 98 3 3/4 set Stone 12 x 7 x 4 for S E corner

thence North 997 1/2 to Place of Beginning

John W. Vincibles

County Surveyor