

PLAT AND RECORD OF SURVEY No. 73

Surveyed For the P. Ely Estate for the purpose of dividing for Heirs
By request of C. M. Ely Executor or administrator

April the 10-11 & 12 1895

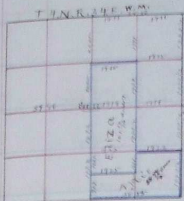

I Commenced at the corner to Secs 19-20-29nd & 30

thence North on random line bet Secs 19 & 20

Var 21° E.

16 25 Set Temporary fractional corner

40 50 could find NW $\frac{1}{4}$ Sec corner set Temporary $\frac{1}{4}$ Sec cor

80 78 Intersect 257 lks west of the corner to Secs 17-18-19th & 20

S $1^{\circ} 51'$ W on True line

40 37 Set Stone 17x7x6 for $\frac{1}{4}$ Sec cor bet Secs 19th & 20

64 32 Set Stone 16x8x7 for fractional corner

80 78 the corner to Secs 19-20-29th & 30

thence East bet Secs 20th & 29 on random line

Var 21° E

960 Set Temporary fractional corner

20 50 Set Temporary $\frac{1}{16}$ corner

40 18 I intersect 14 lks North of the $\frac{1}{4}$ Sec corner point reestablished
by setting Stone 14x7x6 for $\frac{1}{4}$ Sec cor

N $89^{\circ} 48'$ W on True line

20 09 Set Stone 12x6x6 for $\frac{1}{16}$ corner

30 53 Set Stone 16x8x7 for fractional cor.

40 18 the corner to Secs 19-20-29th & 30

from the $\frac{1}{4}$ Sec corner bet Secs 20 & 29 I run

North on random line through center 20

Var $19^{\circ} 25'$ E

22 36 $\frac{1}{2}$ Set Temporary fractional cor

40 00 Set Temporary $\frac{1}{16}$ cor for center Sec 20

83 60 I intersect 43 lks west of the $\frac{1}{4}$ Sec cor bet Secs 17 & 20

PLAT AND RECORD OF SURVEY No. 7119

317

Sec 22 T4N R34E W2E

I commenced at the corner to Secs 22-23-26th & 27
 which is at the intersection of fences N 88° 45' W I find Point of old Stake
 and set stone 12 x 6 x 6 for cor.

thence I run

North bet Secs 22nd & 23 on random line

Var 21° 10' E

20 00 set temporary 1/16 cor.

39 10 fence 6 8/4 W into road

39 95 " 6 8/4 W leave "

40 00 could find no evidence of 1/4 Sec cor - set temporary 1/4 Sec cor

60 00 set temporary 1/16 cor

79 75 to the corner to Secs 14-15-22 & 23 set Stone 14 x 8 x 6 for cor

South on True line bet Secs 22 & 23

19 93 1/4 set Stake for 1/16 cor point

39 87 1/2 set Stone 17 x 12 x 8 for 1/4 Sec cor in north edge of Road 8 5/4 W

59 80 set Stone 18 x 9 x 9 for 1/16 corner

79 75 to the cor to Secs 22-23-26 & 27

from the cor to Secs 14-15-22 & 23 I run west

on random line bet Secs 15 & 22

20 00 set temporary 1/16 corner

23 00 creek runs South

38 22 the 1/4 Sec corner point set Stone 14 x 7 x 6 for 1/4 Sec cor in center of corner N 45°

East on True line

19 11 set Stake for 1/16 corner point

38 22 the cor to Secs 14-16-22 & 23

from the 1/4 Sec corner bet Secs 15 & 22

I run South on random line through center Sec 22

Var 21° 25' E

20 00 set temporary 1/16 cor

40 00 set temporary 1/16 cor for center Sec 22

53 00 creek runs 8/4 W

Course	Degrees	Minutes	Chains	Links
--------	---------	---------	--------	-------

60 80 Set Temporary 1/4 corner

79 55 Intersect 5 1/2 Sec East of the 1/4 Sec cor bet Sec 22 & 27

I find Point of old at corner Point - 12 ins below surface

deposited the same about 16 inches bet Stone 14+7+6 for 1/4 Sec

No 2' E on same line through center Sec 22

Course

I commence at the 1/4 Sec cor bet Sec 22 & 23

N 89° 1' West on random line through center Sec 22

No 22° 10' E

19 57 Set Temporary 1/4 corner

38 38 Intersect True N 8 1/2 Sec 14 1/2 Sec South of foot State on N 8 1/2 Sec

78 18 Intersect 8 1/2 Sec South of 1/4 Sec Point - bet Sec 21 & 22

S 88° 58' E on True line

39 80 Set Stone 19+6+8 for 1/4 corner in center Sec 22

58 99 Set Stone 10+8+7 for 1/4 corner in center Sec 22

78 18 the 1/4 Sec cor bet Sec 22 & 23

from the 1/4 Sec cor bet Sec 22 & 22 I run

S 89° 7' E on Random line bet Sec 22 & 27

No 20° 50' E

20 57 Set Temporary 1/4 corner

38 55 the cor to Sec 22-23-26 & 27

West on True line

19 27 1/2 Set Post for 1/4 corner

38 55 the 1/4 Sec corner bet Sec 22 & 27

Then No 2' E on True line through center Sec 22

9 07 Set Stone 21+7+6 for fractional corner

19 72 1/2 Set Stone 10+8+6 for 1/4 corner

39 45 the 1/4 corner in center Sec 22

59 50 Set Stone 22+8+6 for 1/4 corner

79 55 the 1/4 Sec cor.

PLAT AND RECORD OF SURVEY No. PLAT

I Commenced at the $\frac{1}{16}$ corner on N Boundary N $81^{\circ}4'$ Sec 22
 Thence South through cuts $8\frac{1}{2}$ Sec 22

19 99 $\frac{1}{2}$ Set Stone 25+12+4 for $\frac{1}{16}$ corner

39 98 $\frac{1}{2}$ the $\frac{1}{16}$ corner in cuts $8\frac{1}{2}$ Sec 22

59 82 Set Stone 20+9+6 for $\frac{1}{16}$ corner

70 53 Set Stone 18+9+7 for fractional corner

78 83 the $\frac{1}{16}$ corner on South Boundary S $81^{\circ}4'$ Sec 22

John W. C. White

County Surveyor