

PLAT AND RECORD OF SURVEY No. 66

By request of J. H. Whitmore John Cook and Herman Wainberg

Nov 19th 1894

Course Degrees Minutes Chains Links

Township 2 North Range 32 S. W. M.

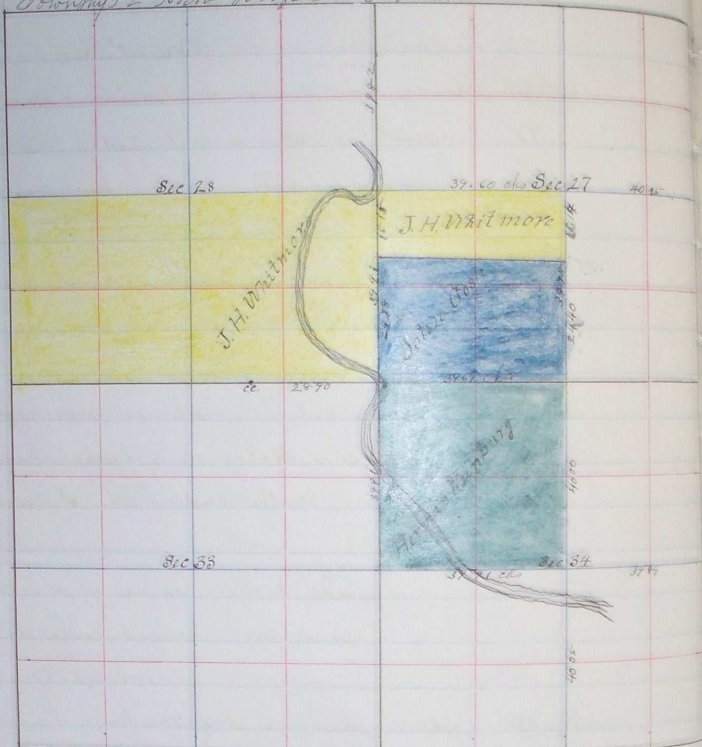

Start to intell and Mel. Kolt born chainman
 I commenced at the 1/4 sec corner bet secs 28 & 34
 Thence west bet secs 27 & 34

- 39 75 Var 20° 30' S
- 40 00 Right Bank of me Key creek course North
- 40 00 bet temporary cor bet secs 27-28-33 & 34
- Thence west on same line
- Var 21° 30' S
- 1 00 Left bank of me Key creek course NW
- 28 57 Intersect 232 lks South of the closing corner on separation boundary bet secs 28 & 33
- S 85° 54' E on true line
- 28 90 Proportional dist - for cor to secs 27-28-33 & 34
- Thence East
- 39 67 the 1/4 sec cor bet secs 27 & 34

PLAT AND RECORD OF SURVEY No. 7119

Acres Run Date Link

Commencing at the 1/4 Sec cor bet Sec 33 & 34

Thence North bet Sec 33 & 34

Var 21° E

19 75 one 1/2 way creek runs N 20° W

37 75 Intersect 88 W line 10 lbs east of first survey stake

40 70 Set survey corner for cor to Sec 27-28-33 & 34

Thence North bet Secs 27 & 28

39 52 Intersect 160 lbs west of the point for 1/4 Sec corner bet Sec 27 & 28
in bed of one 1/2 way creek

S 0 32' W on true line

74 91 Set Post in old bed of creek for corner to Secs 27-28-33 & 34

and Drive Stakes for witness to corner on Bank of creek
North - South and East of corner

I commenced at the 1/4 Sec cor bet Secs 27 & 28

Thence East through center Sec 27

Var 21° E

40 Right Bank of one 1/2 way creek

40 50 Set survey stake for center

79 85 Intersect 28 lbs North of the 1/4 Sec cor bet Secs 26 & 27

N 89° 48' W on true line

40 25 The center Sec 27

79 85 The 1/4 Sec cor bet Secs 27 & 28

I commenced at the 1/4 Sec cor bet Secs 27 & 34

Thence North through center Sec 27

Var 21° S

39 75 Intersect - 15 lbs west of first stake set on 88 W line in creek

79 57 Intersect - 50 lbs East of the 1/4 Sec cor bet Secs 26 & 27

S 0 48' E on true line

37 82 Set Stone 14 + 540 in mound of Stone for 1/4 cor in
center Sec 27

79 57 The 1/4 Sec cor bet Secs 27 & 34

