

PLAT AND RECORD OF SURVEY No. 37

Request of David Brown and T. C. Stahl, Nov. 28th. 1888.

Course. Degree. Minutes. Chains. Links.

Subdivision of sec 33rd & 34th T. 37 N. R. 30 E. W. M.

Assisted by J. M. Jarvis and Emma Hevel, sworn chainmen, Nov. 28th 1888,
I commence at cor. to sec. 32 & 33, on line bet. Tps. 3 & 2 N. in R. 30 E. W. M., which
is the original sec. post in a stone mound on hill side facing South, and
run on random Sp. line, using a solar instrument - course by same - asent

East.

1 50 Ravine, runs nearly S. 72. 21° E.

6 50 " " S.W.

12 50 Summit.

16 00 Ravine.

40 00 Set temp. $\frac{1}{4}$ sec. - I find no indications of original cor.

80 86 Int. 7 & 8 line 144 links South of cor. to sec. 33 & 34, identified by
A. C. Snow, who has preserved its locality. - At true cor. point, I set a flat por-
ous, basalt stone, mkd. 3 notches on E, and 3 notches on W. and + on top.

I move temp. $\frac{1}{4}$ sec. cor. on S. bay. sec. 33, East 43 links, then N.
72 links, and set a flat basalt stone, 17x12x5 ins. 16 ins. in ground for $\frac{1}{4}$ sec. cor.,
mkd. $\frac{1}{4}$ on N. face.

East

From cor. to sec. 33 & 34, run on random Sp. line, along fence

32 80 Wire fence, course N.

40 00 Set temp. $\frac{1}{4}$ sec. cor.

43 40 Cor. fences W. & S. - old furrow E.

75 50 Ravine, course S.

80 00 Set Temp. cor. to sec. 34 & 35 - Find no traces of original cor.

120 00 " " $\frac{1}{4}$ sec. cor. " " " " " "

160 00 " " sec. " " " " " " " "

200 00 " " $\frac{1}{4}$ sec. " " " " " " " "

241 20 Int. 2 & 3 line 135 links N. from S.E. cor. of T. 37 N. R. 30 E, which is
the chanced end of original post in mound, from which the S.E. cor. of the Walker
School House bears N. 36° W. 34 links dist. This cor. is verified by Mr. Tho^s Baker.

At point, verified by Tho^s Baker, who is present - for original
cor. to sec. 35 & 36, on Sp. line, ^{Set} a basalt stone, 16x10x8 ins. 16 ins. in ground for
sec. cor., mkd. 5 notches on W. and 1 notch on E, on S.E. hill side, west of a
ravine course S.E. This cor. is 64 links East, and 150 links S. of temp. sec. cor.

PLAT AND RECORD OF SURVEY No. 37

Corn.	Degrees.	Minutes.	Chains.	Links.
-------	----------	----------	---------	--------

Corrections:—

 $150 \div 2 = 75$; $64 \div 2 = 32$. ∴ I move temp. sec. cor. to sec. 34+35

East 32 links, then south 75 links, and set a basalt stone $18 \times 12 \times 6$ ins. mkd. 4 notches on west face, and 2 notches on E. face.

I move temp. $\frac{1}{4}$ S. cor., on S. bndy sec. 34, East, 16 links, then South $37\frac{1}{2}$ links and set a basalt stone, mkd. $\frac{1}{4}$ on N. face, 14 ins. in ground, on gentle N.E. slope.

North, on a random line bet. sec. 34+35. va. 21° E.

2 25 Commence slight ascent

7 00 Summit.

40 00 Set temp. $\frac{1}{4}$ sec. cor. — No traces of original $\frac{1}{4}$ sec. cor. —

40 26 Wire fence E. & W. — line intersects $67\frac{1}{2}$ lks E. of cor. fences, E. and W.S.

79 80 " " " on S. side of lane.

80 23 Int. E. & W. line 27 links of cor. to sec. 26-27-34-35, which is a point in road in center of lane, E. & W. well verified by Mr. Sprowl.

At true cor. point, I set a porous basalt stone $16 \times 11 \times 8$ ins. 16 in main ground, for cor. to sec. 26-27-34-35, mkd. 2 notches on E., and 1 notch on S.

∴ I move temp. $\frac{1}{4}$ sec. cor. $11\frac{1}{2}$ lks N., then $13\frac{1}{2}$ links W. and set a porous red basaltic stone, $18 \times 10 \times 6$ ins. mkd. (dimly) $\frac{1}{4}$ on W. face.

Next on a random bet. sec. 27+34

0 80 Water channel of small ravine, course, nearly N.

2 50 T. C. Stahl's house, bears S., about 150 links dist.

40 00 Set temp. $\frac{1}{4}$ sec. cor. — Find no indications of Gov. cor.

79 32 Int. N. & S. line, $27\frac{1}{2}$ links north of sec. cor.

Friday Nov. 30th 1888.

Set a flat basalt stone, $17 \times 11 \times 5$ ins. 15 ins. in ground, for cor. to sec. 27-28-33+34, mkd. 3 notches on E. side, and 1 notch on S. cor., at point, verified by Jno. Lawson, Jno. Morton & Mr. Sprowl.

I move temp. $\frac{1}{4}$ sec. cor., on N. bndy, sec. 34, East 34 links, then South $13\frac{3}{4}$ links, and set a soft red basalt stone, $20 \times 11 \times 5$ ins. 18 ins. in ground for $\frac{1}{4}$ sec. cor., mkd. $\frac{1}{4}$, on North face.

Cours.	Degrees.	Minutes.	Chains.	Links.
--------	----------	----------	---------	--------

South on random line, bet. secs. 32 & 33. T.A. 21° E.

4 00 Ravine, course nearly west.

8 00 " " N.W.

40 00 Set temp. $\frac{1}{4}$ sec. cor.; find no traces of original cor.

66 70 Wire fence, bears E & W.

66 90 Road, " "

79 93 Int. E & W line, at cor. to secs. 32, 33, which is the

original sec. post, lower end charred, in mound of stone, on S. hill side (C. 191)

Move temp. $\frac{1}{4}$ sec. bet. secs. 32 & 33, north, $3\frac{1}{2}$ links, and set a flat basalt stone, 15x11x2 ins., mkd. $\frac{1}{4}$ on W. face, set 13 ins. in ground.

West, on a random line bet. secs. 28 & 33 T.A. 21°

40 00 Set temp. $\frac{1}{4}$ sec. cor.; find no indications of lost $\frac{1}{4}$ sec. cor.

80 12 Int. N. & S. line 17 $\frac{3}{4}$ links south of true sec. cor. point, as verified

by Jack Morton, who has long and well known of same, while it was in good state of preservation.

Move temp. $\frac{1}{4}$ sec. cor., west 6 links, then $8\frac{3}{4}$ links north, and set a basalt stone 15x12x7 ins., 14 ins. in ground for $\frac{1}{4}$ sec. cor. bet. secs. 28 & 33, mkd. $\frac{1}{4}$ on N. face, on gentle N. slope.

North, on a random line bet. secs. 33 & 34. - A bend along fence

4 70 Summit.

38 06 Cor. fences N. S. & E. - some indications of md, trench & pits.

40 00 Set temp. $\frac{1}{4}$ sec. cor.

78 09 Wire fence on S. side of lane, E & W.

78 58 Center of lane.

79 81 Int. E & W line, $2\frac{3}{4}$ links west of sec. cor. to secs. 27-28-33-34.

Move temp. $\frac{1}{4}$ sec. S. $9\frac{1}{2}$ links, then E. $1\frac{3}{8}$ links, and set a basalt stone 18x13x5 ins., 16 ins. in ground for $\frac{1}{4}$ sec. cor. bet. secs. 33 & 34, mkd. $\frac{1}{4}$ on W.

I run true lines, connecting opposite $\frac{1}{4}$ sec. corners, N. & S. and E. & W. through centers of secs. 33 & 34, and at points of intersection of the $\frac{1}{4}$ sec. lines, so run, I set corners, to wit: -

PLAT AND RECORD OF SURVEY No. 3719

Course Degrees Minutes Chains Links

For center cor. to sec. 33, set a porous red basalt stone 16x14x7 ins., 15 ins. in ground, marked, C.P. on N.

For center cor. to sec. 34, set a basalt stone 15x9x6 ins., 13 ins. in ground, marked, C.S. on N.

Survey commenced Nov. 28th and completed Dec. 2nd. 1888.

Jno. C. Arnold, County Surveyor.

Plat of Secs. 33 & 34, T. 3 N. R. 30 E. N. 7 W.

Explanations

Directions as for all maps.
o indicates stone cor.
Scale 40 chs. = 1 1/2 ins.

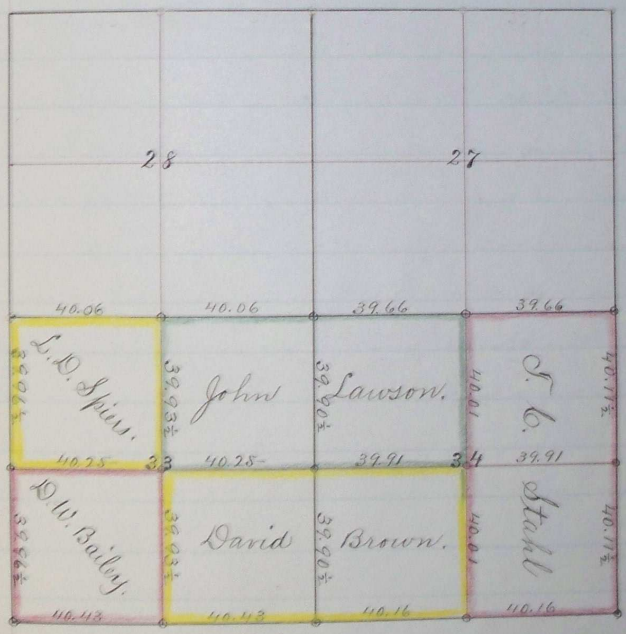

Jno. C. Arnold, County Surveyor.