

Township 3 North Range 82 East

4253

Sections	Area
1	640.00
2	640.00
3	640.00
4	640.00
5	640.00
6	640.00
7	640.00
8	640.00
9	640.00
10	640.00
11	640.00
12	640.00
13	640.00
14	640.00
15	640.00
16	640.00
17	640.00
18	640.00
19	640.00
20	640.00
21	640.00
22	640.00
23	640.00
24	640.00
25	640.00
26	640.00
27	640.00
28	640.00
29	640.00
30	640.00
31	640.00
32	640.00
33	640.00
34	640.00
35	640.00
36	640.00
37	640.00
38	640.00
39	640.00
40	640.00
41	640.00
42	640.00
43	640.00
44	640.00
45	640.00
46	640.00
<b>Total</b>	<b>32000.00</b>

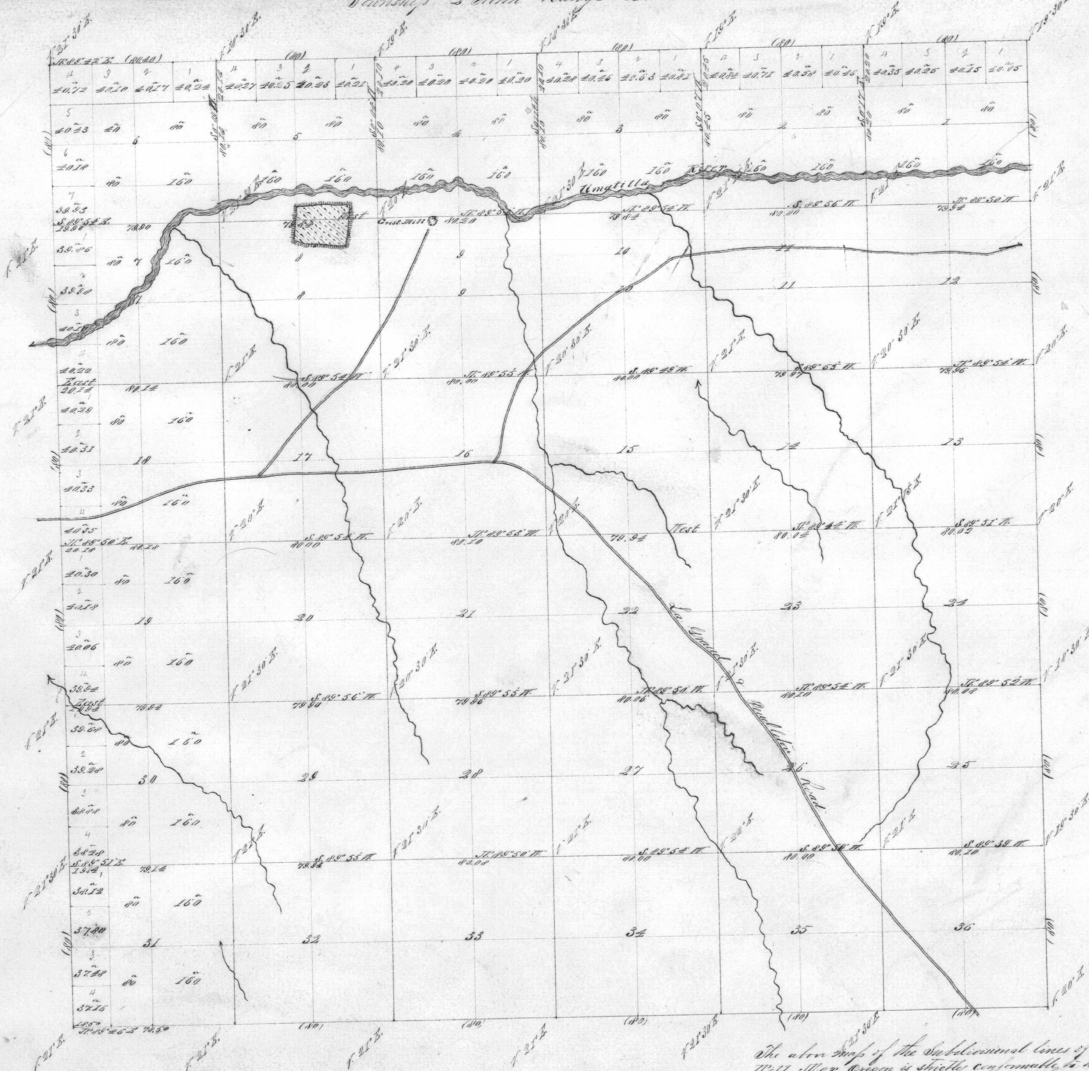

General Description  
The north 75 of this township  
is good tillable land the  
south is adapted to grazing

The above map of the described lines of T. 3 N. R. 82 E.  
T. 3 N. R. 82 E. is truly and correctly as the original field  
notes of the survey stored in file in this office which have been  
examined and approved  
A. G. Sawyer Surveyor General  
August 15th 1871

W. H. Cole  
Surveyor General Oregon

Name	Contractors	Contract	Date	Int. Survey	Commenced	Completed
Subdivision	J. E. Moody	248	April 28 1871	60 00 30	June 23 1871	June 9 1872