

6-39-A

TOWNSHIP N^o 6 NORTH, RANGE N^o 39 EAST OF THE WILLAMETTE MERIDIAN, WASHINGTON.

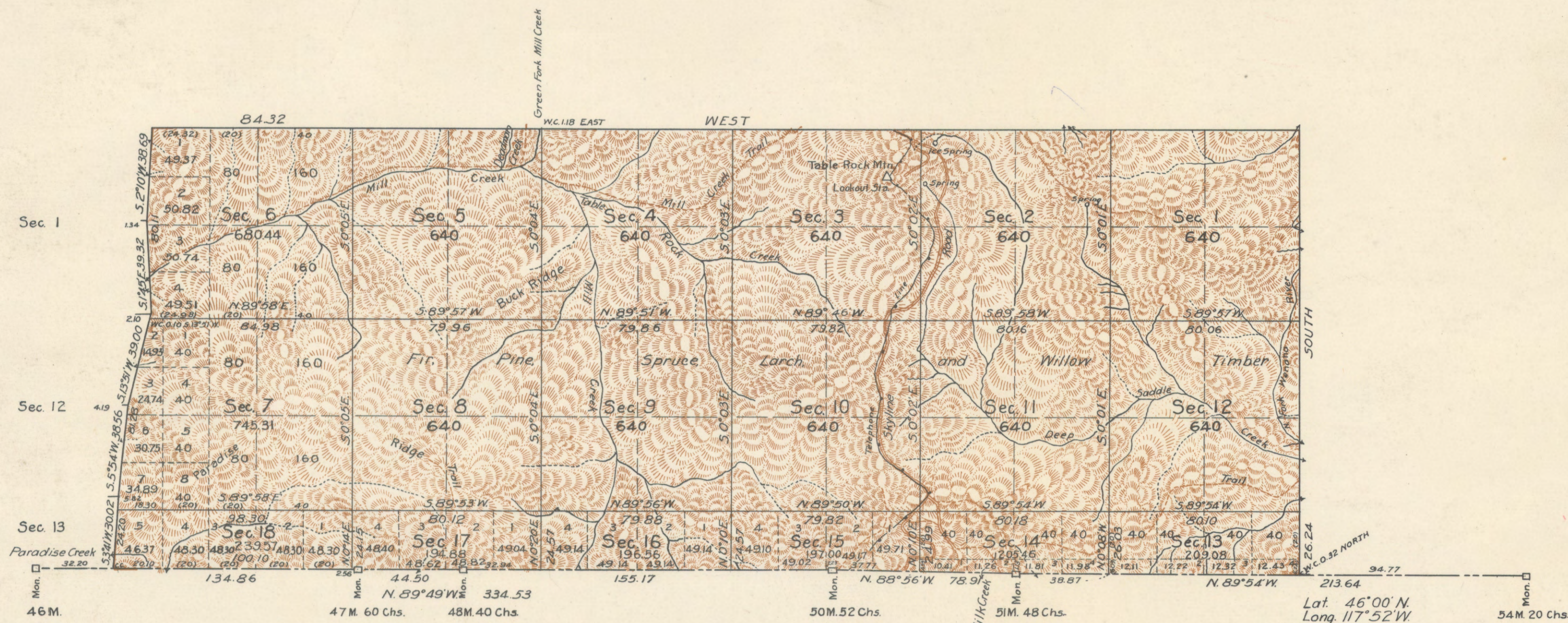

OREGON

Mean Magnetic Declination 22° 30' E. Scale: 40 Chains to an Inch. Area Surveyed 9068.30 Acres.

LINES DESIGNATED	BY WHOM SURVEYED	GROUP		MILEAGE		WHEN SURVEYED	
		No.	DATE	MLS.	CHS.	BEGUN	COMPLETED
State Boundary	Roy T. Campbell	130	April 17, 1929	7	67.08	July 26, 1931	Aug. 10, 1931
Exterior	" " "	"	" " "	4	51.83	" 6, "	" 11, "
Subdivisional	" " "	"	" " "	23	67.55	" " "	" " "

Office of U.S. Supervisor of Surveys.
 Denver, Colorado, Aug. 2, 1932
 The above plat of Township No. 6 North, Range No. 39 East of the Willamette Meridian, Washington, is strictly conformable to the field notes of the survey thereof which have been examined and approved.

Diana H. Cannon
 U.S. Supervisor of Surveys.

DEPARTMENT OF THE INTERIOR
 GENERAL LAND OFFICE
 Washington, D.C., January 12, 1933.

The survey represented by this plat having been correctly executed in accordance with the requirements of law and the regulations of this office, is hereby accepted.

Thos C Howell
 Assistant Commissioner

RWB
70