

Township No. 3 North Range No. 34 East Will. Mer.

4249

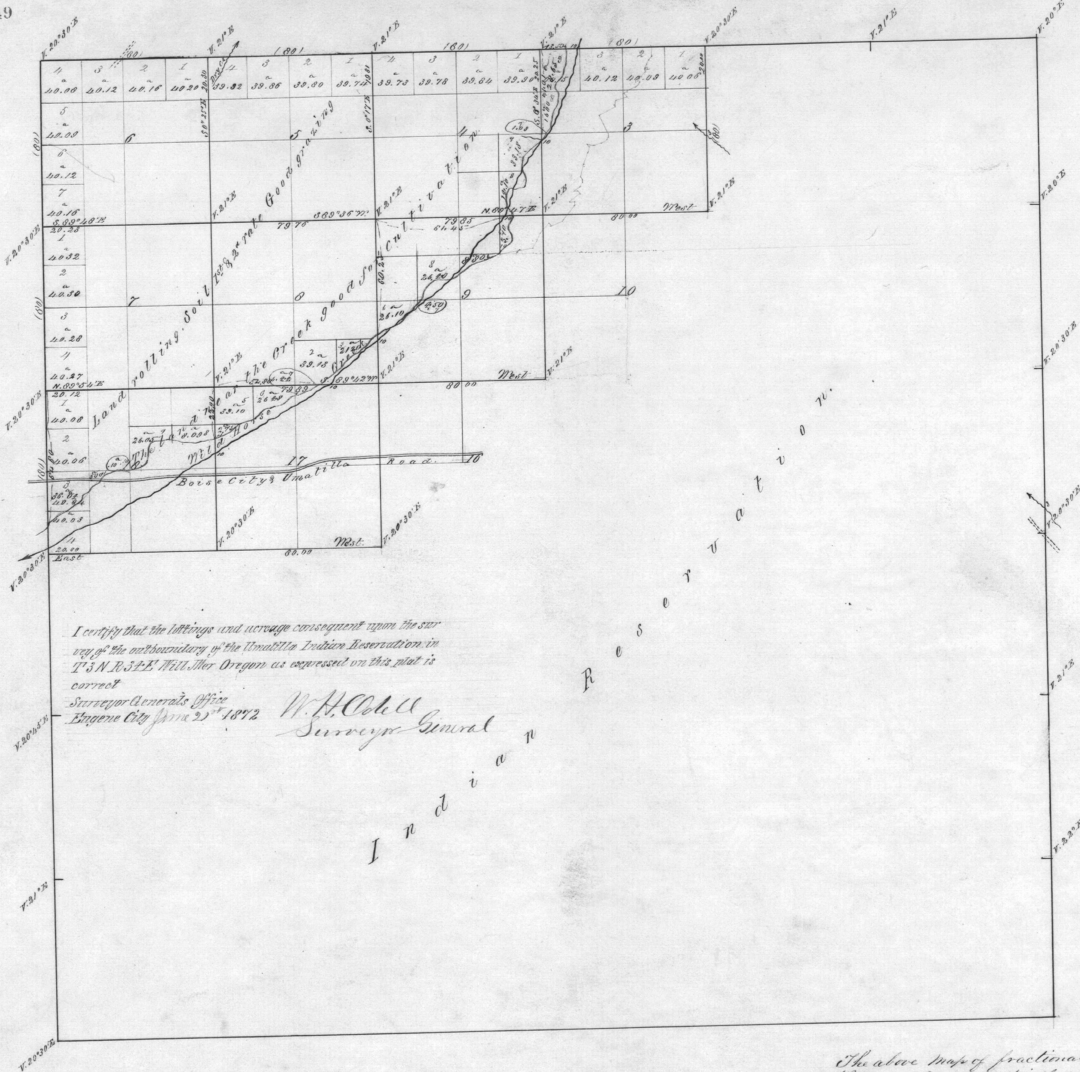

Total Area 3675.70

I certify that the bearings and acreage consequent upon the survey of the outboundary of the Umatilla Indian Reservation in T3N R34E Will. Mer Oregon as shown on this plat is correct

Surveyor General's Office
 Eugene City June 25th 1892
 W. H. Odell
 Surveyor General

I n d i a n

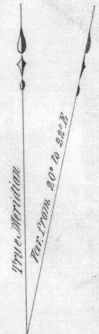

Scale 40 Chs to an Inch

The above map of fractional Township No. 3 North, Range No. 34 East Will. Mer. Oregon is strictly conformable to the original field notes of the survey thereof, on file in this office, which have been examined & approved
 Surveyor General's Office
 Eugene City Feb. 14th 1897
 E. L. Applegate
 Surveyor Genl. of Oregon.

Lines	Contractor	Contract		Amt. Acres	Completed
		No.	Date		
Subdivisions	W. H. Odell	24	July 25 th 1892	18.00 21	Aug. 31 1892
	Total Acres 6061.30				