

Sections	Area
1	640.00
2	640.00
3	640.00
4	640.00
5	640.00
6	640.00
7	640.00
8	640.00
9	640.00
10	640.00
11	640.00
12	640.00
13	640.00
14	640.00
15	640.00
16	640.00
17	640.00
18	640.00
19	640.00
20	640.00
21	640.00
22	640.00
23	640.00
24	640.00
25	640.00
26	640.00
27	640.00
28	640.00
29	640.00
30	640.00
31	640.00
32	640.00
33	640.00
34	640.00
35	640.00
36	640.00
37	640.00
38	640.00
39	640.00
40	640.00
41	640.00
42	640.00
43	640.00
44	640.00
45	640.00
46	640.00
47	640.00
48	640.00
49	640.00
50	640.00
51	640.00
52	640.00
53	640.00
54	640.00
55	640.00
56	640.00
57	640.00
58	640.00
59	640.00
60	640.00
61	640.00
62	640.00
63	640.00
64	640.00
65	640.00
66	640.00
67	640.00
68	640.00
69	640.00
70	640.00
71	640.00
72	640.00
73	640.00
74	640.00
75	640.00
76	640.00
77	640.00
78	640.00
79	640.00
80	640.00
81	640.00
82	640.00
83	640.00
84	640.00
85	640.00
86	640.00
87	640.00
88	640.00
89	640.00
90	640.00
91	640.00
92	640.00
93	640.00
94	640.00
95	640.00
96	640.00
97	640.00
98	640.00
99	640.00
100	640.00
Total	64000.00

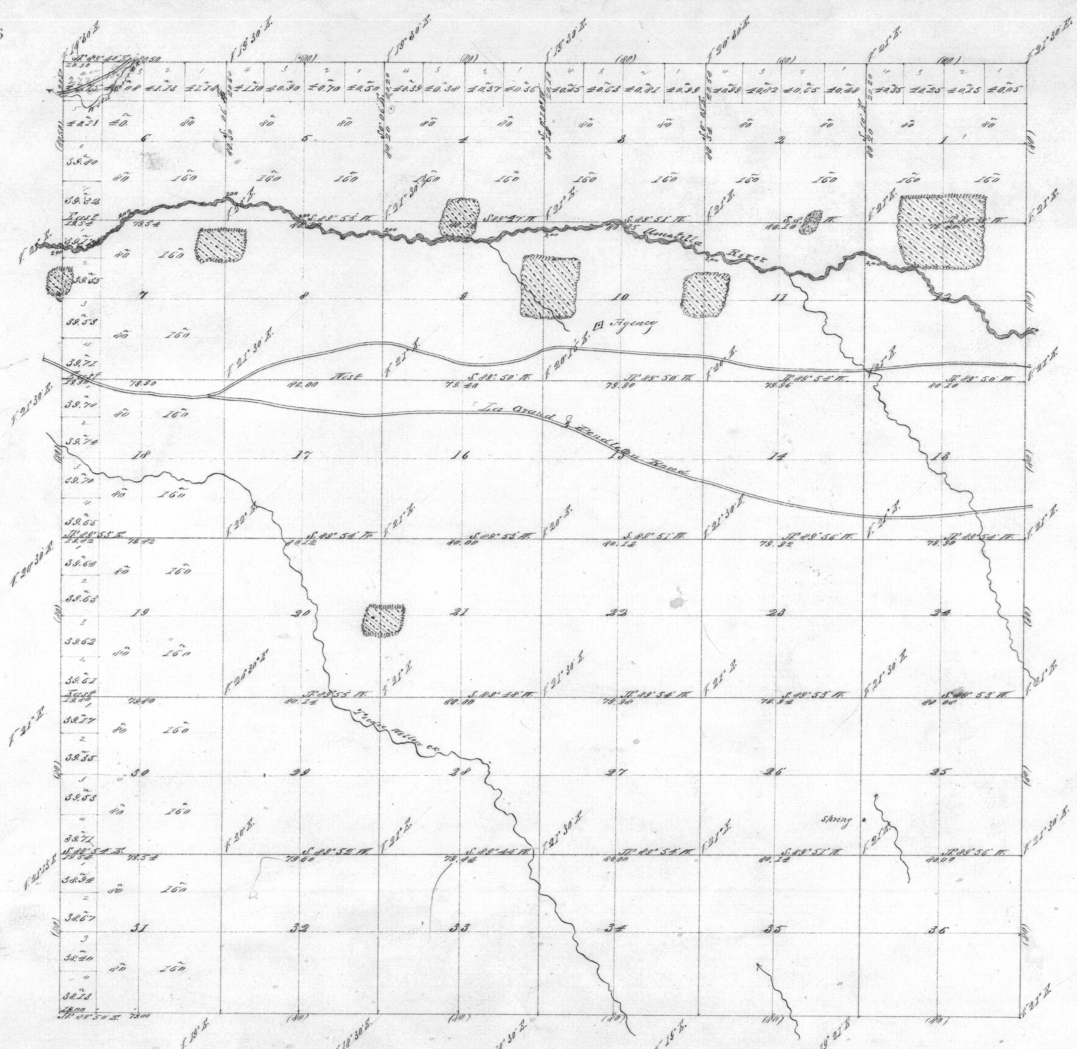

General Description
 This land in this Township
 is level and of 1st rate quality



Lines	Contractors	Stk	Contract Date	Time Surveyed	Area Ch. Sq.	Commenced	Completed
Subdivisions	J. F. Mody	125	April 23 rd 1871	75	43	May 23 rd 1871	May 20 th 1871

This also Map of the Subdivision lines of the 2nd R. 8th S. 8th T. Will. Alex. Colson is strictly conformable to the original field notes of the Survey made on file in this Office which have been examined and approved.
 W. H. Cole
 Secy. Genl. Survey Office
 Oregon City Nov 11th 1871