

USDA-FOREST SERVICE

Index
File No. 8-21

T 7 S R. 34 E

Merid. Willamette

CORNER RECORD (SEARCH)

(Ref. FSM 7151.4)

R.D. NORTH FORK JOHN DAY County Grant

N.F. Umatilla State OREGON

Tract or
Survey No. _____ Cor.
No. _____

CORNER DIAGRAM

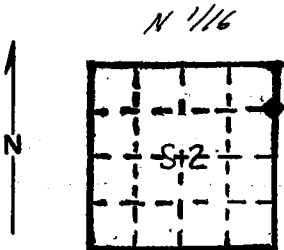

DESCRIBE CORNER MONUMENT FOUND

None.

DESCRIBE BEARING TREES OR OTHER OFFICIAL ACCESSORIES FOUND

None

PHOTO IDENTIFICATION DATA

Photo No. _____

Filed At. _____

Object Ident. _____

Ident. By _____

Signature

PLANE COORDINATE POSITION DATA

State _____ Zone _____

X _____

Y _____

Estob. By _____

Agency

DESCRIBE CORNER LOCATION RELATIVE TO NEAR-BY FEATURES, ALSO HOW TO REACH CORNER

Take Road 510 off road 52 to 4"x4" post on E-W 40-Line through middle NE 1/4 S.2, go East 755' to Cor.

Signature
Chapman J. McArthur

Title
Land Surveyor

Division _____

Headquarters _____

Date
10/25/86

FS-7100-52 (3/68)

CORNER RECORD (PERPETUATION)

MONUMENT: DESCRIBE NEW MONUMENT SET, OR WORK DONE TO PRESERVE EXISTING MONUMENT

Set $2\frac{1}{2}$ " Diam. Alum. Cap on a $2\frac{1}{2}$ " X 30" Alum. Pipe w/ Flare at bottom at point for corner. Cap mKd. per sketch. set steel posts $4\frac{1}{2}$ w. E & S. w/ Prop. Bndry., Athn & Mon. signs attached.

N 1/16
S2 | S1
RPLS 1910
1986

ACCESSORIES: DESCRIBE NEW BT's WITNESS OBJECTS ETC. ESTABLISHED, OR WORK DONE TO PRESERVE EXISTING EVIDENCE

① 9" DBH Lodgepole Pine, N. 65° E, 35.4', scribed N 1/16 S1 BT.

② 10" DBH Lodgepole Pine, S. 4° W, 79.9' scribed N 1/16 S2 BT.

Each BT. has a brass washer mKd. RPLS 1910 set btwn. B & T, A B.T. tag. Athn. sign. Band and face painted red.

Work Done By C.J. Martin Title Land Surveyor Date 10/25/86 State Registration No. or Agency LS 1910

Certified Cor. Record Prepared? Yes No Filed At: _____ Date _____

REMARKS

Index File No.

8-21

T.

75

R.

84 E

M. WILLAMETTE Tract or Surv. No.

GPO: 1982 O-382-659

Cor. N 1/16

S2 | S1