

Index
File No. B-8

CORNER RECORD (SEARCH)
(Ref. FSM 7151.4)

Tract or
Survey No. _____ Cor.
No. B-8

T 7 S R. 32 E R.D. Dale 01 County Grant

Merid. W.M. N.F. Umatilla 14 State Oregon

CORNER DIAGRAM

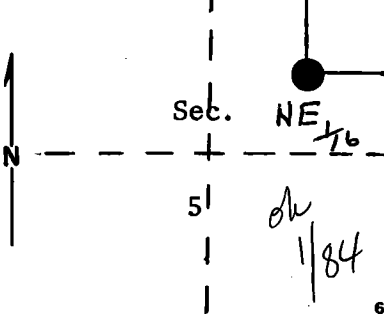

DESCRIBE CORNER MONUMENT FOUND

MATERIAL: --Brass-Cap----- SIZE _____

HEIGHT ABOVE GROUND: 10" CONDITION: good

MARKINGS: w/mound of rock - beside (E) of 16" log 2

DESCRIBE BEARING TREES OR OTHER OFFICIAL ACCESSORIES FOUND

NE 1/16 S.5
Est. 1968 - BLM
Brass cap not visible from jeep trail.

PHOTO IDENTIFICATION DATA

Photo No. _____
Filed At. _____
Object Ident. _____
Ident. By _____
Signature 7

DESCRIBE CORNER LOCATION RELATIVE TO NEAR-BY FEATURES, ALSO HOW TO REACH CORNER 3

PLANE COORDINATE POSITION DATA

State _____ Zone _____
X _____
Y _____
Estab. By _____
Agency 8

Signature E. SWAN Title For. Tech. Division _____ Headquarters Dale Date 8-30-73 4
7100-52-(3/68) 5

CORNER RECORD (PERPETUATION)

MONUMENT: DESCRIBE NEW MONUMENT SET, OR WORK DONE TO PRESERVE EXISTING MONUMENT

ACCESSORIES : DESCRIBE NEW BT'S WITNESS OBJECTS ETC. ESTABLISHED, OR WORK DONE TO PRESERVE EXISTING EVIDENCE

Witness Tree - easily visible
 D.F. 10" d.b.h. 8 ft N jeep trail. T.7S., R.32E.
 1 ch W 1/16 Cor. HBS-Rs-ZP
 G.Pacific corner tag.

Witness Tree - easily visible
 G.P. tag. D.F. 9" d.b.h. 60' N jeep trail, est. T.&S.,R.32E.
 14 lks N 66E to cor.1/16 HBS-RS
 Blazed S&E-W sides, 2 levels
 3½' to 6½' off ground.

Witness Tree -
 11" d.b.h.
 Blazed & scribed on SE side near ground level not readable
 10 ft. NW - Brass cap

Witness Tree - 30 ft. NE, jeep trail F.S. Bearing tree tag 54-3, pitched over Tree blazed & scribed N side not readable, 11" d.b.h. -D.F., All witness trees N of jeep trail.

Work Done By _____ Title _____ Date _____ State Registration No. or Agency _____

Certified Cor. Record Prepared ? Yes No Filed At: _____ Date _____

REMARKS

Index File No. **B-8** T. **7S.** R. **32E.** M. **WM.** Tract or Surv. No. _____ Cor. **B-8**

9
10
11
12
13