

USDA-FOREST SERVICE

Index

File No. B-25

CORNER RECORD (SEARCH)

(Ref. FSM 7151.4)

Tract or

Survey No. SEC 1

Cor.

No. E-N 1/16

T T7S

R. R32E

R.D. DALE

County GRANT

Merid. WILLAMETTE

N.F. UMATILLA

State OREGON

CORNER DIAGRAM

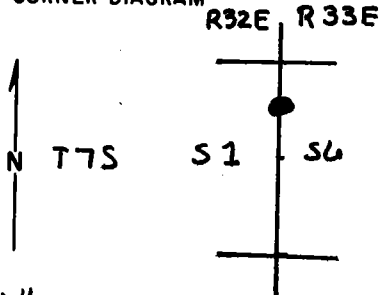

DESCRIBE CORNER MONUMENT FOUND

SET BY SURVEY

DESCRIBE BEARING TREES OR OTHER OFFICIAL ACCESSORIES FOUND

N/A

DESCRIBE CORNER LOCATION RELATIVE TO NEAR-BY FEATURES, ALSO HOW TO REACH CORNER

N 1/16 CORNER

PHOTO IDENTIFICATION DATA

Photo No. _____

Filed At. _____

Object Ident. _____

Ident. By _____

Signature

PLANE COORDINATE POSITION DATA

State _____ Zone _____

X _____

Y _____

Estab. By _____

Agency

Signature

D.H. KRUMBHIN

Title

SURVEYOR

Division

PLS 933

Headquarters

Date

1978

7100-52-(3,68)

CORNER RECORD (PERPETUATION)

MONUMENT: DESCRIBE NEW MONUMENT SET, OR WORK DONE TO PRESERVE EXISTING MONUMENT
 SET 2 1/2 X 30" IRON PIPE 6" IN GROUND. RAISED ROCK MOUND TO BRASS
 CAP. BRASS CAP MARKED AS SHOWN

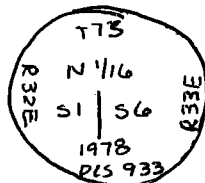

FROM WHICH I SCRIBED BT'S

ACCESSORIES: DESCRIBE NEW BT'S WITNESS OBJECTS ETC. ESTABLISHED, OR WORK DONE TO PRESERVE EXISTING EVIDENCE

PINE 16" DIAM. BRS. N37°W 11.25 FT. MARKED N 1/16 S1 T73 R32E BT.
 PINE 14" DIAM. BRS. S86°E 31.70 FT. MARKED N 1/16 S6 T73 R32E BT.

NAILED A BRASS WASHER MARKED PLS 933 TO THE BT BLAZE OF TREES.
 SET A STEEL POST 3 FT. SOUTH OF CORNER.

Work Done By D.H. KRUMBEIN Title SURVEYOR Date 1978 State Registration No. PLS 933
 or Agency

Certified Cor. Record Prepared? Yes No Filed At: _____ Date _____

REMARKS

INFO. TAKEN FROM "LAND CORNER MONUMENTATION" FILE

Index File No. B-25

CORNER RECORD (SEARCH)

(Ref. FSM 7151.4)

Tract or Survey No. _____

Cor. No. B-25

T 75 R. 32E

R.D. _____

County _____

Merid. _____

N.F. _____

State _____

CORNER DIAGRAM

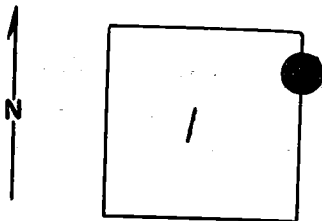

DESCRIBE CORNER MONUMENT FOUND

~~CR 775, 0225~~

Monumented by BLM

DESCRIBE BEARING TREES OR OTHER OFFICIAL ACCESSORIES FOUND

PHOTO IDENTIFICATION DATA

Photo No. _____

Filed At. _____

Object Ident. _____

Ident. By _____

Signature

PLANE COORDINATE POSITION DATA

State _____ Zone _____

X _____

Y _____

Estab. By _____

Agency

Signature _____

Title _____

Division _____

Headquarters _____

Date _____

CORNER RECORD (PERPETUATION)

MONUMENT: DESCRIBE NEW MONUMENT SET, OR WORK DONE TO PRESERVE EXISTING MONUMENT

ACCESSORIES : DESCRIBE NEW BT'S WITNESS OBJECTS ETC. ESTABLISHED, OR WORK DONE TO PRESERVE EXISTING EVIDENCE

Work Done By _____ Title _____ Date _____ State Registration No. _____
or Agency _____

Certified Cor. Record Prepared ? Yes No Filed At: _____ Date _____

REMARKS

Index File No. T. R. M. Tract or Surv. No. Cor. _____

USDA-FOREST SERVICE

Index
File No. B-1

CORNER RECORD (SEARCH)

(Ref. FSM 7151.4)

Tract or
Survey No. _____

Cor.
No. _____

T 7S R. 33E

R.D. NORTH FORK JOHN DAY County GRANT

Merid. WILLAMETTE

N.F. UMATILLA State OREGON

CORNER DIAGRAM

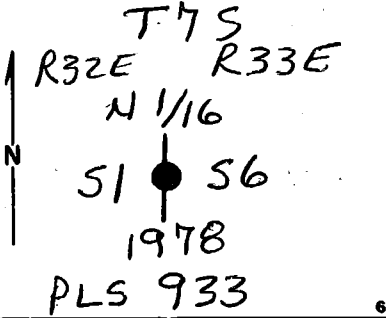

DESCRIBE CORNER MONUMENT FOUND

BRASS CAPPED IRON PIPE - BRASS CAP IS MARKED AS IN DIAGRAM.

DESCRIBE BEARING TREES OR OTHER OFFICIAL ACCESSORIES FOUND

17" POND. PINE IS SICK - BEARS N38°E, 113 FEET.
11" POND. PINE IS DOWN - SCRIBES VISIBLE ON ^{BURNT} LOG - ROOT HOLE BEARS S86°E, 317 FEET.
17" POND. PINE ~~IS~~ W/VISIBLE SCRIBES (CHARRED) BEARS S19°15'E, 52° FEET.

PHOTO IDENTIFICATION DATA

Photo No. _____
Filed Af. _____
Object Ident. _____
Ident. By _____
Signature

DESCRIBE CORNER LOCATION RELATIVE TO NEAR-BY FEATURES, ALSO HOW TO REACH CORNER

PLANE COORDINATE POSITION DATA

State _____ Zone _____
X _____
Y _____
Estab. By _____
Agency

Signature

Title

Division

Headquarters

Date

FS-7100-52 (3/68)

Dennis F. Gaylord PLS 1636

March 11, 1997

CORNER RECORD (PERPETUATION)

MONUMENT: DESCRIBE NEW MONUMENT SET, OR WORK DONE TO PRESERVE EXISTING MONUMENT

None

ACCESSORIES: DESCRIBE NEW BT'S WITNESS OBJECTS ETC. ESTABLISHED, OR WORK DONE TO PRESERVE EXISTING EVIDENCE

18" PONDEROSA PINE SCRIBED " N 1/16 S 1 BT " ON DOUBLE
BLAZES BEARS S 77° 45' W, 44 = FEET.

Work Done By D. GAYLORD Title FOREST L. S. Date 3/11/97 State Registration No. 1636
or Agency
Certified Cor. Record Prepared Yes No Filed At: GRANT COUNTY SURVEYOR Date MARCH 1997

REMARKS

Index File No. T. R. M. Tract or Surv. No. Cor.
B-1 T75 R33E WILL 13

Index File No. B-1
T 7S R. 33E
Merid. W.M.

CORNER RECORD (SEARCH)

(Ref. FSM 7151.4)

Tract or Survey No. _____ Cor. No. _____

R.D. N. Fk. J. D. County Grant
N.F. Umatilla State Or.

CORNER DIAGRAM



T7S
N1/16
S1/86
R32E R33E

DESCRIBE CORNER MONUMENT FOUND

2 1/2" iron pipe, brass cap mkd.:

T7S
N1/16
S1/86
1978
PLS 933

DESCRIBE BEARING TREES OR OTHER OFFICIAL ACCESSORIES FOUND

P. Pine, 17", N37W, 11.25'; scribing visible.
P. Pine, 11", dead, S86E, 31.7'; scribing visible.

PHOTO IDENTIFICATION DATA

Photo No. _____
Filed At. _____
Object Ident. _____
Ident. By _____
Signature

DESCRIBE CORNER LOCATION RELATIVE TO NEAR-BY FEATURES, ALSO HOW TO REACH CORNER

Cor. falls on SWly slope, W of rd. Posted line N & E.

PLANE COORDINATE POSITION DATA

State _____ Zone _____
X _____
Y _____
Estab. By _____
Agency

Signature
F. J. Manno

Title PLS Division _____ Headquarters _____

Date 10/26/89

CORNER RECORD (PERPETUATION)

MONUMENT: DESCRIBE NEW MONUMENT SET, OR WORK DONE TO PRESERVE EXISTING MONUMENT

ACCESSORIES : DESCRIBE NEW BT'S WITNESS OBJECTS ETC. ESTABLISHED, OR WORK DONE TO PRESERVE EXISTING EVIDENCE

New BT: P. Pine, 17", S18½E, 52.0'; mhd: NL/16 S6 BT
 BTs have red blaze, band, BT tags and 54-9 signs. New BT has alum.
 "PLS 1832" washer. 6' fence post with 54-9 sign within 5' of cor..

Work Done By F.S. Munro Title PLS Date 8/12/89 State Registration No. 1832
 or Agency

Certified Cor. Record Prepared ? Yes No Filed At: Grant Co. Surveyor Date

REMARKS

Index File No. B-1 T. 78 R. 33E M. W.M. Tract or Surv. No.

Cor.

USDA-FOREST SERVICE

Index
File No. B-1

CORNER RECORD (SEARCH)

(Ref. FSM 7151.4)

Tract or
Survey No. _____ No. B-1

T 7S R. 01W 33E R.D. Ukiah County Grant

Merid. Willamette N.F. Umatilla State Oregon

CORNER DIAGRAM

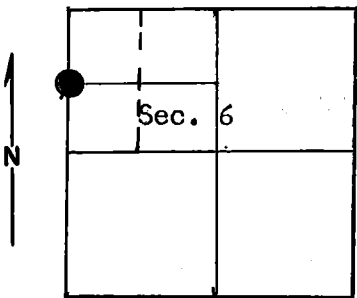

DESCRIBE CORNER MONUMENT FOUND

None

DESCRIBE BEARING TREES OR OTHER OFFICIAL ACCESSORIES FOUND

None

PHOTO IDENTIFICATION DATA

Photo No. _____

Filed At. _____

Object Ident. _____

Ident. By _____

Signature

PLANE COORDINATE POSITION DATA

State _____ Zone _____

X _____

Y _____

Estab. By _____

Agency

DESCRIBE CORNER LOCATION RELATIVE TO NEAR-BY FEATURES, ALSO HOW TO REACH CORNER

From Texas Bar Road S 678, go for about $\frac{1}{2}$ miles.
Look for tag on tree. (Jeep trail downhill towards North
fork River) Corner is about S 30° E 700 ft. from road S678.
(Ditch runs toward river for mine use along side road)

Signature

Title

Division

Headquarters

Date

7100-52-(3/68)

Party Chief

Krumbein Engineering

14 SEP 78

CORNER RECORD (PERPETUATION)

MONUMENT: DESCRIBE NEW MONUMENT SET, OR WORK DONE TO PRESERVE EXISTING MONUMENT

Set 2½" x 30" iron pipe with brass cap (stamped)

Pipe is 6" in ground, raised rock mound about 3 ft. diam.

R 32E

T 7S
N 1/16
S 1 S 6
1978
PLS 933

R 33E

ACCESSORIES: DESCRIBE NEW BT'S WITNESS OBJECTS ETC. ESTABLISHED, OR WORK DONE TO PRESERVE EXISTING EVIDENCE

Pine 16" diam. brs. N 37° W 11.25 ft. with signs 54-3, 54-4, and brass washer.
 Pine 14" diam. brs. S 86° E 31.70 ft. with signs 54-3, 54-4, and brass washer.

Set steel post 3 ft. South with sign 54-4.

Painted scribed area and red band around bearing tree.

Work Done By P. Murphy Title Party Chief Date 8/31/78 State Registration No. or Agency _____Certified Cor. Record Prepared? Yes No _____ Filed At: County Surveyor Date _____

REMARKS

Witness by: R. Barton
M. Murtishaw

Index File No. B-1 T-7S R. 33E M. Willamette Tract or Surv. No. _____

Cor. _____

Index
File No. B-1

CORNER RECORD (SEARCH)

(Ref. FSM 7151.4)

Tract or
Survey No. _____

Cor.
No.

T 7 S R. 33 E

R.D. Dale County Grant

Merid. Willamette

N.F. Umatilla State Oregon

CORNER DIAGRAM

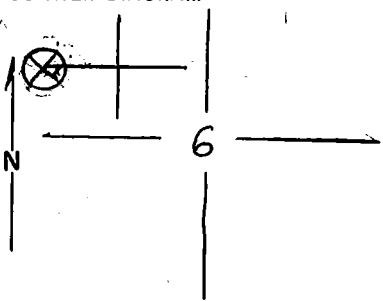

DESCRIBE CORNER MONUMENT FOUND

Rock Mound - approx. 2 feet high. ^{2 1/2 ft. across} approx. 30 feet from road. good condition. Markings - None (on rock point above road - some blue paint on rocks, easily seen from road.

DESCRIBE BEARING TREES OR OTHER OFFICIAL ACCESSORIES FOUND

BT. - D.Fir - 27" DBH - blazed on SE side - Metal tags 54-4 & 54-3 - reading BT, corner approx. S 30 E - Distance pitched over Uphill approx. 30 feet from N.Fork John Day ~~Bed~~ Road. easily seen.

PHOTO IDENTIFICATION DATA

Photo No. EXR-79-4-271
Filed At. 2210 Central Desol. C&H
Object Ident. Photo Punched with
Ident. By B-10-71 I.D.

Range office

DESCRIBE CORNER LOCATION RELATIVE TO NEAR-BY FEATURES, ALSO HOW TO REACH CORNER

Bearing Stump - rotten - Up hill approx. 60 feet from N.F. John Day Road - easily seen - Ponderosa Pine - approx. 36" DBH with 7 foot high stump.
Metal tag - reading - T7S, R33E, - X S 19 W -38'

PLANE COORDINATE POSITION DATA

State _____ Zone _____
X _____
Y _____
Estab. By _____
Agency

Signature

Title

Division

Headquarters

Date

7100-52 (3/68)

Emery Swain

Range Corner

Range

Dale

9-8-72

CORNER RECORD (PERPETUATION)

MONUMENT: DESCRIBE NEW MONUMENT SET, OR WORK DONE TO PRESERVE EXISTING MONUMENT

Bearing Stump - D.Fir - 22" DBH - 12" high - metal tag 54-4 - stump ten feet above road, easily seen tag nailed to face of stump.

Bearing Tree - D.Fir - 6" DBH - approx. 25 feet up hill above road - not to easily seen with metal tag 54-3 (138 links - N 30 W) blaze on NW side.

9

ACCESSORIES : DESCRIBE NEW BT'S WITNESS OBJECTS ETC. ESTABLISHED, OR WORK DONE TO PRESERVE EXISTING EVIDENCE

10

Work Done By _____ Title _____ Date _____ State Registration No. or Agency _____

Certified Cor. Record Prepared ? Yes No Filed At: _____ Date _____

11

REMARKS

12

13