

CERTIFIED RECORD OF LAND CORNER MONUMENTATION

History of original corner establishment:
 Quarter cor., R32E; Sec 32 of T6S & Sec 5 of T7S, WM.
 Corner originally set by Rufus Moore under
 Contract No. 382 dated 1881.
 A retracement survey was made by the BLM under
 assignment instructions dated 1967.
 They found the following evidence of the original
 corner: A larch snag, 26 ins. diam., bears N60°E, 25
 lks. dist., with visible scribe. A pine, 36 ins. diam.
 bears S43°E, 21 lks. dist., with healed blaze.
 They set a standard BLM monument, marked as shown
 at the corner point and set two new witness trees.
 A fir, 16 ins. diam., bears N. 34 1/2° E., 37 lks.
 dist., mkd. 1/4 S32 BT.
 A fir, 11 ins. diam., bears S. 74° W., 57 lks. dist., mkd. 1/4 S5 BT.

Index: Z-7

1	DIAGRAM	1
1	BLM brass cap	1
1		1
1	T6S R32E	1
1	S32	1
1	1/4----	1
1	S5	1
1	T7S	1
1	1968	1
1		1

Description of corner evidence found:

Found the corner monument as described from which:
 A 17" dbh Douglas Fir bears N33°E, 24.4' with visible scribe. A dead
 and down 26" dbh Western Larch bears N60°E, 16.5' with visible scribe.
 A 36" dbh Ponderosa Pine bears S44 1/4°E, 13.9' with healed blaze.
 A 13" dbh Douglas Fir bears S76 1/4°W, 37.6' with healed blaze.

Description of monument and accessories I established to perpetuate the
 original location of this corner:

Cleared brush and debris from corner and set new bearing trees as
 follows:
 A 10" dbh Douglas Fir bears N9 3/4°W, 28.0' scribed 1/4 S32 BT.
 The bearings are true based on the GPS bearings to the surveyed steel
 post which bears N00°03'E, 34.8'.
 An aluminum washer stamped RLS 852 is nailed between the letters B and T,
 on the new tree. All the BT's have LSM and BT signs attached.
 Painted 6" red bands around all the trees and painted the
 scribe blazes red.

This work was done May 27, 1994.

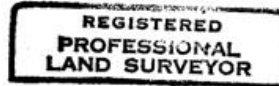

David L. Haddock



Office of _____ County of _____
 State of _____, I hereby certify that the within instrument was filed
 in this office for record on the _____ day of _____, 19____.

_____ by _____
 (COUNTY OFFICIAL) (DEPUTY)

RECEIVED BY
 Umatilla County Surveyor
 Date 7-94
 Rec'd By AK
 No. 94-99-R