

CORNER RECORD (SEARCH)

(Ref. FSM 5151.4)

Tract or
Survey No.

Cor.
No.

R.D. North Fork John Day

County Grant & Umatilla

N.F. Umatilla

State Oregon

CORNER DIAGRAM

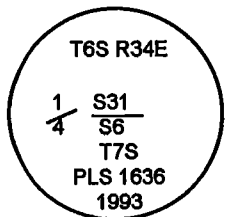

DESCRIBE CORNER MONUMENT FOUND

Found a 2 1/2" aluminum pipe, with a 3 1/4" aluminum cap, projecting 2" out of the ground.

DESCRIBE BEARING TREES OR OTHER OFFICIAL ACCESSORIES FOUND

- 28" dead Douglas Fir, N. 40 E., 28.4 feet, with healed double blaze.
- 16" dead White Fir, S. 53 1/2 E., 57.1 feet, with burnt out double blaze.
- 29" dead Douglas Fir, S. 56 1/2 W., 48.5 feet, with burnt out double blaze.
- 16" dead White Fir, N. 16 1/2 W., 27.5 feet, with burnt out double blaze.

PHOTO IDENTIFICATION DATA

Photo No.

Filed At.

Object Ident.

Ident. By

Signature

DESCRIBE CORNER LOCATION RELATIVE TO NEAR-BY FEATURES, ALSO HOW TO REACH CORNER

PLANE COORDINATE POSITION DATA

State:

Zone:

X:

Y:

Datum:

Signature
D. Schlaich

Title
Land Surveyor

Division

Headquarters
S.O.

Date
09/1997

CORNER RECORD (PERPETUATION)

MONUMENT: DESCRIBE NEW MONUMENT SET, OR WORK DONE TO PRESERVE EXISTING MONUMENT

ACCESSORIES: DESCRIBE NEW BT'S WITNESS OBJECTS ETC. ESTABLISHED, OR WORK DONE TO PRESERVE EXISTING EVIDENCE

- RM, 5/8" X 24" rebar with yellow plastic cap stamped "UMATILLA N.F.", set 23" in the ground, N. 43 E., 20.03 feet.
- RM, 5/8" X 24" rebar with red plastic cap stamped "UMATILLA N.F.", set 23" in the ground, S. 45 E., 15.43 feet.
- RM, 5/8" X 24" rebar with red plastic cap stamped "UMATILLA N.F.", set 23" in the ground, S. 42 1/2 W., 28.90 feet.
- RM, 5/8" X 24" rebar with yellow plastic cap stamped "UMATILLA N.F.", set 23" in the ground, N. 47 1/2 W., 11.96 feet.

Work Done By D. Schlaich Title Land Surveyor Date 09/1997 State Registration No. or Agency _____
Certified Corner Record Prepared? Yes No Filed At: Umatilla County Surveyor's Office Date 11/1997

REMARKS

Index
File No. Z-3

CORNER RECORD (SEARCH)

(Ref. FSM 7151.4)

Tract or Survey No. _____
Cor. No. _____

T 6S R. 34E R.D. N.F.J.D. County GRANT/UMATILLA CO. LINE

Merid. WILLAMETTE N.F. UMATILLA State OREGON

CORNER DIAGRAM

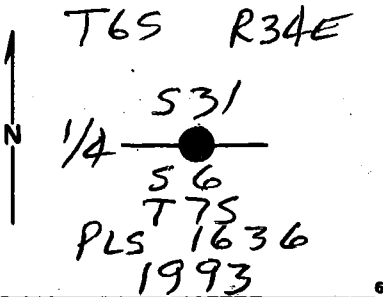

DESCRIBE CORNER MONUMENT FOUND

NONE

DESCRIBE BEARING TREES OR OTHER OFFICIAL ACCESSORIES FOUND

28" DOUG-FIR N40°E, 28.38 ft.

PHOTO IDENTIFICATION DATA

Photo No. _____
Filed At. _____
Object Ident. _____
Ident. By _____
Signature _____

PLANE COORDINATE POSITION DATA

State _____ Zone _____
X _____
Y _____
Estab. By _____ Agency _____

DESCRIBE CORNER LOCATION RELATIVE TO NEAR-BY FEATURES, ALSO HOW TO REACH CORNER

Signature

Title

Division

Headquarters

Date

FS-7100-52 (3/68)

Dennis L. Gaylord PLS 1636 S.O. 9-2-93

CORNER RECORD (PERPETUATION)

MONUMENT: DESCRIBE NEW MONUMENT SET, OR WORK DONE TO PRESERVE EXISTING MONUMENT

SET 2 1/2" x 30" ALUM PIPE w/ 3/4" ALUM CAP
MKD AS SHOWN IN DIAGRAM.

ACCESSORIES : DESCRIBE NEW BY'S WITNESS OBJECTS ETC. ESTABLISHED, OR WORK DONE TO PRESERVE EXISTING EVIDENCE

16" W. FIR N18°W, 27.5 ft
16" W. FIR S55°E, 57.1 ft,
29" DOUG-FIR S56°30'W, 48.5 ft.
ROCK OUTCROP, 10' x 6' x 4 1/2' BRS S15°W, 26.7 ft

Work Done By: D. GAYLORD Title: LS Date: 9-2-93 State Registration No. 1636
or Agency

Certified Cor. Record Prepared? Yes No Filed At: GRANT & UMATILLA COIS Date: 9-29-93

REMARKS

Index File No. Z-3 T. 6S R. 34E M: WILL Tract or Surv. No. Cor. 13