

USDA-FOREST SERVICE

Index

File No. Z-25

CORNER RECORD (SEARCH)

(Ref. FSM 7151.4)

Tract or

Survey No. _____

Cor.

No. SE

T 6 S. R. 34 E.

R.D. NORTH FORK JOHN DAY County UMATILLA

Merid. WILLAMETTE

N.F. UMATILLA State OREGON

CORNER DIAGRAM

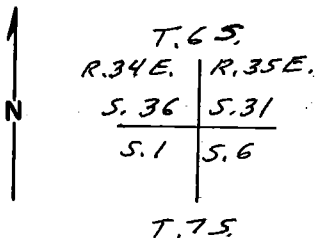

DESCRIBE CORNER MONUMENT FOUND

STONE 18" X 9" X 7" (20" X 20" X 8") W/6 NOTCHES ON EACH EDGE, SET FIRMLY IN PLACE.

DESCRIBE BEARING TREES OR OTHER OFFICIAL ACCESSORIES FOUND ²

- ① (10") LODGEPOLE PINE, N. 36° E., 34 LKS, BT SCRIBES & CHAINING NOTCHED, DEP.
- ② 13" D.B.H. (11") LODGEPOLE PINE, DEAD & DOWN, S. 38° E., 34 LKS., SCRIBED T75R35E56 BT.
- ③ STUMP HOLE, S. 60° W., 23 LKS.
- ④ ROTTEN WOOD IN STUMP HOLE, N. 70° W., 29 LKS.

PHOTO IDENTIFICATION DATA

Photo No. 580-57

Filed At. PENDLETON

Object Ident. PRECISE

Ident. By _____

Signature _____

PLANE COORDINATE POSITION DATA

State _____ Zone _____

X _____

Y _____

Estab. By _____

Agency _____

DESCRIBE CORNER LOCATION RELATIVE TO NEAR-BY FEATURES, ALSO HOW TO REACH CORNER ³

TAKE ROAD 52 TO 850' EAST OF POSTED BNDRY. COR. IS EASILY SEEN FROM ROAD.

Signature

Clayton J. [Signature]

Title

LAND SURVEYOR

Division

Headquarters

Date

10/25/86

FS-7100-52 (9/68)

5

CORNER RECORD (PERPETUATION)

MONUMENT: DESCRIBE NEW MONUMENT SET, OR WORK DONE TO PRESERVE EXISTING MONUMENT

SET A 2 1/2" DIAM. ALUM. CAP ON A 2 1/2" X 30" ALUM. PIPE W/FLARE
 AT BOTTOM AT CORNER AND BURIED CORNERSTONE ALONGSIDE PIPE.
 CAP MKD. PER SKETCH.
 SET STEEL POSTS 4' E W. & N. W/PROP. BNDRY., ATTN. AND
 MON. SIGNS ATTACHED.

T 65	
R34E R35E	
536	531
51	56
T 75	
RPLS 1910	
1986	

ACCESSORIES : DESCRIBE NEW BT'S WITNESS OBJECTS ETC. ESTABLISHED, OR WORK DONE TO PRESERVE EXISTING EVIDENCE

- ① 9" D.B.H. LODGEPOLE PINE, S. 11 1/2' W., 116.3', SCRIBED T 75 R34E S1 BT.
- ② 11" D.B.H. LODGEPOLE PINE, N. 89 1/2' W., 19.0', SCRIBED T 65 R34E S36 BT.
- ③ 7" D.B.H. LODGEPOLE PINE, N. 43° E, 76.8', SCRIBED T 65 R35E S31 BT.
- ④ 21" D.B.H. SPRUCE, S. 20 1/2' E., 99.8', SCRIBED T 75 R35E S6 BT.

Work Done By G. J. MARTIN Title LAND SURVEYOR Date 10/25/86 State Registration No. LS 1910
 or Agency

Certified Cor. Record Prepared? Yes (No) Filed At: _____ Date _____

REMARKS

Index File No. Z-25 T. 65 R. 34 E. M. WILLAMETTE Tract or Surv. No. Cor 36/31
1/16

USDA-FOREST SERVICE

Index
File No. E-25

CORNER RECORD (SEARCH)

(Ref. FSM 7151.4)

Tract or Survey No. _____ Cor. No. _____

T 65 R. 34E

R.D. Utah Dale County Umatilla # GRANT

Merid. Will

N.F. Umatilla State Oregon

CORNER DIAGRAM

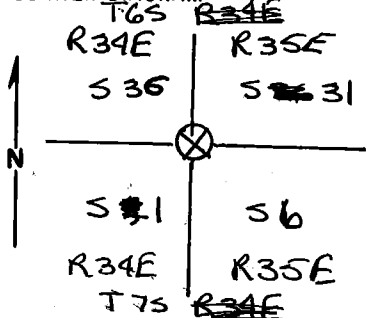

DESCRIBE CORNER MONUMENT FOUND

None found.

DESCRIBE BEARING TREES OR OTHER OFFICIAL ACCESSORIES FOUND

10" Lodgepole pine with scribing "56" on NW face is now down at top of highway embankment and has 2 k-tags on it.

PHOTO IDENTIFICATION DATA

Photo No. _____
Filed At. _____
Object Ident. _____
Ident. By _____
Signature

PLANE COORDINATE POSITION DATA

State _____ Zone _____
X _____
Y _____
Estab. By _____
Agency

DESCRIBE CORNER LOCATION RELATIVE TO NEAR-BY FEATURES, ALSO HOW TO REACH CORNER

Located about 50ft east of enter and leave signs on highway. (Rd. 52)

Signature

Cathy M. McGuire

Title

Volunteer

Division

Headquarters

SO

Date

8/7/87

7100-52-(3,68)

CORNER RECORD (PERPETUATION)

MONUMENT : DESCRIBE NEW MONUMENT SET, OR WORK DONE TO PRESERVE EXISTING MONUMENT

ACCESSORIES : DESCRIBE NEW BT'S WITNESS OBJECTS ETC. ESTABLISHED, OR WORK DONE TO PRESERVE EXISTING EVIDENCE

Work Done By _____ Title _____ Date _____ State Registration No. _____
or Agency _____

Certified Cor. Record Prepared ? Yes No Filed At: _____ Date _____

REMARKS

Index File No. T. R. M. Tract or Surv. No. Cor.

LAND CORNER RECORD

1. T 6S R 34E No. 225 Cor. Sec Mer. Will State Oregon (Rectangular) N. F. Umatilla Dist. Dale 4

2. Corner Status

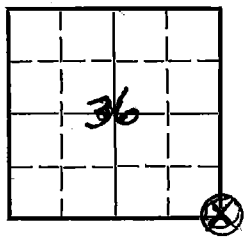

3. Original Description _____ Vol. _____ Page _____ Where Recorded _____

4. Description of Corners:
Corner searched for but could only find BTs
No information available

5. Investigation Notes:

Found BT--Lodge pole 10" DBH with scribing on North West face (S6)

Found BT--Dead log with scribing (T7S R34E S31)

7. Photo Identification
Photo No. EBH 8-7 Line 17
Ident. By: _____

8. Plane Coordinate Position Data
State _____ Zone _____
X _____
Y _____
Estab. By _____
Field Book No. _____
Where Filed _____

9. Evaluation
Authentic _____
Needs Verif. _____ Monument No
Re-estab. X Survey _____
Land Status _____

6. Signed A. Heilmeyer Title Survey Aid Date 12-20-65

PERPETUATION RECORD

10. Monument:

11. Accessories

Field Book _____ Page _____

12. Set By _____ Title _____

13. Recorded By _____ Volume _____ Page _____
(Agency)

License _____ Agency _____ Date _____

(Date) (City) (County) (State)

14. Remarks:

Z-25