

USDA-FOREST SERVICE

Index

File No. Y-25

T6S

R32E

Merid. Willamette

R.D.

N.F.

CORNER RECORD (SEARCH)

Ref. FSM 7151.4

North Fork John Day

Umatilla

Tract or

Survey No

County Umatilla

State Oregon

Cor.

No.

x

1

1

Corner Diagram

1 Describe corner monument found

T 6 S

1 Standard BLM brass cap stamped as shown in the corner diagram.

R32E S 1 / 16 E

1

R32E S36 1 S31 E33

1

R32E 1978 R33

1

PLS 933

1

x

1

x

Photo Identification Data

1 Describe bearing trees or other official accessories found

Photo No.

1 A 28" Ponderosa Pine bears S51 E, 18.5'.

filed at

1 A 32" Western Larch bears N10 1/2 W, 85.8'.

Object Ident.

1

Ident. by

1

Signature

1

x

1

x

Plane Coordinate Position Data

1 Describe corner location relative to near-by features, also how to reach corner

State

Zone

1 From the junction of roads 55 and 5507, follow road 5507 3.3 miles east. The

X

1 corner is located at the top of the cut slope and is plainly visible from the

Y

1 road.

Estab. by

1

Agency

1

x

1

x

Signature

Title

Division

Headquarters

Date

7100.52

David L. Haddock Land Surveyor

Pendleton, OR

July 1988

CORNER RECORD (PERPETUATION)

X _____ X
Monument: Describe new monument set, or work done to preserve existing monument

None

x _____ x
Accessories: Describe new BT's witness objects etc. established, or work done to preserve existing evidence

Painted bands around trees and scribe blazes red.

x _____ x
Work done by David L. Haddock Title Land Surveyor * Date July 1988 State Registration No. 852
Certified cor. record prepared? yes x no Filed at Pendleton, OR Date

x _____ x
REMARKS

x _____ x
Index File No. Y-25 T.6S. R.32E. M. Willamette Tract or Survey No Cor.

USDA-FOREST SERVICE

Index File No. Y-1

CORNER RECORD (SEARCH)

(Ref. FSM 7151.4)

Tract or Survey No. _____ Cor. No. _____

T 65 R. 33E

R.D. NORTH FORK JOHN DAY County UMATILLA

Merid. WILLAMETTE

N.F. UMATILLA State OREGON

CORNER DIAGRAM

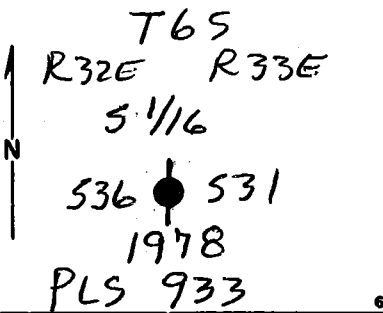

DESCRIBE CORNER MONUMENT FOUND

BRASS CAPPED IRON PIPE - CAP IS MARKED AS IN DIAGRAM.

DESCRIBE BEARING TREES OR OTHER OFFICIAL ACCESSORIES FOUND

THE 2 BT'S OF RECORD ARE OK.

PHOTO IDENTIFICATION DATA

Photo No. _____
Filed At. _____
Object Ident. _____
Ident. By _____
Signature _____

DESCRIBE CORNER LOCATION RELATIVE TO NEAR-BY FEATURES, ALSO HOW TO REACH CORNER

PLANE COORDINATE POSITION DATA

State _____ Zone _____
X _____
Y _____
Estab. By _____
Agency _____

Signature Dennis L. Laylord Title _____ Division PLS 1636 Headquarters _____ Date MARCH 1997 FS-7100-52 (3/68)

CORNER RECORD (PERPETUATION)

MONUMENT: DESCRIBE NEW MONUMENT SET, OR WORK DONE TO PRESERVE EXISTING MONUMENT

ACCESSORIES: DESCRIBE NEW BT'S WITNESS OBJECTS ETC. ESTABLISHED, OR WORK DONE TO PRESERVE EXISTING EVIDENCE

Work Done By _____ Title _____ Date _____ State Registration No. or Agency _____

Certified Cor. Record Prepared? Yes No Filed At: _____ Date _____

REMARKS

Index File No. T. R. M. Tract or Surv. No. Cor.

USDA-FOREST SERVICE

Index
File No. Y-1

CORNER RECORD (SEARCH)

(Ref. FSM 7151.4)

Tract or
Survey No. _____ No. Y-1

T 6S R. 33E R.D. Ukiah County Umatilla
Merid. Willamette N.F. Umatilla State Oregon

CORNER DIAGRAM

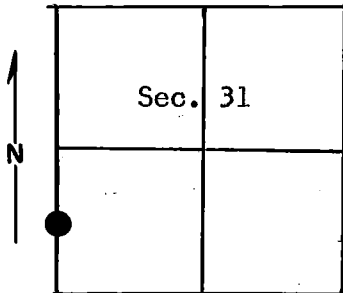

DESCRIBE CORNER MONUMENT FOUND

None

DESCRIBE BEARING TREES OR OTHER OFFICIAL ACCESSORIES FOUND

None

PHOTO IDENTIFICATION DATA

Photo No. _____
Filed At. _____
Object Ident. _____
Ident. By _____

Signature

PLANE COORDINATE POSITION DATA

State _____ Zone _____
X _____
Y _____
Estab. By _____

Agency

Signature

Catrick Loren Murphy
Title Party Chief
Division _____
Headquarters _____
Krumbein Engineering

Date

14 Sep 78

7100-52-(3/68)

6

2

3

4

5

CORNER RECORD (PERPETUATION)

MONUMENT : DESCRIBE NEW MONUMENT SET, OR WORK DONE TO PRESERVE EXISTING MONUMENT

Set 2 1/2" x 30" iron pipe with brass cap (stamped)
Pipe is 24 in. in ground.

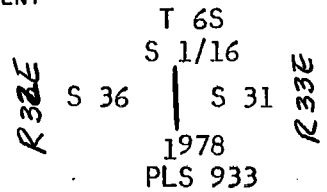

ACCESSORIES : DESCRIBE NEW BT'S WITNESS OBJECTS ETC. ESTABLISHED, OR WORK DONE TO PRESERVE EXISTING EVIDENCE

Scribed BT trees.
Tamarack 33 in. dia. brs. N 10⁰29' W 85.60 ft. marked S 1/16 S36 BT with signs 54-3 and 54-4 and brass washer. Pine 29 in. dia. brs. S 50⁰47' E 18.2 ft. marked S 1/16 S31 BT with signs 54-3 and 54-4 and brass washer.
Set steel post 3 ft. East of corner with signs 54-2 and 54-4.
Painted scribed area and red band around trees.

Work Done By P. Murphy Title Party Chief Date 8/28/78 State Registration No. or Agency _____

Certified Cor. Record Prepared ? Yes No _____ Filed At: County Surveyor Date _____

REMARKS

Witness by: Rick Barton
M. Murtishaw