

CORNER RECORD (PERPETUATION)

MONUMENT: DESCRIBE NEW MONUMENT SET, OR WORK DONE TO PRESERVE EXISTING MONUMENT

ACCESSORIES: DESCRIBE NEW BT'S WITNESS OBJECTS ETC. ESTABLISHED, OR WORK DONE TO PRESERVE EXISTING EVIDENCE

12" Western Larch, N. 3 ¼ E., 69.5 feet, scribed "WB/473" "BT" on double blaze.

Work Done By D. Schlaich

Title

Land Surveyor

Date 10/22/1997

State Registration No.
or Agency

Certified Corner Record Prepared ?

Yes

No

Filed At

Date

REMARKS

Index File No.

T.

R.

M.

Tract or Survey No.

NFJD Unit

Cor. **AP-473**

USDA-FOREST SERVICE

Index

File No.

T. 6 S. R. 33 E.

Merid. WILAMETTE

CORNER RECORD (SEARCH)
(Ref. FSM 7151.4)

R.D. NFJD
N.F. UMATILLA

County UMATILLA
State OREGON

Tract or
Survey No. NFJD Unit

Cor.
No. AP-473

CORNER DIAGRAM

AP-473



DESCRIBE CORNER MONUMENT FOUND

2 1/2" aluminum pipe with 3" aluminum cap, projecting 6" out of the ground, marked "USDA WILDERNESS BOUNDARY NO 473 LS 1636 1989 FOREST SERVICE".

DESCRIBE BEARING TREES OR OTHER OFFICIAL ACCESSORIES FOUND

12" White Fir, S. 36 1/2° W., 16.5 ft., mkd. "WB/473 BT" on single blaze.
11" Western Larch, N. 73° E., 23.2 ft., mkd. "WB/473 BT" on single blaze.
9" Western Larch, N. 75° W., 18.8 ft., mkd. "WB/473 BT" on single blaze.

PHOTO IDENTIFICATION DATA

Photo No.:

Filed At.:

Object Ident.:

Ident. By:

Signature

PLANE COORDINATE POSITION DATA

State: Oregon Zone: North

X: 2,469,235.22'

Y: 494,906.03'

Datum: NAD1927

DESCRIBE CORNER RELATIVE TO NEAR-BY FEATURES, ALSO HOW TO REACH CORNER

From the jct. of roads 52 and 5507 travel southerly on 5507 approx. 1.14 miles to a switchback. From the center of the switchback walk southeasterly up a spur ridge approx. 200 feet to the corner.

Signature

D. Schlaich

Title

Land Surveyor

Division

Headquarters

S.O.

Date

07-1993

FS-7100-52 (3/68)

CORNER RECORD (PERPETUATION)

MONUMENT: DESCRIBE NEW MONUMENT SET, OR WORK DONE TO PRESERVE EXISTING MONUMENT

ACCESSORIES : DESCRIBE NEW BT's WITNESS OBJECTS ETC. ESTABLISHED, OR WORK DONE TO PRESERVE EXISTING EVIDENCE

Work Done By

Title

Date

State Registration No.
or Agency

Certified Cor. Record Prepared ? **NO**

Filed At

Date

REMARKS

Index File No.

T.

6 S.

R.

33 E.

M.

W.M.

Tract or Survey No.

NFJD Unit

Cor.

AP-473

USDA-FOREST SERVICE

Index
File No. _____

T 6S R. 33E

Merid. WILLAMETTE

CORNER RECORD (SEARCH)

(Ref. FSM 7151.4)

R.D. NORTH FORK JOHN DAY County UMATILLA

N.F. UMATILLA State OREGON

NFJD WILD,

Tract or Survey No. NFJD UNIT Cor. No. 473

CORNER DIAGRAM

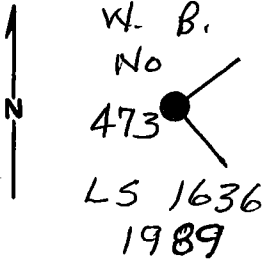

DESCRIBE CORNER MONUMENT FOUND

N/A

DESCRIBE BEARING TREES OR OTHER OFFICIAL ACCESSORIES FOUND

N/A

PHOTO IDENTIFICATION DATA

Photo No. _____

Filed At. _____

Object Ident. _____

Ident. By _____

Signature

PLANE COORDINATE POSITION DATA

State _____ Zone _____

X _____

Y _____

Estab. By _____

Agency

Signature

Title

Division

Headquarters

Date

FS-7100-52 (3/68)

6

7

8

2

3

4

5

CORNER RECORD (PERPETUATION)

MONUMENT: DESCRIBE NEW MONUMENT SET, OR WORK DONE TO PRESERVE EXISTING MONUMENT

SET 2 1/2" x 30" ALUM PIPE w/ 3" ALUM. CAP MARKED AS SHOWN
IN CORNER DIAGRAM.

ACCESSORIES : DESCRIBE NEW BT'S WITNESS OBJECTS ETC. ESTABLISHED, OR WORK DONE TO PRESERVE EXISTING EVIDENCE

12" WHITE FIR S36°30'W, 16.5 ft.
11" W. LARCH N73°E, 23.2 ft, BOTH BLAZED & SCRIBED
"WB/473 BT", 9" W. LARCH N75°W, 18.8 ft. ALSO BLAZED
& SCRIBED "WB/473 BT". ALL 3 HAVE A 3/4" BRASS WASHER, MARKED
"PLS 1636" NAILED TO BLAZE & SIGNS 54-3 & 54-9 ATTACHED

Work Done By D. GAYLORD Title FOREST L.S. Date 6-26-89 State Registration No. 1636
or Agency

Certified Cor. Record Prepared? Yes No Filed At: UMATILLA CO. SURVEYOR Date 1989

REMARKS

Index File No. T. R. M. Tract or Surv. No. Cor. 473

USDA-FOREST SERVICE

Index
File No.

T. 6 S. R. 33 E.
Merid. Willamette

CORNER RECORD (SEARCH)
(Ref. FSM 5151.4)

R.D. North Fork John Day County Umatilla
N.F. Umatilla State Oregon

Tract or Survey No. North Fork John Day Unit
Cor. No. AP-473

CORNER DIAGRAM

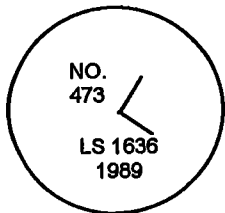

DESCRIBE CORNER MONUMENT FOUND

Found a 2 1/2" aluminum pipe, with aluminum cap, projecting 13" out of the ground.

DESCRIBE BEARING TREES OR OTHER OFFICIAL ACCESSORIES FOUND

11" Western Larch, N. 73 E., 23.2 feet, with burnt out double blaze.
12" White Fir Snag, S. 38 W., 16.5 feet, with burnt out double blaze.
9" Western Larch, N. 74 W., 18.8 feet, with faint scribing visible on burnt double blaze.

PHOTO IDENTIFICATION DATA

Photo No.
Filed At.
Object Ident.
Ident. By
Signature

DESCRIBE CORNER LOCATION RELATIVE TO NEAR-BY FEATURES, ALSO HOW TO REACH CORNER

From the junction of roads 52 and 5507 travel southerly on 5507 approximately 1.14 miles to a switchback. From the center of the switchback walk southeasterly approximately 200 feet to the corner.

PLANE COORDINATE POSITION DATA

State: Zone:
X:
Y:
Datum:

Signature
D. Schlaich

Title
Land Surveyor

Division

Headquarters
S.O.

Date
10/22/1997

FS-7100-52 (3/97)