

Index File No. N-25  
T 6S R. 32E  
Merid. Will

CORNER RECORD (SEARCH)

Tract or Survey No. \_\_\_\_\_  
Cor. No. 330  
No. N-25

R.D. UKIAH County UMATILLA  
N.F. UMATILLA State OREGON

CORNER DIAGRAM

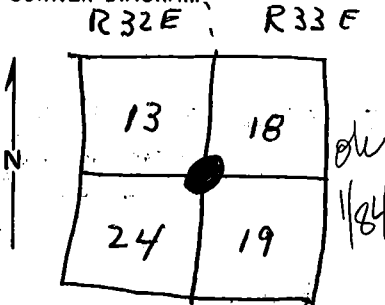

DESCRIBE CORNER MONUMENT FOUND

*Brass Cap Set 1967*

DESCRIBE BEARING TREES OR OTHER OFFICIAL ACCESSORIES FOUND

2

PHOTO IDENTIFICATION DATA

Photo No. \_\_\_\_\_  
Filed At. \_\_\_\_\_  
Object Ident. \_\_\_\_\_  
Ident. By \_\_\_\_\_  
*Signature*

7

DESCRIBE CORNER LOCATION RELATIVE TO NEAR-BY FEATURES, ALSO HOW TO REACH CORNER

3

PLANE COORDINATE POSITION DATA

State \_\_\_\_\_ Zone \_\_\_\_\_  
X \_\_\_\_\_  
Y \_\_\_\_\_  
Etab. By \_\_\_\_\_  
*Agency*

8

Signature

*Salisbury*

Title

Division

Headquarters

Date

*S.O.*

*12-20-67*

7100-52

REV. 65 5

4

CORNER RECORD (PERPETUATION)

MONUMENT. DESCRIBE NEW MONUMENT SET, OR WORK DONE TO PRESERVE EXISTING MONUMENT

Bronze Cap set 1967

9

ACCESSORIES : DESCRIBE NEW BT's WITNESS OBJECTS ETC. ESTABLISHED, OR WORK DONE TO PRESERVE EXISTING EVIDENCE

10

Work Done By BLM Title \_\_\_\_\_ Date \_\_\_\_\_ State Registration No. or Agency \_\_\_\_\_

Certified Cor. Record Prepared ? Yes No Filed At: \_\_\_\_\_ Date \_\_\_\_\_

11

REMARKS

12

Index File No. N-25 T. R. M. Tract or Surv. No. Cor. \_\_\_\_\_

13

# LAND CORNER RECORD

(Rectangular)

5680-2

1. T6S R33E No. N-1 Cor. \_\_\_\_\_ Mer. \_\_\_\_\_ State \_\_\_\_\_ N. F. \_\_\_\_\_  
Dist. CR 6

2. Corner Status

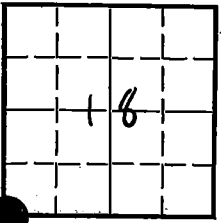

3. Original Description \_\_\_\_\_ Vol. \_\_\_\_\_ Page \_\_\_\_\_ Where Recorded \_\_\_\_\_

4. Description of Corners:

~~CR T6S R33E N-25~~  
see mon. file, Brass Cap

5. Investigation Notes:

7. Photo Identification

Photo No. \_\_\_\_\_

Ident. By: \_\_\_\_\_

8. Plane Coordinate Position Data

State \_\_\_\_\_ Zone \_\_\_\_\_

X \_\_\_\_\_

Y \_\_\_\_\_

Estab. By \_\_\_\_\_

Field Book No. \_\_\_\_\_

Where Filed \_\_\_\_\_

9. Evaluation

Authentic \_\_\_\_\_

Needs Verif. \_\_\_\_\_ Monument \_\_\_\_\_

Re-estab. \_\_\_\_\_ Survey \_\_\_\_\_

Land Status \_\_\_\_\_

6. Signed \_\_\_\_\_ Title \_\_\_\_\_ Date \_\_\_\_\_

PERPETUATION RECORD

10. Monument:

11. Accessories:

Field Book \_\_\_\_\_ Page \_\_\_\_\_

12. Set By \_\_\_\_\_ Title \_\_\_\_\_

License \_\_\_\_\_ Agency \_\_\_\_\_ Date \_\_\_\_\_

13. Recorded By \_\_\_\_\_ Volume \_\_\_\_\_ Page \_\_\_\_\_

(Agency)

(Date) \_\_\_\_\_ (City) \_\_\_\_\_ (County) \_\_\_\_\_ (State) \_\_\_\_\_

14. Remarks:

N-1