

USDA-FOREST SERVICE

Index

File No. X-18

T6S

R32E

Merid. Willamette

R.D.

N.F.

CORNER RECORD (SEARCH)

Ref. FSM 7151.4

North Fork John Day

Umatilla

Tract or

Survey No

County Umatilla

State Oregon

Cor.

No.

x

1

1

Corner Diagram

NI/16

C---C

S35

1968

1 Describe corner monument found

1 Standard BLM brass cap stamped as shown in the corner diagram.

1

1

1

1

1

x

1

x

Photo Identification Data

1 Describe bearing trees or other official accessories found

Photo No.

1 A 14" Douglas Fir bears S35 W, 57.2'.

filed at

1 A 17" Douglas Fir bears N31 E, 27.8'.

Object Ident.

1

Ident. by

1

Signature

1

x

1

x

Plane Coordinate Position Data

1 Describe corner location relative to near-by features, also how to reach corner

State

Zone

1 From the junction of roads 55 and 5505, follow road 5505 southeast 1.6 mile

X

1 to a closed road to the right. Follow this closed road 100' west to a fence.

Y

1 Follow this fence 200' north to the corner.

Estab. by

1

Agency

1

x

1

x

Signature

Title

Division

Headquarters

Date

7100.52

*David L. Harlock*

Land Surveyor

Pendleton, OR

July 1988

CORNER RECORD (PERPETUATION)

X \_\_\_\_\_ X  
Monument: Describe new monument set, or work done to preserve existing monument

Set steel guard post 5' south of the monument and attached Forest Service Land Survey Monument and Property Boundary signs.

X \_\_\_\_\_ X  
Accessories: Describe new BT's witness objects etc. established, or work done to preserve existing evidence

Made bands around trees and painted bands and scribe blazes red. Attached Forest Service Land Survey Monument and Bearing Tree signs to the trees.

X \_\_\_\_\_ X  
Work done by David L. Haddock Title Land Surveyor Date July 1988 State Registration No. 852  
Certified cor. record prepared? yes no x Filed at Date

X \_\_\_\_\_ X  
REMARKS

X \_\_\_\_\_ X

Index File No. X-18

**CORNER RECORD (SEARCH)**

(Ref. FSM 7151.4)

Tract or Survey No. \_\_\_\_\_ Cor. No. X-18

T 6 S R. 32 E

R.D. Dale County Grant Umatilla

Merid. Willamette

N.F. Umatilla State Oregon

**CORNER DIAGRAM**

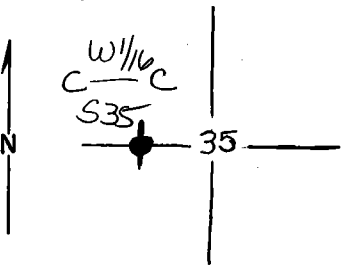

**DESCRIBE CORNER MONUMENT FOUND**

Up ridge from road to slight opening. end of let-down fence.  
 Brass Cap - 3 1/4 dia. - 6" above ground - good condition  
 cadastral survey - BLM - Dept. of Int. W 1/16 - S 35 C 1968

**DESCRIBE BEARING TREES OR OTHER OFFICIAL ACCESSORIES FOUND**

Georgia Pacific - Metal Tag - T6S, R32E. Int. 1/16 cor. sec. 35  
 2 chains west, Douglas Fir - 9" DBH - approx. 20 ft. south of  
 road - up bank - easily seen from road S-747 - Turner Basin.  
 All Bearing Trees flagged - pink ribbon.  
 Brass Cap W 1/16 - S 35 C 1968 - Cadastral Survey - BLM - Dept.  
 of Interior - 3 1/4" dia. - 6" high.

**PHOTO IDENTIFICATION DATA**

Photo No. EXR-4-233  
 Filed At 2210 CENTRAL Desol. C+H  
 Object Ident. Photo Punched - I.D.  
 Ident. By 8-10-71 Reverse

**DESCRIBE CORNER LOCATION RELATIVE TO NEAR-BY FEATURES, ALSO HOW TO REACH CORNER**

BT - end of fence - G.P. - T6S, R32E, S 20 E - 0.46 chain.  
 Int. 1/16 cor. sec. 35 - Ponderosa Pine - 16" DBH - JP-RS-CO.  
 BT - Blazed on S. side (1/16 - sec. 35) Metal tag 54-3. corner is  
 approx. S 33 W - 42 links - T6S, R32E, Sec. 35. CW 1/16 D.B. 9/10/68  
 Douglas Fir - 12" DBH.

**PLANE COORDINATE POSITION DATA**

State \_\_\_\_\_ Zone \_\_\_\_\_  
 X \_\_\_\_\_  
 Y \_\_\_\_\_  
 Estab. By \_\_\_\_\_  
 Agency \_\_\_\_\_

Signature

Emery Swon

Title

Range Causser

Division

Range

Headquarters

Date

Date

8-23-72

Date

7100-52 (3/68)

CORNER RECORD (PERPETUATION)

MONUMENT: DESCRIBE NEW MONUMENT SET, OR WORK DONE TO PRESERVE EXISTING MONUMENT

Bearing Tree - Blazed on NE side ( 1/16 S.35 ) Corner approx. N 35 E, 86 links.  
T6S, R32E, Sec. 35 - CW-1/16 - D.B. - 9/10/68  
Metal tag - 54-3 - Douglas Fir - 12" DBH .

9

ACCESSORIES : DESCRIBE NEW BT'S WITNESS OBJECTS ETC. ESTABLISHED, OR WORK DONE TO PRESERVE EXISTING EVIDENCE

Bearing Tree - Georgia Pacific - T 6 S, R 32 E, Int. 1/16 corner. - 0.29 chain.  
N 21 E - JP-RS-CD. Douglas Fir - 12" DBH.

10

Work Done By \_\_\_\_\_ Title \_\_\_\_\_ Date \_\_\_\_\_ State Registration No. or Agency \_\_\_\_\_

Certified Cor. Record Prepared ? Yes No Filed At: \_\_\_\_\_ Date \_\_\_\_\_

11

REMARKS

12

Index File No. X-18 T. 6 S R. 32 E SEC. 35

Tract or Surv. No.

Cor.

13