

CERTIFIED RECORD OF LAND CORNER MONUMENTATION

A19 2-19

History of original corner establishment:
Corner was originally established by Henry Meldrum,
U.S. Deputy Surveyor, under Contract No. 380,
dated March 19, 1881. Surveyor General records state:
Set a pine post for 1/4 sec. cor.

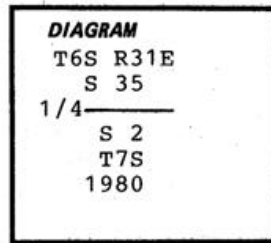

Pine 6 in. dia. bears N64°W 50lks.
Fir 26" in. dia. bears S32°E 32lks.
Corner remonumented by a BLM Cadastral Surveyor,
John P. Lee, in 1980. His records state:
The 1/4 sec. cor. of secs. 2 and 35, on the N. bdy.
of the Tp., monumented with a basalt stone, 10x12X23 ins., not of record,
firmly set 13 ins. in the ground. no marks visible, from which the remains
of the original bearing trees: A fir snag, 28 ins. diam. bears S. 30° E.,
32 lks. dist., with partially chopped out blaze, no marks visible. (Record.
S. 32° E.), A pine snag, 9 ins. diam., bears N. 64° W., 50 lks. dist., with
scribe marks BT visible on partially opened blaze. At the corner point...
Set an iron post 28 ins. long, 2 1/2 ins. diam., 22 ins. in the ground, with
XXXX Description of corner evidence found XXXX brass cap mkd. (as shown on corner diagram),
from which new bearing trees... A fir. 15 ins. diam., bears S. 55° E., 63
lks. dist., mkd. 1/4 S2 BT, A fir. 15 ins., diam. bears N. 3 1/2° W., 17 1/2 lks.
dist., mkd. 1/4 S35 BT. Deposit corner stone alongside iron post.
See sheet two for additional history records, of corner maintenance
performed by Gary Langlitz in July of 1982.

Description of corner evidence found:
3 1/4" brass cap on 2 1/2" galvanized iron pipe in mound of earth and stone
(protruding 8") from which:
A steel fence post is 3.4 feet East of monument with 54-4 and 54-2 signs
attached.
A 7" fallen pine snag bears N 65° W - 33.6 feet, to the stump hole.
A 17" douglas fir bears N 5° W - 11.4 feet, with healed blaze.
A 16" douglas fir bears S 58 1/2° E - 41.8 feet, with partially healed blaze.
A 24 1/2" ponderosa pine snag bears S 32° E - 21.1 feet.

Description of monument and accessories established to perpetuate the
original location of this corner:

Attached sign 54-9 to the existing steel fence post, and removed the 54-4 sign.

New bearing trees established:

A 16" douglas fir bears N 82° E - 42.4 feet, scribed: 1/4 S 35 BT.
A 14" douglas fir bears S 13° W - 27.4 feet, scribed: 1/4 S 2 BT.

New bearing trees have a brass washer stamped 'PLS 1106' nailed to the
face of the blaze. Attached sign 54-3 & 54-9, painted face of blaze & 6"
band around each bearing tree, red.

I hereby certify that the above corner monument
was properly maintained to U.S.F.S. standards
by me on August 10, 1993.

Compass declination 18° East.

Sheet 1 of 2 (continued on page 2)



Office of..... County of.....
State of....., I hereby certify that the within instrument was filed in this office
for record on the..... day of....., 19.....
..... by .....
(COUNTY OFFICIAL) (DEPUTY)

2-19

Form R6-7100-57 (9/71)

RECEIVED BY

U.S. GOVERNMENT PRINTING OFFICE - 1983-793-276

Umatilla County Surveyor
Date 2-94
Rec'd By KK
No. 97-01-B

CERTIFIED RECORD OF LAND CORNER MONUMENTATION

A19

History of original corner establishment:  
Page 2 of 2 Corner History continued:

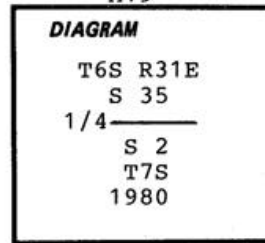

Corner was maintained by Gary Langlitz, on July 27, 1982. His record states: No trace of the orig. corner post remains. Found a 2 1/2" Galvanized Iron Pipe extending 8" above the ground, with brass cap attached, marked: (as per corner diagram) From Which: an original 6" Pine, now a 7" P. Pine snag, with scribing "BT" visible on a previously opened blaze, bears N66°W 33.0 feet, and an orig. 26" Fir, now a 27" Douglas Fir snag, partially opened, scars visible, bears S38 1/2°E 21.1 feet. And BT's apparently established by the BLM: A 14" Douglas Fir with scribing "1/4 S35 BT" visible on an unhealed single blaze, bears N 5 1/2°W 11.3 feet; And a 14" Douglas Fir with scribing "1/4 S 2 BT" visible on a single blaze bears S56°E 42.0 feet.

Description of corner evidence found:

Description of monument and accessories established to perpetuate the original location of this corner:

Sheet 2 of 2

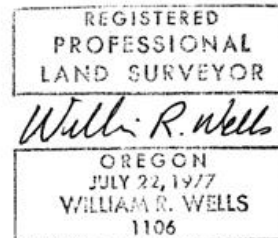

Office of..... County of.....  
 State of....., I hereby certify that the within instrument was filed in this office  
 for record on the..... day of....., 19.....

..... by .....  
 (COUNTY OFFICIAL) RECEIVED BY (DEPUTY)

Form R6-7100-57 (9/71)

Umatilla County Surveyor  
 Date 2-94  
 Rec'd By KK  
 No. 94-02-R

*2-94*