

USDA-FOREST SERVICE

Index
File No. R-07

CORNER RECORD (SEARCH)

(Ref. FSM 7151.4)

Tract or
Survey No. _____ Cor.
No. _____

T 65 R. 31E
Merid. W.M

R.D. NFJD County Umatilla
N.F. Umatilla State Or.

CORNER DIAGRAM

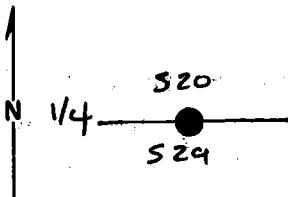

DESCRIBE CORNER MONUMENT FOUND

NONE

DESCRIBE BEARING TREES OR OTHER OFFICIAL ACCESSORIES FOUND

NONE

PHOTO IDENTIFICATION DATA

Photo No. _____
Filed At. _____
Object Ident. _____
Ident. By _____
Signature

DESCRIBE CORNER LOCATION RELATIVE TO NEAR-BY FEATURES, ALSO HOW TO REACH CORNER

From jct of HWY ~~395~~ 395 & Burns Rd. Go westerly on Burns Rd 2.8 miles to rd. jct. Go left (westerly) 0.6 miles to another jct. Travel south approx 0.2 miles to rd jct and go right (westerly) approx 0.4 miles. Then travel southerly approx 1600 Feet. to the corner which is located on top of a spur ridge.

PLANE COORDINATE POSITION DATA

State Or. Zone North
X 2617214.105 meters
Y 152058.848 meters
Established By NAD 83 (1991)
Agency

Signature
Dave Schmitt

Title
Land Surveyor

Division

Headquarters
S.O.

Date
9/19/94

FS-7100-52 (3/68)

CORNER RECORD (PERPETUATION)

MONUMENT: DESCRIBE NEW MONUMENT SET, OR WORK DONE TO PRESERVE EXISTING MONUMENT

Set by proportion a 2 1/2" by 30" aluminum pipe, with 3/4" aluminum cap, 12" in the ground and raised a mound of stone 2 1/2 feet in diameter by 2 feet high.

T65 R31E
1/4 $\frac{520}{529}$
PLS 1636
1994

ACCESSORIES: DESCRIBE NEW BT'S WITNESS OBJECTS ETC. ESTABLISHED, OR WORK DONE TO PRESERVE EXISTING EVIDENCE

RM, 5/8 Rebar with 1 1/2" aluminum cap, N 54° 40' E 60.47 FT. MKD "USDA-FS RM 520 60 47 FT " LS 1636
 Buckhorn No. 3, 3/4" aluminum cap, S 68° 45' E, 61.60 FT MKD "GPS BUCKHORN NO. 3 1994"
 RM, 5/8 Rebar with 1 1/2" aluminum cap, S 12° 30' W, 79.41 FT MKD "USPA-FS RM 79 41 FT 529 LS 1636"
 RM, 5/8 Rebar with 1 1/2" alum. cap, N 15° 52' W, 78.21 FT MKD "USPA-FS RM 520 78 21 FT LS 1636"

10

Work Done By D. Grayland Title Land Surveyor Date 9/94 State Registration No. PLS 1636
 or Agency

Certified Cor. Record Prepared? Yes No Filed At: Umatilla Co. Date

11

REMARKS

Index File No. R-07 T. 6 S R. 31 E M. W. M. Tract or Surv. No.

Cor.

12

13