

Index
File No. 0-09

CORNER RECORD (SEARCH)

(Ref. FSM 7151.4)

Tract or Survey No. _____ Cor. No. _____

T GS R. 31E
Merid. W.M.

R.D. NFJD County Umatilla
N.F. Umatilla State Or.

CORNER DIAGRAM

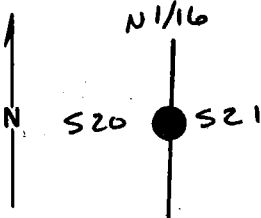

DESCRIBE CORNER MONUMENT FOUND

NONE

DESCRIBE BEARING TREES OR OTHER OFFICIAL ACCESSORIES FOUND

NONE

PHOTO IDENTIFICATION DATA

Photo No. _____
Filed At. _____
Object Ident. _____
Ident. By _____
Signature

PLANE COORDINATE POSITION DATA

State Or. Zone North
X 2618000.915 meters
Y 153294.147 meters
Established by NAD83 (1991)

DESCRIBE CORNER LOCATION RELATIVE TO NEAR-BY FEATURES, ALSO HOW TO REACH CORNER

From jet of HWY 395 & ~~Burma~~ Burma Rd. Travel westerly on Burma Rd for approx 2.8 miles to a ~~jet~~ road jet. Go westerly (left) on spur road for approx 0.3 miles. ~~The~~ ~~corner is located~~ to crossing of the property line. The corner is located **EASTERLY ALONG PROPERTY APPROX 700 feet.**

Signature
Dave S. [unclear]

Title
Land Surveyor

Division
S.O.

Headquarters
S.O.

Date
09/64

CORNER RECORD (PERPETUATION)

MONUMENT: DESCRIBE NEW MONUMENT SET, OR WORK DONE TO PRESERVE EXISTING MONUMENT

Set 2 1/2" by 30" aluminum pipe, with 3 1/4" aluminum cap,
23" in the ground and raised mound of stone 1 1/2 feet in
diameter by 1 1/2 feet high.

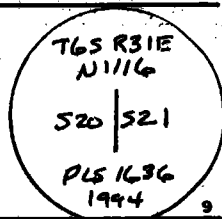

ACCESSORIES: DESCRIBE NEW BT'S WITNESS OBJECTS ETC. ESTABLISHED, OR WORK DONE TO PRESERVE EXISTING EVIDENCE

18" Ponderosa Pine N 69 1/2 E 43.2 feet mkd "N 1/4 S21" "BT"
11" Western Larch S 5 3/4 W 85.7 feet mkd "N 1/4 S20" "BT".
Both BT's are double blazed.

10

Work Done By D. Gaylord Title Land Surveyor Date 09/94 State Registration No. PLS 1636
or Agency

Certified Cor. Record Prepared? Yes No Filed At: Umatilla Co. Date

11

REMARKS

12

Index File No. 0-09 T. 6 S R. 31 E M. W. M. Tract or Surv. No. Cor. 13