

Index J-5
File No. _____
T 65 R. 31E
Merid. Will.

CORNER RECORD (SEARCH)
(Ref. FSM 7151.4)
R.D. Ukiah County Umatilla
N.F. Umatilla State Oregon

Tract or Survey No. _____
Cor. No. J-5

CORNER DIAGRAM

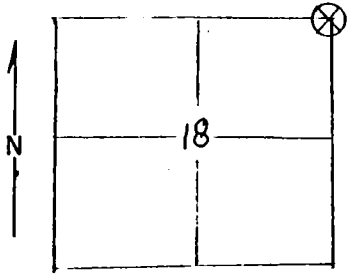

DESCRIBE CORNER MONUMENT FOUND
Post. The markings were gone. 2

PHOTO IDENTIFICATION DATA

Photo No. _____
Filed At. _____
Object Ident. _____
Ident. By _____
Signature 7

DESCRIBE BEARING TREES OR OTHER OFFICIAL ACCESSORIES FOUND
Ponderosa pine 22.2" DBH bearing N75°E 42 lks is in poor cond. Painted a 6" red band around it and attached two signs on tree, attention on back and bt on front. Found a pine stump bearing N10°W, 203 lks. No scribing on it. Found a log with a good Bt on it bearing S17°W 115 lks, painted scribing and attached an attention sign to it. Found a pine stump with part of a face on it bearing S52°E 59 lks, no scribing was visible. 3

PLANE COORDINATE POSITION DATA

State _____ Zone _____
X _____
Y _____
Estab. By _____
Agency 8

DESCRIBE CORNER LOCATION RELATIVE TO NEAR-BY FEATURES, ALSO HOW TO REACH CORNER 4

Signature
MLC

Title
For, Tech

Division
USFS

Headquarters
Ukiah

Date
4/19/78

7100-52 (3/68) 5