

**History of original corner establishment:**

A brief history of surveys concerning this corner follows:

The original corner point was determined by Rufus S. Moore in 1881.

In 1968, the BLM recovered the original corner monument and bearing tree. In conjunction with a resurvey, the BLM established the true point for the closing corner and placed a brass-capped iron pipe monument and two new bearing trees.

In 1983, Dennis L. Gaylord, Oregon LS 1636 and Cadastral Surveyor for the Umatilla National Forest, referenced the corner location to avoid its destruction during planned road construction in the area. (Refer to the records of the Umatilla County Surveyor for Gaylord's referencing notes).

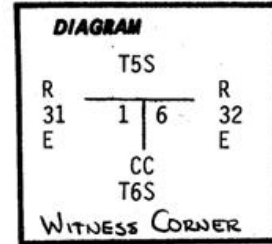

**Description of corner evidence found:**

The true point for the closing corner is now located in the new Ukiah-Granite roadway, the prior monument apparently has been buried.

We find the BLM bearing trees and the Gaylord reference monuments in place and agreeing with the record. The original Moore BT has been removed by road construction.

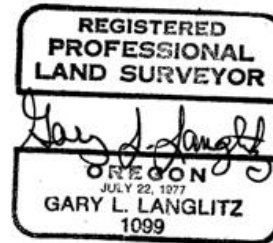

**Description of monument and accessories established to perpetuate the original location of this corner:**

We re-establish the true point for the closing corner by reference to the Gaylord reference monuments. At the true closing corner, we set a 5/8"x30" iron rod in the roadbed with plastic cap attached, marked "AP & A."

Since the true corner point will eventually be covered by asphalt paving, we establish a witness corner as follows:

By reference to the Azimuth's stated in the Gaylord Record, at a point 26.0 feet North of the true corner point, and at the witness corner, we set a 2"x30" aluminum pipe, 18" in the ground and in a rock mound, with aluminum cap marked: from which:

The northwesterly reference monument established by Gaylord, A 5/8" iron rod in a mound of stone bears N18°W 112.5 feet. We place a plastic cap marked "AP & A" on the 5/8" iron rod. And a 1/2" iron rod with plastic cap marked "FHWA CP" bears S79°E 125.8 ft.

1984  
OPLS 1099  
WC 26.0 Ft.  
T5S  
S1/S6  
R31E CC R32E  
T6S

At the request of Dennis Gaylord, we remove his north-easterly reference monument, a 5/8" iron rod.

The witness corner is located approx. 3 ft. south of the northerly right-of-way fence of the Ukiah-Granite road.

Magnetic compass (20° east declination)  
Steel tape

Sept. 5, 1984

Gary Langlitz, LS 1099  
Ray Crapo  
Greg Orton

Office of Surveyors County of Umatilla  
State of Oregon, I hereby certify that the within instrument was filed in this office  
for record on the 5th day of October, 1984  
David Krumbein by Betty Cochran  
(COUNTY OFFICIAL) (DEPUTY)