

Index  
File No. V-1

CORNER RECORD (SEARCH)

(Ref. FSM 7151.4)

Tract or Survey No. \_\_\_\_\_ Cor. No. \_\_\_\_\_

T 6N R. 39E R.D. WALLA WALLA County UMATILLA

Merid. WILLAMETTE N.F. UMATILLA State OREGON

CORNER DIAGRAM

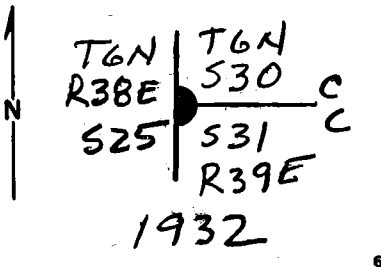

DESCRIBE CORNER MONUMENT FOUND

BRASS CAPPED IRON PIPE FOUND BY BLM

DESCRIBE BEARING TREES OR OTHER OFFICIAL ACCESSORIES FOUND

PHOTO IDENTIFICATION DATA

Photo No. \_\_\_\_\_  
Filed At. \_\_\_\_\_  
Object Ident. \_\_\_\_\_  
Ident. By \_\_\_\_\_  
*Signature*

DESCRIBE CORNER LOCATION RELATIVE TO NEAR-BY FEATURES, ALSO HOW TO REACH CORNER

PLANE COORDINATE POSITION DATA

State \_\_\_\_\_ Zone \_\_\_\_\_  
X \_\_\_\_\_  
Y \_\_\_\_\_  
Estab. By \_\_\_\_\_  
*Agency*

Signature

Title

Division

Headquarters

Date

1991

FS-7100-52 (3/68)

**CORNER RECORD (PERPETUATION)**

**MONUMENT: DESCRIBE NEW MONUMENT SET, OR WORK DONE TO PRESERVE EXISTING MONUMENT**

9

**ACCESSORIES : DESCRIBE NEW BT's WITNESS OBJECTS ETC. ESTABLISHED, OR WORK DONE TO PRESERVE EXISTING EVIDENCE**

10

Work Done By \_\_\_\_\_ Title \_\_\_\_\_ Date \_\_\_\_\_ State Registration No. \_\_\_\_\_  
or Agency \_\_\_\_\_

Certified Cor. Record Prepared ? Yes No Filed At: \_\_\_\_\_ Date \_\_\_\_\_

11

**REMARKS**

12

Index File No. T. R. M. Tract or Surv. No. Cor. 13

**CORNER RECORD (SEARCH)**

(Ref. FSM 7151.4)

Index File No. V-1  
 T 6 N R. 39 E  
 Merid. Wm.

Tract or Survey No. \_\_\_\_\_  
 R.D. Walla Walla County Umatilla  
 N.F. Umatilla State Oregon

Cor. No. 3 Sec. 3

**CORNER DIAGRAM**

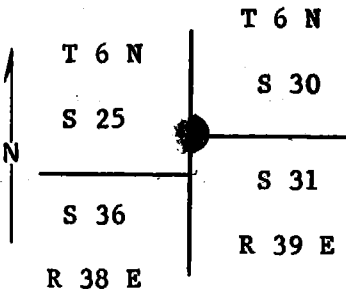

**DESCRIBE CORNER MONUMENT FOUND**

2" Iron Pipe With Brass Cap Marked

**DESCRIBE BEARING TREES OR OTHER OFFICIAL ACCESSORIES FOUND**

A 40" Fir, Bears S 30 E, 23' Dist.  
 A 14" Fir, Bears N 70 E, 36' Dist.

Placed B.T. Signs And Marked Both Trees With Paint.

**PHOTO IDENTIFICATION DATA**

Photo No. \_\_\_\_\_  
 Filed At. \_\_\_\_\_  
 Object Ident. \_\_\_\_\_  
 Ident. By \_\_\_\_\_  
 Signature \_\_\_\_\_

**DESCRIBE CORNER LOCATION RELATIVE TO NEAR-BY FEATURES, ALSO HOW TO REACH CORNER**

Corner Lays On Steep N.E. Wooded Slope 20' West Of Ravine  
 10' East Of Defined Game Trail.

**PLANE COORDINATE POSITION DATA**

State \_\_\_\_\_ Zone \_\_\_\_\_  
 X \_\_\_\_\_  
 Y \_\_\_\_\_  
 Estab. By \_\_\_\_\_  
 Agency \_\_\_\_\_

**SEE BACK OF CARD**

Signature D.B. Baker

Title Eng. Tech

Division Engr

Headquarters Walla Walla

Date 9-4-63

7100-52 (3/68)

CORNER RECORD (PERPETUATION)

MONUMENT: DESCRIBE NEW MONUMENT SET, OR WORK DONE TO PRESERVE EXISTING MONUMENT

ACCESSORIES : DESCRIBE NEW BT'S WITNESS OBJECTS ETC. ESTABLISHED, OR WORK DONE TO PRESERVE EXISTING EVIDENCE

Work Done By \_\_\_\_\_ Title \_\_\_\_\_ Date \_\_\_\_\_ State Registration No. or Agency \_\_\_\_\_  
Certified Cor. Record Prepared ? Yes No Filed At: \_\_\_\_\_ or South ? Date \_\_\_\_\_

REMARKS

THIS CORNER LAYS APPROXIMATELY 20 FEET NORTH OF THE EAST CORNER COMMON TO SECTIONS 25 AND 36 OF T6N R38E. (SEE T6N R38E V-25)

4-13-72 J.W. Blom

Index File No. V-1 T. R. M. Tract or Surv. No. Cor. 12 13