

HISTORY OF ORIGINAL CORNER ESTABLISHMENT:

This record has been prepared to provide current information regarding the condition of the corner monument and accessories as described in the survey records cited below. Verification of the position of the corner monument and dimensions to existing accessories, and the establishment of new corner accessories was not performed as part of this visit.

The source of the monumentation and dimensions cited in this record is a Dependent Resurvey of ... Portions of the South and East Boundary, and Subdivisional Lines of Township 6 North, Range 38 East, Willamette Meridian, conducted by the Bureau of Land Management, commenced on October 13, 1987, and completed September 16, 1991.

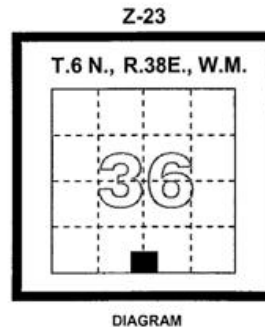

RECORD DESCRIPTION OF CORNER MONUMENT AND ACCESSORIES:

From the BLM Dependent Resurvey:

The 1/4 sec. cor. of sec. 36 only, monumented with an iron post, 1 in. diam., firmly set, protruding 8 ins. above the ground, with brass cap mkd. (see Diagram below), from which bearing trees marked by Gould:

- A fir, 32 ins. diam., bears N43°E 33 lks. dist., with healed blaze,
- A spruce, 32 ins. diam., bears N 22°W 55 lks. dist., with healed blaze.

DESCRIPTION OF MONUMENT AND ACCESSORIES FOUND AT THIS CORNER LOCATION:

Found:

A 2 1/2" diameter brass cap, marked as shown, on a 1" dia. Iron pipe, firmly set and extending 8" above ground, from which:

A 32" diameter Grand Fir, alive and in good condition, with well healed single blaze, (Gould NE bearing tree),

A 20" diameter Subalpine Fir, standing dead, with healed single blaze, (Gould NW bearing tree),

Additionally, we find an 18" diameter Engelmann Spruce, alive and in good condition, with pitch covered unhealed single blaze, and brass washer attached, marked "OR 2360 WA 25893", for which we find no information in the Umatilla County, Oregon survey records, regarding the history of this corner accessory.

This corner is located on a gentle SW slope.

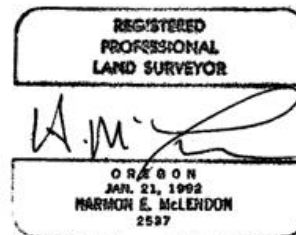

I hereby certify that the above corner position was visited and found as described on October 17, 2005.

Witnesses: Tim Johnson, Gary Langlitz, Jeremy Jones

S:\WallaWalla\MillCreek\DOCS\6N38223.doc

RECEIVED BY
 Umatilla County Surveyor
 Date 1-06
 Rec'd By KE
 No. 06-14-R