

OREGON CORNER RESTORATION FORM

Section: 34 & 35
 Township: 6 North
 Range: 35 East of the Willamette Meridian
 County: Umatilla
 Date: June 28, 2002

Corner Indexing Information: Township 6N Range 35E Corner Code X 17 (Willamette Meridian)
 Additional Identifier: (e.g. BLM designation for the corner, street intersection, plat name, block, lot, etc.)

This quarter corner is common to sections 34 & 35.

Oregon Plane Coordinates: N: 841087.593 E: 8732814.964

Zone: North Order: second Datum: NAD83-91 Convergence: 1°28'47.7" Scale Factor: .99994397

Previous Renewals/Surveys, etc.: Originally surveyed by U.S. Deputy Surveyor William Odell under his contract No. 110, dated 8-23-1865. The Surveyor General's notes state, "set quarter section post corner, drove charred stake, dug pits, and raised mounds as per instructions." Survey No. 173, Book 1, Page 516, dated September 22, 1903, Kimbrell mentions this corner but does not describe it. County Survey No. 427, Book 2, Page 303, dated April 1919, Perry used this corner to subdivide the Northwest quarter of section 35, but does not describe it. Survey No. 02-18-B, dated 02-2002, Haddock set a 2 1/2" brass cap on a 1"x30" galvanized iron pipe based on the found Perry rock at the Northwest corner of section 35 and Perry's found Northwest 1/16 corner of section 35.

Monument(s) & Accessories Found (Condition & Source):

At the west quarter corner of section 35, T6N R35E, we found 2 1/2" brass cap in a 5" diameter iron monument case 1" below the surface of a 1.5 foot square concrete apron.

Monument Set (Procedures & Description):

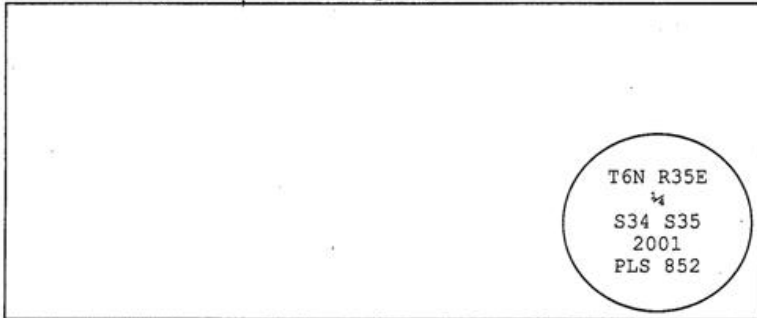

Monument Detail:

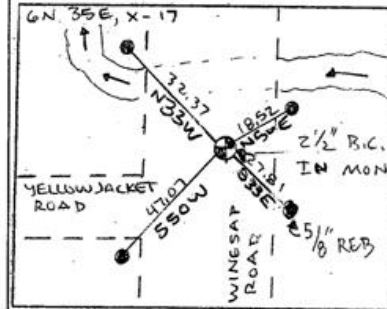

New Accessories: WE SET:

A 5/8 rebar with yellow plastic cap stamped 'Tomkins Surveying' which bears N 50°E ~ 18.52 from the corner in the pavement. Attached a Umatilla County Bearing object sign to t-post. A 5/8 rebar with yellow plastic cap stamped 'Tomkins Surveying' which bears S 33°E ~ 27.81 feet from the corner. No Umatilla County Bearing object sign or t-post set. A 5/8 rebar with yellow plastic cap stamped 'Tomkins Surveying' which bears S 50°W ~ 47.07 feet from the corner. Attached a Umatilla County Bearing object sign to the northeast face of power pole. A 5/8 rebar with yellow plastic cap stamped 'Tomkins Surveying' which bears N 33°W ~ 32.37 feet from the corner. Attached a Umatilla County Bearing object sign to the southeast face of power pole.

Location & Comments:

Compass Declination:

19° East

Surveyor's Seal

Firm/Agency: Tomkins Land Surveying, Inc.
 20 E. Poplar, Suite 204
 Walla Walla, WA 99362

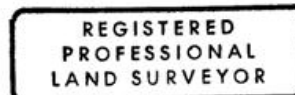

Paul W. P. Tomkins

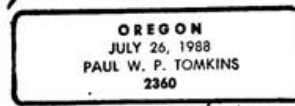

*renews 6/30/04
 6/30/02*

Party Chief: Bryan Martin
 Notes: Bryan Martin
 Witness: Eric Flowers