

OREGON CORNER RESTORATION FORM

Section 34 Township 6 N Range 35E
 County Umatilla Date: Jan. 2001

Corner Designation: **6n35v17**

____ Condition Report Only
 ____ Not found
x Remonumented
 ____ Unrecorded
 ____ Surveyed in
x Referenced out

Previous Renewals / Surveys, etc.

This corner was established by Odell and Lewis under Contract 110 dated Feb. 7, 1865. The corner was monumented with posts and pits.

In 1919, Aubrey Perry found a broken stone marked with an "X" and remonumented it with another stone as recorded in Survey 427.

In 1974 under survey I-90-Ax, Streamer set an iron pin in the intersection of Winesap and Umapine Roads at an intersection of two lines. This pin was replaced with a brass cap by the Oregon Department of Transportation (ODOT).

Monument and Accessories found: (condition and source)

Found Perry's stone 32" below the surface in good condition. Also found the ODOT brass cap.

DIAGRAM

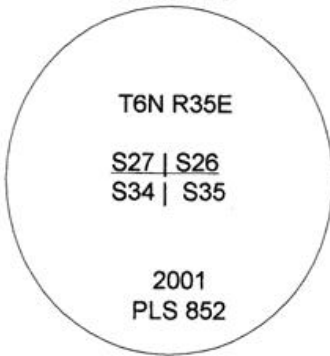

SKETCH

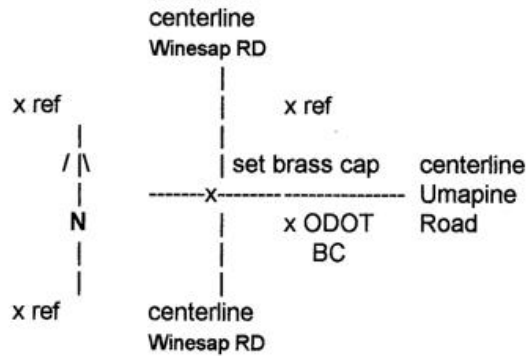

MONUMENT (S) AND ACCESSORIES SET (Procedures and Description)

At a point directly above Perry's undisturbed stone, I set a 1 1/4" x 30" GIP with a 2 1/2" brass cap stamped as shown in the diagram above. the top of the cap is at the paved surface.

REFERENCES SET:

The previous corner monument, a 2 1/2" brass cap by ODOT bears S73°55'23"E, 10.02'. Three 5/8" x 24" rebars with 1.3" red plastic caps stamped ORLS 852 and WALS 13922 were set & bear: N53°54'35"W, 53.28'; N41°40'05"E, 38.36'; and S58°16'32"W, 51.69'.

Location and comments

The following people witnessed the discovery of the Perry monument
 Humbert Asphalt employees: Mark Lowery, John Seely and Nick McCoy.
 Local resident Jim Waliser also observed the Perry stone.

Compass Declination

Firm / Agency

David L. Haddock, PLS 852
 Haddock Surveying
 P. O. Box 1574
 Pendleton, OR 97801.

Surveyors Seal

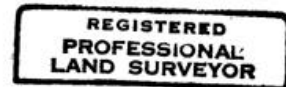

David L. Haddock

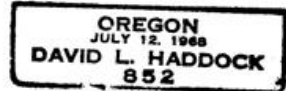

RENEWS 6-30-03

RECEIVED BY:

Date: 2-02
 Rec'd By: KK
 No. 02-18-B