

**OREGON CORNER RESTORATION FORM**

Section 30 Township 6N Range 36E  
 County Umatilla Date: September 26, 2007

Corner Designation: 6N36U1

- Condition Report Only
- Not found
- Remonumented
- Unrecorded
- Surveyed in
- Referenced out

South 1/16th to Section 25 R35E, and 30, R36E, T6N  
 W.M., Umatilla County, Oregon.

Previous Renewals / Surveys, etc.

I have not researched the origin of this stone. It has been held as the 1/16th corner at least since 1966 as seen on survey H-139-A. It has been used on multiple other surveys in the area including I-99-Ax and 92-03-C. This report is to provide a sketch of its location only.

Monument and Accessories found: ( condition and source )

I found a rounded basalt stone with a distinct "+" on top. The top of the stone is 12" x 11". I did not measure the depth of the stone. The top of the stone is approximately 2" below the surface.

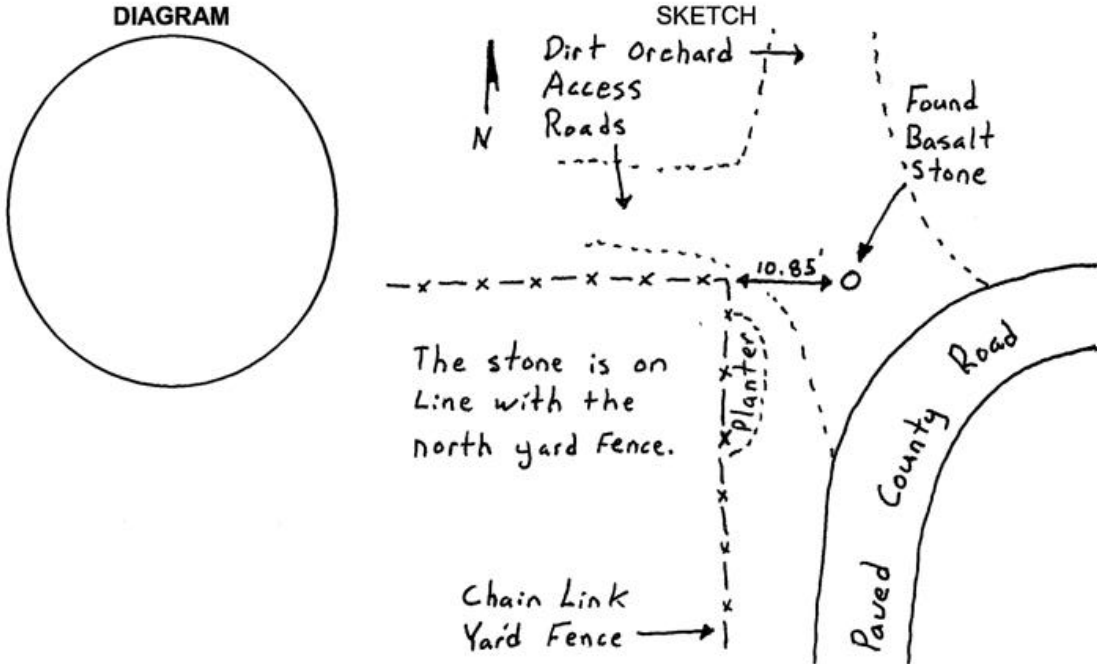

MONUMENT (S) AND ACCESSORIES SET (Procedures and Description)  
 None.

REFERENCES SET:  
 None.

The monument was tied using a Trimble R7/R8 RTK GPS.

Location and comments

Compass Declination

Surveyors Seal

RECEIVED BY:  
Umatilla County Surveyor  
 Date: 02-08  
 Rec'd By: [Signature]  
 No. 08-039-C

Firm / Agency  
 Witness Tree Surveying  
 Address  
 P.O. Box G  
 Pilot Rock, OR 97868  
 Party Chief  
 Stephen K, Haddock

REGISTERED  
 PROFESSIONAL  
 LAND SURVEYOR

*Stephen K. Haddock*

OREGON  
 JULY 9, 2001  
 STEPHEN K. HADDOCK  
 56295LS

RENEWAL DATE 6-30-09