

OREGON CORNER RESTORATION FORM

Section: 14
Township: 6 North
Range: 35 East of the Willamette Meridian
County: Umatilla
Date: June 1, 2002

Corner Indexing Information: Township 6N Range 35E Corner Code J-K 19 (Willamette Meridian)

Additional Identifier: (e.g. BLM designation for the corner, street intersection, plat name, block, lot, etc.)

This corner is common to intersection of the North and South centerline of section 14 with the Stateline.

Oregon Plane Coordinates: N: 857887.346 E: 8734898.707

Zone: North **Order:** second **Datum:** NAD83-91 **Convergence:** 1°29'13.0" **Scale Factor:** .99996210

Previous Renewals/Surveys, etc: County Survey No. 309, Book 2, Page 164, dated February 16, 1910, Kimbrell shows the CCI/4 corner on Stateline but doesn't describe it. Survey 96-30-B, dated 2-28-96, Tomkins Land Surveying set a 5/8"x30" iron rebar with a 2" aluminum cap at the surveyed position.

Monument(s) & Accessories Found (Condition & Source):

At the intersection of the center of Section 14, T6N R35E, and Stateline, found a 5/8" rebar.

Monument Set (Procedures & Description):

At the location of the 5/8" iron rebar we set a 1"x30" flared end galvanized pipe with 2 1/2" brass cap 6" below surface shoulder gravel stamped. (see example below)

T6N R35E
 LS 2360
 WASHINGTON
 1/4
 S 14
 2001

Monument Detail:

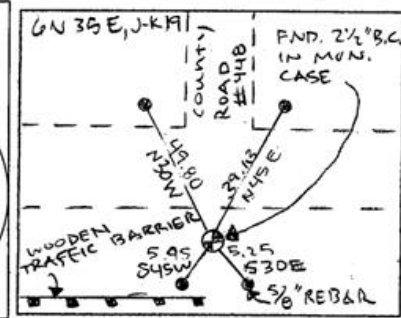

New Accessories: WE SET:

A 5/8 rebar with yellow plastic cap stamped 'Tomkins Surveying' which bears N 32°E ~ 37.59 feet from the corner. Attached a Umatilla County Bearing object to the South face of the railroad tie fence post. A 5/8 rebar with yellow plastic cap stamped 'Tomkins Surveying' which bears S 55°E ~ 18.32 feet from the corner. Attached a Umatilla County Bearing object to an existing t-post. A 5/8 rebar with yellow plastic cap stamped 'Tomkins Surveying' which bears S 32°W ~ 6.55 feet from the corner. Attached a Umatilla County Bearing object to a t-post Set a concrete nail with brass washer "WA 25893 OR 2360" in the center of east bound travel lane which bears N 55°W ~ 14.57 feet from the corner, added bearing "BO" to washer.

Location & Comments:

Compass Declination:

19° East

Firm/Agency: Tomkins Land Surveying, Inc.
 20 E. Poplar, Suite 204
 Walla Walla, WA 99362

Party Chief: Bryan Martin
Notes: Bryan Martin
Witness: Eric Flowers

Surveyor's Seal

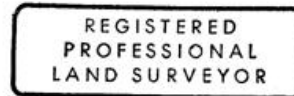

Paul W. P. Tomkins

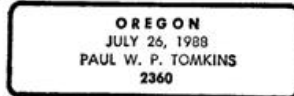

renews 6/30/09
6/30/02