

**OREGON CORNER RESTORATION FORM**

Section 33 Township 6N Range 34E  
 County Umatilla Date: June 12, 2003

Corner Designation: 6N34V13

Corner to sections 27, 28, 33, and 34, T6N, R34E,  
 W.M., Umatilla County, Oregon.

Condition Report Only  
 Not found  
 Remonumented  
 Unrecorded  
 Surveyed in  
 Referenced out

Previous Renewals / Surveys, etc.

Corner originally set by Deputy Surveyor Wm. H. Odell under contract No. 110 dated February 7th, 1865. His record reads: Set post Cor. for Secs. 27, 28, 33, & 34. Drove charred stake, dug pits & raised mound, as per instructions. The section line was reestablished in 1974 by the BPA but not monumented in 1974. See survey 82-46-B. Paul Tomkins set a rebar based on double proportionate methods under survey 00-031-C and replaced it with a brass cap under survey 03-23-C.

Monument and Accessories found: ( condition and source )

The brass cap by Tomkins falls approximately 39' north of the north right of way fence of the County road in a wheat field and approximately 58 feet west of the projection of the north - south fence which runs south from the south right of way fence.

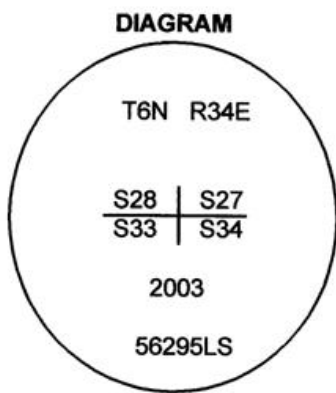

- ⊙ = 1" x 24" Iron Rebar
- = B.O. By Tomkins
- = Iron rebar reference

**MONUMENT (S) AND ACCESSORIES SET (Procedures and Description)**

I set a 1" x 24" iron rebar with a 2" aluminum cap stamped as shown in the diagram above 6" below the surface of the road. I calculated this corner position by holding the section line as seen in surveys 82-46-B and 88-74-B by Krumbein and using the record distance given in the deed to Columbia REA in Book 216, Page 162. The position falls in the center of the County Road right of way as determined by the fences.

For references, I set two, 5/8" by 24" rebars with 1.25" orange plastic caps attached, stamped WTS and 56295LS as described below: I also used two of Tomkins' references.

- an iron rebar bears N05°51'07"E, 25.04 feet set by Tomkins;
- an iron rebar bears N70°14'22"W, 68.65 feet set by Tomkins;
- an iron rebar bears S39°35'42"W, 33.96 feet;
- an iron rebar bears S50°04'35"E, 45.90 feet;

The monument and references were tied using a LIECA system 300 RTK GPS.

Location and comments  
 NAD 83-91 location based on a single GPS tie to tri station GEER.

N = 842630.07  
 E = 8695831.51  
 RECEIVED BY:  
Umatilla County Surveyor  
 Date: 10-03  
 Rec'd By: KE  
 No. 03-314-C

Compass Declination

Firm / Agency  
 Haddock Surveying  
 Address  
 P.O. Box 1574  
 Pendleton, Or. 97801  
 Party Chief  
 Stephen K, Haddock

Surveyors Seal

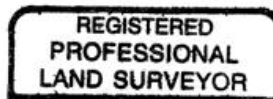

*Stephen K. Haddock*

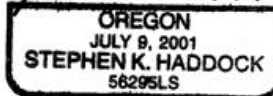

RENEWAL DATE 6-30-05