

OREGON CORNER RESTORATION FORM

Section: 27
Township: 6N
Range: 34 EWM
County: Umatilla
Date: 12/30/99
Corner Designation: R-13

Previous Renewals/Surveys, etc.: Original GLO corner established as a post, with pits and mounds, by Odell, under contract No. 110, in 1865.

Monument(s) & Accessories Found (Condition & Source: No evidence found.

Monument Detail: Set 1" pipe topped w/ 2" brass cap 14" deep in field.

T6N
21 | 22
+
28 | 27
R34E
1999
LS 2360

Monument Set (Procedures & Description):

At a computed double proportioned position using the established corners at the NW corner of S.28, the NE corner of S.26, the West 1/4 corner of S.15, and accepting a fence corner for the SW corner of S.34 (see LCR), we set the corner described above. The corners were tied and set using Trimble 4400 receivers using real time kinematic methods having standard errors of 1cm plus 2ppm times the baseline length.

New Accessories:

We set:

A 5/8" rebar w/ yellow cap stamped 'Tomkins Surveying' which bears N45°W 10.0' from the corner. Bar buried 14" deep.

A 5/8" rebar w/ yellow cap stamped 'Tomkins Surveying' which bears N45°E 10.0' from the corner. Bar buried 12" deep.

A 5/8" rebar w/ yellow cap stamped 'Tomkins Surveying' which bears S46°E 93.78' from the corner, and attached B.O. tag to irrigation head.

A 5/8" rebar w/ yellow cap stamped 'Tomkins Surveying' which bears S2°E 70.63' from the corner, and attached B.O. tag to adjacent telephone pedestal.

Location & Comments:

The corner falls in a field 75' north of Troyer Road.

Compass Declination:

19° East Dec. used to tie B.O.'s.

Firm/Agency: Tomkins Land Surveying, Inc.
20 E. Poplar Ste. 204
Walla Walla WA 99362

Party Chief: Thomas S. Butler
Notes: Thomas S. Butler
Witness: Brianna Slater

Surveyor's Seal

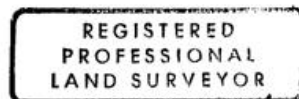

Paul W. P. Tomkins

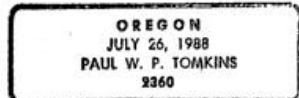

2/1/00

00-31-B