

OREGON CORNER RESTORATION FORM

Section: 17 & 18
 Township: 6 North
 Range: 34 East of the Willamette Meridian
 County: Umatilla
 Date: June 1, 2002

Corner Indexing Information: Township 6N Range 34E Corner Code J-K 5 (Willamette Meridian)

Additional Identifier: (e.g. BLM designation for the corner, street intersection, plat name, block, lot, etc.)

This corner is common to sections 17 & 18.

Oregon Plane Coordinates: N: 856748.006 E: 8684701.243

Zone: North **Order:** second **Datum:** NAD83-91 **Convergence:** 1°20'48.6" **Scale Factor:** .99997474

Previous Renewals/Surveys, etc.: This corner was originally set by U.S. Deputy Surveyors William Odell and William Lewis under their contract No. 110 dated February 7, 1865. The Surveyor General's notes state "set post corner, drove charred stake, dug pits and raised mounds per instructions".

County Survey No. Q-814-B, dated 1946, by C.H. Storms shows an iron pin. No other history of the origin of this pin or the found 1/2" iron pipe was found.

Monument(s) & Accessories Found (Condition & Source):

At the intersection of the West Line of Section 17 and State line 1/2" Iron Pipe 0.25 below Asphalt, 2.2 South of the North edge of Asphalt.

Monument Set (Procedures & Description):

Drove a 1 1/2" x 15 1/2" galvanized iron pipe around the found 1/2" iron pipe and filled the pipe with concrete. Placed 10" of concrete around the pipe and set a 2" brass cap on the top of the pipe at 1/2" sub-surface paving stamped (see example to the right).



Monument Detail:

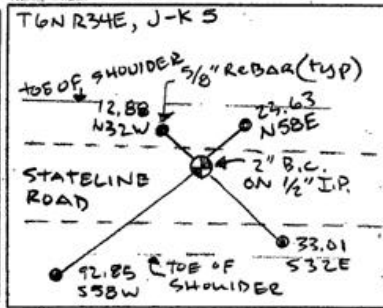

New Accessories: WE SET:

A 5/8 rebar with yellow plastic cap stamped 'Tomkins Surveying' which bears N 58°E ~ 23.63 feet from the corner. Set steel t-post along side and attached a Umatilla County Bearing Object sign. A 5/8 rebar with yellow plastic cap stamped 'Tomkins Surveying' which bears S 32°E ~ 33.01 feet from the corner. Set steel t-post along side and attached a Umatilla County Bearing Object sign. A 5/8 rebar with yellow plastic cap stamped 'Tomkins Surveying' which bears S 58°W ~ 92.85 feet from the corner. Attached a Umatilla County Bearing Object sign to the NW face of the power pole. A 5/8 rebar with yellow plastic cap stamped 'Tomkins Surveying' which bears N 32°E ~ 12.88 feet from the corner. Set steel t-post along side and attached a Umatilla County Bearing Object sign.

Location & Comments:

Compass Declination:

19° East

Firm/Agency: Tomkins Land Surveying, Inc.
 20 E. Poplar, Suite 204
 Walla Walla, WA 99362

Party Chief: Bryan Martin
Notes: Bryan Martin
Witness: Eric Flowers

Surveyor's Seal

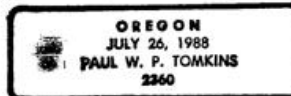
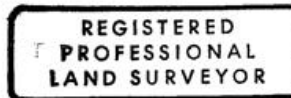

*renews 6/30/04
 6/30/02*

03-23-C