

OREGON CORNER RESTORATION FORM

COUNTY: Umatilla DATE: 06/19/01

CORNER DESIGNATION: T-13

PREVIOUS RENEWALS/SURVEYS ETC.: Corner originally established by Nicholas O. Walden, U.S. Dept. Surv., under Contract No. 209, dated July 6, 1874. Record states: Drove charred stake & raised mound of earth, with pits, etc., as per instructions, for 1/4 Sec. Cor.

MONUMENT AND ACCESSORIES FOUND: Accepted fence corner with fences North and West, a partial old fence East and a field line South as best remaining evidence of the original corner location.

MONUMENT MARKING DETAIL:

T6N R32E
1/4
S28 | S27
2001
PLS 1106

MONUMENT SET: Set a 2 1/2" aluminum cap on a 2 1/2" x 30" aluminum pipe with top 3" above ground level, on East side of fence corner, marked as shown in "Monument Marking Detail".

From which:

- A silver deep-1 magnet, buried 18" in the ground, bears N 20 1/2° E, 30.7 feet.
- A purple deep-1 magnet, buried 18" in the ground, bears S 61° E, 37.5 feet.
- A blue deep-1 magnet, buried 18" in the ground, bears S 42° W, 33.1 feet.
- A brass washer stamped "PLS 1106", in a fence post, 1.0 feet above ground level, bears West, 46.4 feet.

Buried bearing object signs along with the deep-1 magnets. Attached bearing object sign to fence post with the brass washer. Attached "witness" sign to fence corner post West of corner monument.

LOCATION AND COMMENTS: Corner is located at a fence corner with fences West and North and an old field line South and partial fence extending East.

OREGON STATE PLANE CO-ORDINATES, OREGON NORTH, NAD 83(91): *fti*
N: 844914.42
E: 8631913.49

FIRM: William R. Wells, PLS
P.O. Box 1696
Pendleton, OR 97801

COMPASS DECLINATION: 18° East

Witnesses: Jason Wells, LSIT
Mark Hammersla
\6N32T13

Surveyor's Seal

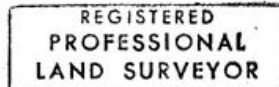

Will. R. Wells

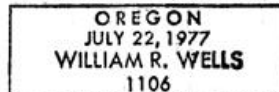

renews 6-30-02

RECEIVED BY
Umatilla County Surveyor
Date 9-01
Rec'd By [Signature]
No. 01-139-C