

Index
File No. K-9
T 5S R. 34E
Merid. WM

CORNER RECORD (SEARCH)

(Ref. FSM 7151.4)

Tract or
Survey No. _____
Cor. 11 of 16

R.D. LA GRANDE County UMATILLA
N.F. W-W State OREGON Sect 16 & 17

CORNER DIAGRAM

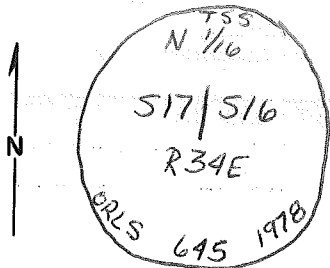

1 DESCRIBE CORNER MONUMENT FOUND 2 1/2" GALV PIPE w/ 3" BRASS CAP

2 DESCRIBE BEARING TREES OR OTHER OFFICIAL ACCESSORIES FOUND

6" LODGE POLE PINE SCRIBES VISIBLE BEARS N36° 21° FT
6" LODGE POLE PINE SCRIBES VISIBLE BEARS N60°W 15 25 FT

6 **PHOTO IDENTIFICATION DATA**

Photo No. _____
Filed At. _____
Object Ident. _____
Ident. By _____
Signature

3 DESCRIBE CORNER LOCATION RELATIVE TO NEAR-BY FEATURES, ALSO HOW TO REACH CORNER

7 **PLANE COORDINATE POSITION DATA**

State _____ Zone _____
X _____
Y _____
Estab. By _____
Agency

Signature

EARL E. STRANG

Title

CET

Division

LLL

Headquarters

GREZ

Date

6/16/93

7100-52-(3/68)

CORNER RECORD (PERPETUATION)

MONUMENT: DESCRIBE NEW MONUMENT SET, OR WORK DONE TO PRESERVE EXISTING MONUMENT

ACCESSORIES : DESCRIBE NEW BT'S WITNESS OBJECTS ETC. ESTABLISHED, OR WORK DONE TO PRESERVE EXISTING EVIDENCE

B.T.'S IN GOOD SHAPE
REPAINTED BLAZE & BAND ON B.T.'S

Work Done By _____ Title _____ Date _____ State Registration No. or Agency _____

Certified Cor. Record Prepared? Yes No Filed At: _____ Date _____

REMARKS

Index, File No. K79 T. 5 S R. 34E M. WM

Tract or Surv. No.

N 1/16 Cor. OF
SECT. 16 & 17

Index
File No. K-9
T 5 S R. 34 E
Merid. Willamette

CORNER RECORD (SEARCH)
(Ref. FSM 7151.4)

Tract or Survey No. _____
Cor. No. N-1/16
R.D. LaGrande County Union
N.F. WW-16 State Oregon

CORNER DIAGRAM

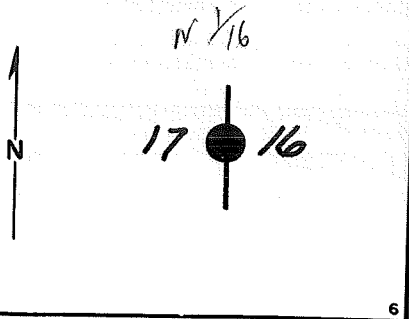

DESCRIBE CORNER MONUMENT FOUND

None

DESCRIBE BEARING TREES OR OTHER OFFICIAL ACCESSORIES FOUND

None

PHOTO IDENTIFICATION DATA

Photo No. _____
Filed At. _____
Object Ident. _____
Ident. By _____
Signature

DESCRIBE CORNER LOCATION RELATIVE TO NEAR-BY FEATURES, ALSO HOW TO REACH CORNER

Approx. 900 ft. N of road S536D.

PLANE COORDINATE POSITION DATA

State _____ Zone _____
X _____
Y _____
Estab. By _____
Agency

Signature
Hambleton

Title _____ Division **ORLS** Headquarters **645** Date **8-78**
7100-52-(3/68)

CORNER RECORD (PERPETUATION)

MONUMENT: DESCRIBE NEW MONUMENT SET, OR WORK DONE TO PRESERVE EXISTING MONUMENT

Set a 2 $\frac{1}{2}$ " x 30" iron pipe w/brass cap mkd.:
Large mound of stone around monument.

T 5 S
N-1/16
S 17 | S 16
R 34 E
1978
ORLS 645

9

ACCESSORIES : DESCRIBE NEW BT'S WITNESS OBJECTS ETC. ESTABLISHED, OR WORK DONE TO PRESERVE EXISTING EVIDENCE

5" pine bears N 60 W, 15.25 ft. scribed 1/16S S17 BT.
4" pine bears N 36 E, 21.0 ft. scribed 1/16S S16 BT.
Painted blaze and band of BT's red & yellow. Tagged trees w/54-3&4 signs.
Set steel fence post by mound of stone w/signs 54-4, 6&9.

10

Work Done By J. Hambleton Title Surveyor Date 8-78 State Registration No. ORLS 645
or Agency

Certified Cor. Record Prepared? Yes No Filed At: Union CS Date _____

11

REMARKS

Witnesses: L. Green
L. Shirley

12

Index File No. T. R. M. Tract or Surv. No. Cor. 13