

Index
File No. J-05

CORNER RECORD (SEARCH)

(Ref. FSM 7151.4)

Tract or Survey No. _____ Cor. No. _____

T 55 R. 34E

R.D. La Grande County Umatilla

Merid. Willamette

N.F. Wallows-Whitman State Oregon

CORNER DIAGRAM

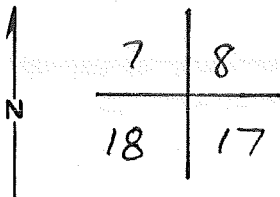

DESCRIBE CORNER MONUMENT FOUND

3" BRASS CAP ON 2" IRON PIPE
Rising 6"

COR
T55 R34E
57 | 58
518 | 517
ORE LIC 381
1969

DESCRIBE BEARING TREES OR OTHER OFFICIAL ACCESSORIES FOUND

12" L. Pine S81°W 39.5 FT Healed Blaze
23½" TAM S40°E 24.2 FT. "
11" Tam N35°E 34.4 FT. "
20" Tam N32°W 13.2 FT. "

PHOTO IDENTIFICATION DATA

Photo No. _____
Filed At. _____
Object Ident. _____
Ident. By _____
Signature

DESCRIBE CORNER LOCATION RELATIVE TO NEAR-BY FEATURES, ALSO HOW TO REACH CORNER

500 Ft. South Road 5160-630
0.6 Mi. from Rd. 5160-600
Location Poster on 6" L. Pine South side of Road.

PLANE COORDINATE POSITION DATA

State _____ Zone _____
X _____
Y _____
Estab. By _____
Agency

Signature

Title
LS 1844

Division

Headquarters

Date
6/84

FS-7100-52 (3/68)

CORNER RECORD (PERPETUATION)

MONUMENT: DESCRIBE NEW MONUMENT SET, OR WORK DONE TO PRESERVE EXISTING MONUMENT

PAINTED RED

Steel post w/ sign 54-4 2.0 FT. NORTH

ACCESSORIES: DESCRIBE NEW BT'S WITNESS OBJECTS ETC. ESTABLISHED, OR WORK DONE TO PRESERVE EXISTING EVIDENCE

Signs 54-3 & 54-4 Attached to trees.
6" Red Bands Painted around trees.

Work Done By D. Scott Title Surveyor Date 6/84 State Registration No. LS 1844
or Agency

Certified Cor. Record Prepared? Yes No Filed At: _____ Date _____

REMARKS

Index File No. T.5S R.34E W.M. Tract or Surv. No. _____ Cor. _____

J-05

Incl. 2
 File No. J-5
 T 5S R. 34E
 Merid. WILLAMETTE

CORNER RECORD (SEARCH)
 (Ref. FSM 7151.4)

Tract or Survey No. _____
 Cor. S.E. COR.
 No. SEC. 7

R.D. LAGRANDE County UNION
 N.F. WALLOWA-WHITMAN State OREGON

CORNER DIAGRAM

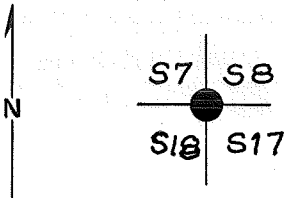

DESCRIBE CORNER MONUMENT FOUND

None

DESCRIBE BEARING TREES OR OTHER OFFICIAL ACCESSORIES FOUND

*Found - A pine log 10" diam. brs. N.42°E.
 Atamarack brs. N.32°W. 20 Lks. in
 good Condition.*

PHOTO IDENTIFICATION DATA

Photo No. _____
 Filed At. _____
 Object Ident. _____
 Ident. By _____
Signature

DESCRIBE CORNER LOCATION RELATIVE TO NEAR-BY FEATURES, ALSO HOW TO REACH CORNER

Road 5447

PLANE COORDINATE POSITION DATA

State _____ Zone _____
 X _____
 Y _____
 Estab. By _____
Agency

Signature
J. G. VOELZ

Title
Co. Surveyor

Division

Headquarters

Date
9/69

7100-52 (3/68)

CORNER RECORD (PERPETUATION)

MONUMENT: DESCRIBE NEW MONUMENT SET, OR WORK DONE TO PRESERVE EXISTING MONUMENT

Set a 2" galvanized pipe 30" LONG and with a bronze cap on top and an 8" plate welded to bottom. Pipe set to a depth of 20 ins. and back-filled with stone and soil.

ACCESSORIES : DESCRIBE NEW BT'S WITNESS OBJECTS ETC. ESTABLISHED, OR WORK DONE TO PRESERVE EXISTING EVIDENCE

*A tamarack 9" diam. brs. N.35°E. 34.4 ft. marked T.55. R34E. S18 B.T.
 A tamarack 20" diam. brs. S.10°E. 24.2 ft. marked T.55. R34E. S17 B.T.
 A Black Pine 11" diam. brs. S.81°W. 39.5 ft. marked T.55. R34E. S18 B.T.*

I set a steel fence post with U.S.F.S. sign 54-4 attached. I placed National Forest boundary signs on the post indicating N.F. Land to South and East. Bearing Tree signs were placed on the bearing trees, shoulder, high facing the corner; (distances measured to center of trees and mkd. with SCRIBE)

Work Done By: J.G. VOELZ Title Co. Surveyor Date 9/69 State Registration No. ORE. LIC. 381
 or Agency

Certified Cor. Record Prepared? Yes No Filed At: LA GRANDE, OREGON Date 9/69

REMARKS

LAND CORNER RECORD

5680-2

1. T 53 R 34E No. J-5 Cor. SEC. Mer. WILL State OREGON (Rectangular) N. F. WALLOWA-WHITMAN Dist. LA-GRANDE

2. Corner Status

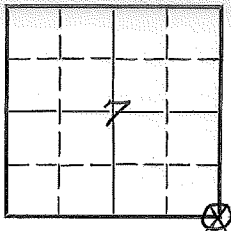

3. Original Description _____ Vol. _____ Page _____ Where Recorded _____

4. Description of Corners: POST 4' LONG, 4" SQ., 24" IN GROUND FOR SEC. COR.
FROM WHICH: A PINE 9" BEARS N42°E 47 LKS. DIST.
A TAMARACK 10" DIAM BEARS N32°W 25 LKS. DIST
A PINE 10" DIAM BEARS S58°W 13 DIST.
A PINE 8" DIAM BEARS S22°E 30 LKS. DIST

5. Investigation Notes:

18" WL. WITH VISIBLE SCRIBING IN SEC. 7.

PAINTED B.T. AND LINE N.

APPROX 522' S. TO COR. FROM ROAD
GO S. AT FOUR CORNERS ON STARKEY HWY
TO DRY CAMAS, TURN OFF ON FIRE ROAD
19B, LEFT, THEN RIGHT, PAST FIRST SEC. LINE
AND THEN COME TO A FENCE & ROAD RUNS
ALONG FENCE TO SEC. LINE.

7. Photo Identification

Photo No. _____

Ident. By: _____

8. Plane Coordinate Position Data

State _____ Zone _____

X _____

Y _____

Estab. By _____

Field Book No. _____

Where Filed _____

9. Evaluation

Authentic X

Needs Verif. _____ Monument NO

Re-estab. X Survey

Land Status _____

6. Signed T. WILLIAMS Title SUR. AID Date JUNE 7, 1966

PERPETUATION RECORD

10. Monument:

11. Accessories

Field Book _____ Page _____

12. Set By _____ Title _____

License _____ Agency _____ Date _____

13. Recorded By _____ Volume _____ Page _____
(Agency)

(Date) (City) (County) (State)

14. Remarks:

USDA-FOREST SERVICE

Index
File No. J-5

CORNER RECORD (SEARCH)

(Ref. FSM 7151.4)

Tract or
Survey No. _____

Cor.
No. J-5

T 5S R. 34E

R.D. Uria County Umatilla

Merid. Willamette

N.F. Umatilla State Oregon

CORNER DIAGRAM

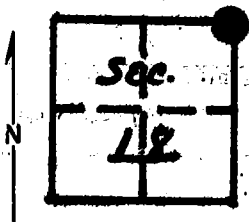

DESCRIBE CORNER MONUMENT FOUND

Material: Brass Cap Size: 3" dia.
Height Above Ground: 10" Condition: Good
Markings: 7 18 Brass Cap marked as below:

18 | 17

Cor. 234E
75/38
574517
off LC 381
1969

DESCRIBE BEARING TREES OR OTHER OFFICIAL ACCESSORIES FOUND

19" Tam. - N28°W - 10' dist. (orig.)
12" LPP - S79°W - approximately 50' (NEW)
23" Tam. - S12°E - 22' Dist. (orig.)
10" Tam. - N32E - 32' Dist. (NEW)
down BT 3' E. of 10" Tam.

PHOTO IDENTIFICATION DATA

Photo No. _____
Filed At. _____
Object Ident. _____
Ident. By _____

Signature

PLANE COORDINATE POSITION DATA

State _____ Zone _____
X _____
Y _____
Estab. By _____

Agency

Signature

Title _____ Division _____ Headquarters _____
Eng. Tech.

Date

7100-52 (3/68)

9/76

CORNER RECORD (PERPETUATION)

MONUMENT: DESCRIBE NEW MONUMENT SET, OR WORK DONE TO PRESERVE EXISTING MONUMENT

9

ACCESSORIES : DESCRIBE NEW BT'S WITNESS OBJECTS ETC. ESTABLISHED, OR WORK DONE TO PRESERVE EXISTING EVIDENCE

10

Work Done By _____ Title _____ Date _____ State Registration No. or Agency _____

11

Certified Cor. Record Prepared? Yes No Filed At: _____ Date _____

REMARKS

12

13

Index File No. T. R. M. Tract or Surv. No. Cor.