

Index
File No. E-5

CORNER RECORD (SEARCH)

(Ref. FSM 7151.4)

Tract or Survey No. _____ Cor. No. _____

T 5S R. 34E

R.D. LaGrande County Umatilla

Merid. Willamette

N.F. Wallowa Whitman State Oregon

CORNER DIAGRAM

T5S R34E

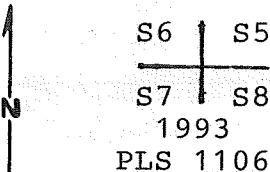

DESCRIBE CORNER MONUMENT FOUND

None. Reset corner from found bearing tree remains, by distance-distance intersection.

DESCRIBE BEARING TREES OR OTHER OFFICIAL ACCESSORIES FOUND

A 16" western larch snag bears S64°E-62 links with open blaze and visible scribing.
A 22" broken western larch up snag N45°W-78 links with blaze lying on ground in front of stump.

PHOTO IDENTIFICATION DATA

Photo No. _____
Filed At. _____
Object Ident. _____
Ident. By _____

Signature _____

PLANE COORDINATE POSITION DATA

State _____ Zone _____
X _____
Y _____
Established By _____
Agency _____

DESCRIBE CORNER LOCATION RELATIVE TO NEAR-BY FEATURES, ALSO HOW TO REACH CORNER

Corner is on North slope at the South edge of an opening. Approximately 1300 feet North of the start of Road 5160-650.

Signature

Willie R. Wells

Title

PLS

Division

Headquarters

Pendleton, OR

Date

10/22/93

FS-7100-52 (3/68)

CORNER RECORD (PERPETUATION)

MONUMENT: DESCRIBE NEW MONUMENT SET, OR WORK DONE TO PRESERVE EXISTING MONUMENT

Set 2½" aluminum cap on 2½"x30" aluminum pipe, 24" in ground with mound of stone to cap, marked as shown in corner diagram.
Attached sign 54-9 to steel fence post, set 4.0 feet North of monument.

ACCESSORIES : DESCRIBE NEW BTs WITNESS OBJECTS ETC. ESTABLISHED, OR WORK DONE TO PRESERVE EXISTING EVIDENCE

A 9½" western larch bears N10½°W- 57.3 feet, scribed: T5SR34ES6 BT.
A 13" western larch bears N11°E- 36.2 feet, scribed: T5SR34ES5 BT.
A 20" white fir bears S52°E- 50.0 feet, scribed: T5SR34ES8 BT.
A 14" white fir bears S57°W- 37.5 feet, scribed: T5SR34ES7 BT.
Bearing trees have brass washer stamped 'PLS 1106' nailed to the face of the blaze. Attached sign 54-3 & 54-9, painted face of blaze & a 6" red band around each bearing tree.

Work Done By WR Wells Title PLS Date _____ State Registration No. PLS 1106
or Agency _____

Certified Cor. Record Prepared? Yes No Filed At: Co. Surveyor Office Date 8/94

REMARKS

Index File No. E-5 T. 5S R. 34E M. Willamette Tract or Surv No

Cor.

Index File No. E-5

CORNER RECORD (SEARCH)

(Ref. FSM 7151.4)

T 5S R. 34E

R.D. LA GRANDE

County UMATILLA

Tract or Survey No. _____

Cor. No. Sect.

Merid. WM

N.F. W-W

State OREGON

Corner of Section 6, 5, 7 & 8

CORNER DIAGRAM

T5S R34E

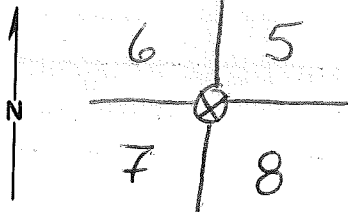

DESCRIBE CORNER MONUMENT FOUND

6"x8"x16" BASALT STONE 12" ABOVE

DESCRIBE BEARING TREES OR OTHER OFFICIAL ACCESSORIES FOUND

PHOTO IDENTIFICATION DATA

Photo No. _____

Filed At. _____

Object Ident. _____

Ident. By _____

Signature

PLANE COORDINATE POSITION DATA

State _____ Zone _____

X _____

Y _____

Estab. By _____

Agency

Signature

EARL E. STRANG

Title

CET

Division

LLU

Headquarters

GREZ

Date

7/26/93

7100-52-(3/68)

4

5

CORNER RECORD (PERPETUATION)

MONUMENT : DESCRIBE NEW MONUMENT SET, OR WORK DONE TO PRESERVE EXISTING MONUMENT

ACCESSORIES : DESCRIBE NEW BT'S WITNESS OBJECTS ETC. ESTABLISHED, OR WORK DONE TO PRESERVE EXISTING EVIDENCE

Work Done By _____ Title _____ Date _____ State Registration No. _____
or Agency _____

Certified Cor. Record Prepared ? Yes No Filed At: _____ Date _____

REMARKS

Index File No. T. R. M. Tract or Surv. No. Cor.

LAND CORNER RECORD

CORNER FOUND ON 1965 MAP 5680-2

(Rectangular)

1. T. 5S R. 34E No. E-5 Cor. SEC. Mer. WILL State OREGON N. F. WALLOWA-WHITMAN Dist. LA GRANDE

2. Corner Status

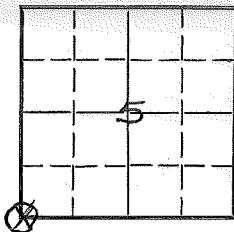

7. Photo Identification

Photo No. _____
Ident. By: _____

8. Plane Coordinate Position Data

State _____ Zone _____
X _____
Y _____

Estab. By _____

Field Book No. _____

Where Filed _____

9. Evaluation

Authentic _____ X
Needs Verif. _____ Monument NO
Re-estab. X Survey
Land Status _____

3. Original Description _____ Vol. _____ Page _____ Where Recorded _____

4. Description of Corners: BASALT STONE 13"x12"x6", 9" IN GROUND FOR SEC. COR.
FROM WHICH: A TAMARACK 15" DIAM. BEARS N35°E 23 LKS. DIST.
A TAMARACK 20" DIAM BEARS N45°W 78 LKS. DIST.
A TAMARACK 24" DIAM BEARS S65°W 6 LKS. DIST
A TAMARACK 32" DIAM BEARS S64°E 62 LKS. DIST.

5. Investigation Notes:

20" W.L. LIVE IN SEC. 6 WITH VISIBLE SCRIBING
20" W.L. DEAD STANDING IN SEC. 8 WITH
SCRIBING READABLE

PAINTED BOTH B.T.'S WITH RED PAINT.

GO SOUTH AT FOUR CORNERS ON STARKEY
HWY TO DRY CAMAS, EAST TO SEC. LINE APPROX.
1620' SOUTH OR TURN OFF DRY CAMAS, ON
FIRE RD. 19B TO SEC. LINE AND 1986' N. TO COR.

NOTE DEAD W.L. WITH BLAZE IN SEC. 5
BUT NO SCRIBING VISIBLE

6. Signed T. WILLIAMS. Title SUR. TECH Date JUNE 7, 1966

PERPETUATION RECORD

10. Monument:

11. Accessories

Field Book _____ Page _____

12. Set By _____ Title _____

License _____ Agency _____ Date _____

13. Recorded By _____ Volume _____ Page _____

(Agency)

(Date) _____ (City) _____ (County) _____ (State) _____

14. Remarks:

PROPERTY CORNER INVESTIGATION

56A

E-5

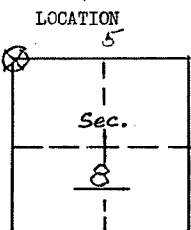

T. 55 R. 34 E
 Mer. Will State Oreg
 Forest WW Dist. La Grande

LEGEND

- Corner searched-no evidence
- Corner or accessory found
- Corner marked by perm. mon.

E-5

DESCRIPTION OF FOUND CORNER

MATERIAL: None Found SIZE: _____
 HEIGHT ABOVE GROUND: _____ CONDITION: _____
 MARKINGS: _____

DESCRIPTION OF FOUND ACCESSORIES

20" WL live in sec 6 with visible scribing
20" WL Dead standing in sec 8 with scribing readable

NOTE: Indicate full investigative details on back of form.

PHOTO IDENTIFICATION

Symbol & date _____ Line or Roll _____ Exposure _____
 How Identified _____ Where filed _____

RECOVERED BY: T. Williams

DATE: June 9, 1966 TITLE: Surveying Tech.

1211 1111 0.1. red

Go S. at Four Corner on Starkey
Hwy. to Dry Camas, East to
Sec line and approximately 1620'
South or turn off Dry Camas
on Fire road 1915 to Sec line
and 1386' N. to cor.

Note Dead W.L. with blaze
in sec 5 but no scribing
visible

USDA-FOREST SERVICE

Index

File No. E-5

CORNER RECORD (SEARCH)

(Ref. FSM 7151.4)

Tract or

Survey No. _____

No. E-5

T 5S R. 34E

R.D. Ukiah County _____

Umatilla

Merid. Willamette

N.F. Umatilla State _____

Oregon

CORNER DIAGRAM

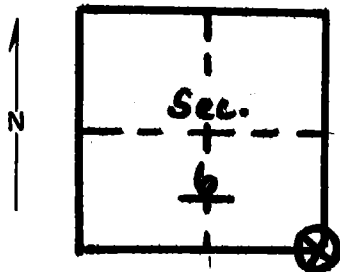

DESCRIBE CORNER MONUMENT FOUND

None

DESCRIBE BEARING TREES OR OTHER OFFICIAL ACCESSORIES FOUND

20" Tam. - NW Quadrant - blazed SE face, scribed: T5S, R34E, S6 with bearing tree poster dated: '73. 28" P. Pine in NE Quadrant with closed SW blaze and rusted location poster on blaze. (possible B.T.) No definite evidence in SW Quadrant. 18" Tam. Snag in SE Quadrant blazed NW face, scribed: T5S, R34E, S8, B.T. Bearing tree poster above blaze.

PHOTO IDENTIFICATION DATA

Photo No. _____

Filed At. _____

Object Ident. _____

Ident. By _____

Signature

PLANE COORDINATE POSITION DATA

State _____ Zone _____

X _____

Y _____

Estab. By _____

Agency

Signature

Title

Division

Headquarters

Date

7100-52-(3/68)

Bill Moore

Eng. Tech.

8/77

CORNER RECORD (PERPETUATION)

MONUMENT: DESCRIBE NEW MONUMENT SET, OR WORK DONE TO PRESERVE EXISTING MONUMENT

9

ACCESSORIES : DESCRIBE NEW BT'S WITNESS OBJECTS ETC. ESTABLISHED, OR WORK DONE TO PRESERVE EXISTING EVIDENCE

Blaze line North of South Corner found following blaze line South
from 1/4 corner.

10

Work Done By _____ Title _____ Date _____ State Registration No.
or Agency _____

Certified Cor. Record Prepared ? Yes No Filed At: _____ Date _____ 11

REMARKS

12

Index File No. T. R. M. Tract or Surv. No. Cor. 13

LAND CORNER RECORD

CORNER FOUND ON 1965 MAR 5680-2

(Rectangular)

NAME

1. T. SS R. 346 No. E-5 Cor. SEC. Mer. Will State OREGON N. F. WALLOWA-WHITMAN Dist. LA GRANDE

2. Corner Status

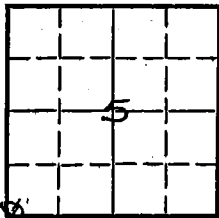

7. Photo Identification

Photo No. _____

Ident. By: _____

8. Plane Coordinate Position Data

State _____ Zone _____

X _____

Y _____

Estab. By _____

Field Book No. _____

Where Filed _____

9. Evaluation

Authentic _____ _____

Needs Verif. _____ Monument NO

Re-estab. Survey _____

Land Status _____

3. Original Description _____ Vol. _____ Page _____ Where Recorded _____

4. Description of Corners: BASALT STONE 13" x 12" x 6", 9" IN GROUND FOR SEC. COR.
 FROM WHICH: A TAMARACK 15" DIAM. BEARS N35°E 23 LKS. DIST.
A TAMARACK 20" DIAM BEARS N45°W 78 LKS. DIST.
A TAMARACK 24" DIAM BEARS S65°W 6 LKS. DIST
A TAMARACK 32" DIAM BEARS S64°E 62 LKS. DIST.

5. Investigation Notes:

20" W/L. LIVE IN SEC. 6 WITH VISIBLE SCRIBING
20" W/L. DEAD STANDING IN SEC. 8 WITH
SCRIBING READABLE

PRINTED BOTH B.T.S WITH RED PAINT.

GO SOUTH AT FOUR CORNERS ON STARKEY
Hwy TO DRY CAMAS, EAST TO SEC. LINE APPROX.
1620' SOUTH OR TURN OFF DRY CAMAS. ON
FIRE RD. 19B TO SEC. LINE AND 1986' N. TO COR.

NOTE DEAD W/L. WITH BLAZE IN SEC. 5
BUT NO SCRIBING VISIBLE

6. Signed T. WILLIAMS Title SUR. TECH Date JUNE 7, 1966