

USDA-FOREST SERVICE

Index
File No. G-23

CORNER RECORD (SEARCH)

(Ref. FSM 7151.4)

Tract or
Survey No. _____ No. G-23

T 5S R. 33½E R.D. Ukiah County Umatilla

Merid. Willamette N.F. Umatilla State Oregon

CORNER DIAGRAM

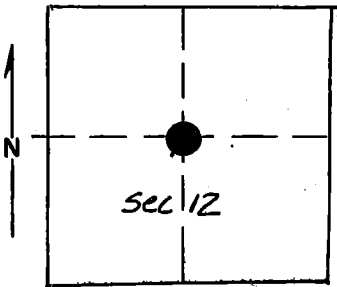

DESCRIBE CORNER MONUMENT FOUND

None

DESCRIBE BEARING TREES OR OTHER OFFICIAL ACCESSORIES FOUND

None.

PHOTO IDENTIFICATION DATA

Photo No. _____

Filed At. _____

Object Ident. _____

Ident. By _____

Signature

PLANE COORDINATE POSITION DATA

State _____ Zone _____

X _____

Y _____

Estab. By _____

Agency

DESCRIBE CORNER LOCATION RELATIVE TO NEAR-BY FEATURES, ALSO HOW TO REACH CORNER

From Frazier Guard Station, go East 0.75 mile on Road S552 to N¼ Section 12. Then walk South 40 chains up a North slope to corner.

Signature

Terry C. Hamby

Title

Division

O.P.L.S.

Headquarters

1638

Date

8/78

7100-52-(3/68)

5

CORNER RECORD (PERPETUATION)

MONUMENT: DESCRIBE NEW MONUMENT SET, OR WORK DONE TO PRESERVE EXISTING MONUMENT

T 5S R 33½E

Set 2½" x 30" iron pipe with brass cap.

C¼

S 12

Pipe is 22" in ground

Stamped:

1978

PLS 933

9

ACCESSORIES : DESCRIBE NEW BT'S WITNESS OBJECTS ETC. ESTABLISHED, OR WORK DONE TO PRESERVE EXISTING EVIDENCE

Fir 10" diameter bears North 78°15' West 3.95 feet with signs 54-3 and 54-4.
 Tamarack 12" diameter bears South 08°00' East 14.55 feet with signs 54-3 and 54-4.

Set steel post 5 feet East with sign 54-4.
 Painted red band around trees.

10

Work Done By T. Hamby Title Surveyor Date 7/20/78 State Registration No. 0.P.L.S. 1638
 or Agency

Certified Cor. Record Prepared? Yes No Filed At: Umatilla County Surveyor Date 8-8-78

11

REMARKS

Witness by Richard Barton and William Hampton

12

Index File No. T. R. M. Tract or Surv. No. Cor. 13