

USDA-FOREST SERVICE

Index File No. G-17

CORNER RECORD (SEARCH)

(Ref. FSM 7151.4)

Tract or Survey No. _____ No. G-17

T 5S R. 33½E

R.D. Ukiah County Umatilla

Merid. Willamette

N.F. Umatilla State Oregon

CORNER DIAGRAM

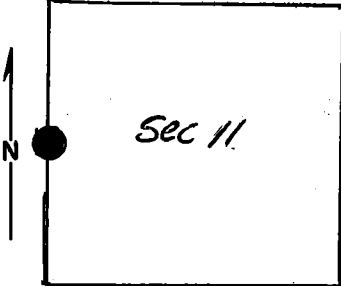

DESCRIBE CORNER MONUMENT FOUND

None

DESCRIBE BEARING TREES OR OTHER OFFICIAL ACCESSORIES FOUND

None

PHOTO IDENTIFICATION DATA

Photo No. _____

Filed At. _____

Object Ident. _____

Ident. By _____

Signature

PLANE COORDINATE POSITION DATA

State _____ Zone _____

X _____

Y _____

Estab. By _____

Agency

DESCRIBE CORNER LOCATION RELATIVE TO NEAR-BY FEATURES, ALSO HOW TO REACH CORNER

From intersection of Roads S552 and S534, which is about 700 feet West of Frazier Guard Station, go South on Road S534 about 3/4 mile to a jeep road to the right. Follow it for about 1/2 mile. The corner is South of the road 9.3 chains in density trees.

Signature

Fern C. Nantz

Title

Division
O.P.L.S.

Headquarters
1638

Date
8/78

7100-52-(3/68)

CORNER RECORD (PERPETUATION)

MONUMENT: DESCRIBE NEW MONUMENT SET, OR WORK DONE TO PRESERVE EXISTING MONUMENT

T 5S R 33½E

Set 2½" x 30" iron pipe with brass cap (stamped)
 Pipe is 15" in ground with stone mound
 raised to within 3" of top.

¼
 S 10 | S 11
 1978
 PLS 933

9

ACCESSORIES : DESCRIBE NEW BT'S WITNESS OBJECTS ETC. ESTABLISHED, OR WORK DONE TO PRESERVE EXISTING EVIDENCE

Fir 10" diameter bears North 56°51' West 13.65 feet with sign 54-3 and 54-5 on tree.
 Fir 8" diameter bears South 85°35' East 33.00 feet with sign 54-3 and 54-4 on tree.

Set steel post 3 feet North with sign 54-4
 painted red band around trees.

10

Work Done By T. Hamby Title Surveyor Date 7/19/78 State Registration No. O.P.L.S. 1638
 or Agency

Certified Cor. Record Prepared? Yes No Filed At: Umatilla County Surveyor Date 8-8-78

11

REMARKS

Witness by Richard Barton and William Hampton.

12

Index File No.

T.

R.

M.

Tract or Surv. No.

Cor.

13