

USDA-FOREST SERVICE

Index File No. F-23

CORNER RECORD (SEARCH)
(Ref. FSM 7151.4)

Tract or Survey No. _____ No. F-23

T 5S R. 33½E

R.D. Ukiah County Umatilla

Merid. Willamette

N.F. Umatilla State Oregon

CORNER DIAGRAM

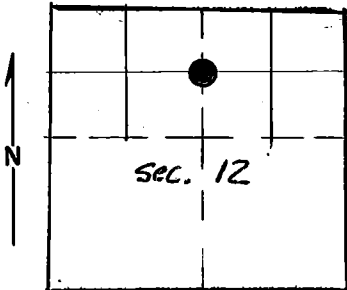

DESCRIBE CORNER MONUMENT FOUND

None

DESCRIBE BEARING TREES OR OTHER OFFICIAL ACCESSORIES FOUND

None

PHOTO IDENTIFICATION DATA

Photo No. _____

Filed At. _____

Object Ident. _____

Ident. By _____

Signature

PLANE COORDINATE POSITION DATA

State _____ Zone _____

X _____

Y _____

Estab. By _____

Agency

DESCRIBE CORNER LOCATION RELATIVE TO NEAR-BY FEATURES, ALSO HOW TO REACH CORNER

From Frazier Guard Station, go East 0.75 mile on Road S552 to N¼ Section. Then walk South 20.5 chains to corner. Corner in clearing and about 110 feet North of East-West fences.

Signature

Terry C. Hambr

Title

Division

O.P.L.S.

Headquarters

1638

Date

8/78

7100-52-(3/68)

5

CORNER RECORD (PERPETUATION)

MONUMENT: DESCRIBE NEW MONUMENT SET, OR WORK DONE TO PRESERVE EXISTING MONUMENT T 5S R 33½E

Set 2½" x 30" iron pipe with brass cap.

Stamped: N 17/16 S 12
C
C
1978 PLS 933

ACCESSORIES : DESCRIBE NEW BT'S WITNESS OBJECTS ETC. ESTABLISHED, OR WORK DONE TO PRESERVE EXISTING EVIDENCE

Fir 10" diameter bears South 68°21' West 108.70 feet with signs 54-3 and 54-4.
Fir 16" diameter bears South 11°00' East 118.60 feet with signs 54-3 and 54-4.

Set steel post 3 feet West with signs 54-2 and 54-4.
Painted red band around trees.

Work Done By T. Hamby Title Surveyor Date 7/20/78 State Registration No. O.P.L.S. 1638
or Agency

Certified Cor. Record Prepared ? Yes No Filed At: Umatilla County Surveyor Date 8-8-78

REMARKS

Witness by Richard Barton and William Hampton.

Index File No. T. R. M. Tract or Surv. No. Cor.