

CERTIFIED RECORD OF LAND CORNER MONUMENTATION

Indes File No. B-18

History of original corner establishment:

No corner was originally set

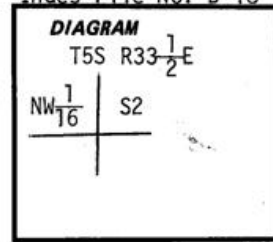

Description of corner evidence found:

Description of monument and accessories established to perpetuate the original location of this corner:

At surveyed point set 2 1/2"x30" galvanized pipe with brass cup stamped:

Set pipe 22" in ground with mound of stone of cap.

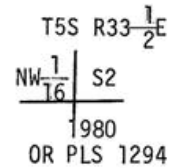

Bearing Trees:

A Lodge Pole Pine 7" dia. bears S62°W, 47.8 ft., scribed NW1/16 S2 BT.
A Lodge Pole Pine 7" dia. bears N33°W 52.6 ft., scribed NW 1/16 S2 BT.

Attached 54-3 & 54-4 signs to both BTs. Attached brass washer stamped LS1294 to foot blaze of both BTs. Painted blazes and 6" band around both BTs Red. Attached 54-2 & 54-4 signs to metal post 5' south of corner. Attached 54-2 & 54-9 signs to metal post 5' west of corner.

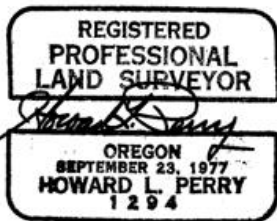

I hereby certify the above corner monument was established as herein described on June 27, 1980.

Witnesses: R. Orton
G. Orgon
D. Allen

Office of.....County Surveyor..... County of.....Umatilla.....
State of.....Oregon....., I hereby certify that the within instrument was filed in this office
for record on the..... day of.....December..... 19.....80
..... by.....
(COUNTY OFFICIAL) (DEPUTY)

R-187-B