

USDA-FOREST SERVICE

Index

File No. ZZ-5

CORNER RECORD (SEARCH)

No. Fk. (Ref. FSM 7151.4)

Tract or Survey No. _____

Cor. No. _____

T 58 R. 33E

R.D. John Day County _____

Umatilla

Merid. W.M.

N.F. Umatilla State _____

Or.

CORNER DIAGRAM



T58 R33E
S C
S31/S32
S5
T68

DESCRIBE CORNER MONUMENT FOUND

2 1/2" iron pipe with 2 1/2" brass cap mkd.: T58 R33E

S31/S32

S5

T68

1984

PLS 933

DESCRIBE BEARING TREES OR OTHER OFFICIAL ACCESSORIES FOUND

P. Pine stump, badly decayed, Size indeterminate, scribing visible, N67°W, 25.7'
L. Pine, 9", N51°W, 81.6'; scribing visible
P. Pine, 28", N21°E, 61.8' " "

PHOTO IDENTIFICATION DATA

Photo No. _____

Filed At. _____

Object Ident. _____

Ident. By _____

Signature

PLANE COORDINATE POSITION DATA

State _____ Zone _____

X _____

Y _____

Estab. By _____

Agency

DESCRIBE CORNER LOCATION RELATIVE TO NEAR-BY FEATURES, ALSO HOW TO REACH CORNER

Cor. falls on SWly slope, N of Cable Cr.
Posted line to N.

Signature

F L Munro

Title

PLS

Division

Headquarters

Date

10/26/91

7100-52-(3,68)

CORNER RECORD (PERPETUATION)

MONUMENT: DESCRIBE NEW MONUMENT SET, OR WORK DONE TO PRESERVE EXISTING MONUMENT

None.

ACCESSORIES : DESCRIBE NEW BT'S WITNESS OBJECTS ETC. ESTABLISHED, OR WORK DONE TO PRESERVE EXISTING EVIDENCE

D. Fir, 11", N47 3/4°E, 39.7'; mkd.: T5S R33E S32 SO BT

5/8" x 30" rebar, 25" in ground, N63 1/4°E, 14.6';

with 1 1/4" yellow plastic cap mkd.: PLS 1832

BTs have red blaze and band, BT tags and 54-9 signs. New BTs have alum. "PLS 1832" washers. 6' fence post with 54-9 sign within 5' of cor.

Work Done By F.S. Munro Title PLS Date 6/14/91 State Registration No. 1832
or Agency

Certified Cor. Record Prepared? Yes No Filed At: Umatilla Co. Surveyor Date

REMARKS

Index File No.

Z-5

T.

58

R.

33E

M.

W.M.

Tract or Surv. No.

Cor.

USDA-FOREST SERVICE

Index
File No. 2-5

CORNER RECORD (SEARCH)

(Ref. FSM 7151.4)

Tract or
Survey No. _____

Cor.
No. _____

T 53 R. 33E

R.D. Ukiah

County Umatilla

Merid. Willamette

N.F. Umatilla

State Oregon

CORNER DIAGRAM

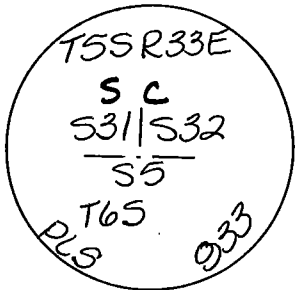

DESCRIBE CORNER MONUMENT FOUND

None

DESCRIBE BEARING TREES OR OTHER OFFICIAL ACCESSORIES FOUND 2

A 30" Ponderosa Pine stump with a partly healed blaze. "BT" scribe is visible
Stump has signs # 54-3 & 54-4

PHOTO IDENTIFICATION DATA 6

Photo No. _____
Filed At. _____
Object Ident. _____
Ident. By _____
Signature

DESCRIBE CORNER LOCATION RELATIVE TO NEAR-BY FEATURES, ALSO HOW TO REACH CORNER 3

From Hildaway Springs, go south on 5450 3.5 mi to road on right, take road 0.7 mi to fork to right, follow road 0.7 mi to fence, walk west along fence 0.5 mi to corner $\frac{32}{514}$, continue west to corner

PLANE COORDINATE POSITION DATA

State _____ Zone _____
X _____
Y _____
Estab. By _____
Agency

Signature
David H Kle

Title
PLS 933

Division

Headquarters

Date
7/16/84

7100-52-(3,68)

CORNER RECORD (PERPETUATION)

MONUMENT: DESCRIBE NEW MONUMENT SET, OR WORK DONE TO PRESERVE EXISTING MONUMENT

Set a 2 1/2" dia. Brass Cap on a 2 1/2" x 30" galvanized pipe 20" in the ground.
Built a small stone mound around the Brass Cap.

ACCESSORIES : DESCRIBE NEW BT'S WITNESS OBJECTS ETC. ESTABLISHED, OR WORK DONE TO PRESERVE EXISTING EVIDENCE.

A 24" Ponderosa Pine bears N 21° E, 65.5 feet scribed T55 R33E S32100 BT
A 8" dia. Lodgepole Pine bears N 51° W, 81.6 feet scribed T55 R33E S 31 S 0 BT
A steel fence post with sign #54-4 is by the corner
BT'S have red painted blazes, and bands around them. BT'S also have
Brass Washers stamped PLS 933 nailed to the "BT" scribe

Work Done By R. Panches Title Party Chief Date 7/9/84 State Registration No. or Agency _____

Certified Cor. Record Prepared? Yes No Filed At: Umatilla Co. Surveyor Date 7/24/84

REMARKS

USDA-FOREST SERVICE

Index
 File No. Z-5
 T 55 R. 33E
 Merid. WILL

CORNER RECORD (SEARCH)

(Ref. FSM 7151.4)

Tract or Survey No. _____ Cor. No. _____
 R.D. UKIAH County UMATILLA
 N.F. UMATILLA State OREGON

CORNER DIAGRAM

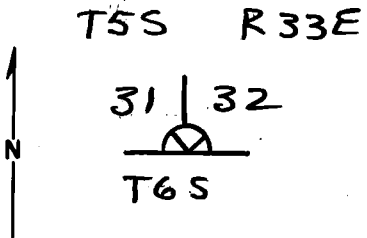

DESCRIBE CORNER MONUMENT FOUND

NONE - STONE MAY HAVE BEEN DISTURBED BY LOGGING.

DESCRIBE BEARING TREES OR OTHER OFFICIAL ACCESSORIES FOUND

A LARGE POND. PINE STUMP (SAWN) BEARS N67°W, 25' FT. W/A CHARRED & PARTLY HEALED BLAZE. SCRIBING "BT" IS VISIBLE. N.E. BT IS GONE.

PHOTO IDENTIFICATION DATA

Photo No. _____
 Filed At. _____
 Object Ident. _____
 Ident. By _____
 Signature _____

51' BEARS EAST, 33° FT. (STEEL POST AT CORNER)
 DESCRIBE CORNER LOCATION RELATIVE TO NEAR-BY FEATURES, ALSO HOW TO REACH CORNER

PLANE COORDINATE POSITION DATA

State _____ Zone _____
 X _____
 Y _____
 Estab. By _____
 Agency _____

Signature Dennis L. Layland Title _____ Division PLS Headquarters 1636 Date 8-31-82
 7100-52 (3. 68)

CORNER RECORD (PERPETUATION)

MONUMENT: DESCRIBE NEW MONUMENT SET, OR WORK DONE TO PRESERVE EXISTING MONUMENT

ACCESSORIES : DESCRIBE NEW BT's WITNESS OBJECTS ETC. ESTABLISHED, OR WORK DONE TO PRESERVE EXISTING EVIDENCE

Work Done By _____ Title _____ Date _____ State Registration No. _____
or Agency _____

Certified Cor. Record Prepared ? Yes No Filed At: _____ Date _____

REMARKS

Index File No. T. R. M. Tract or Surv. No. Cor.

USDA-FOREST SERVICE

Index
File No. Z-5

CORNER RECORD (SEARCH)

(Ref. FSM 7151.4)

Tract or
Survey No. _____ Cor.
No. Z-5

T 5 S R. 33 E

R.D. Ukiah County _____

Merid. With

N.F. umat. State Ore.

CORNER DIAGRAM

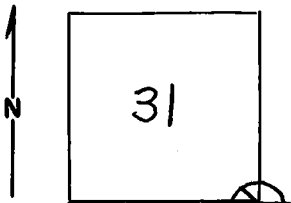

DESCRIBE CORNER MONUMENT FOUND

Material: None.
Probable location is in skid trail.

DESCRIBE BEARING TREES OR OTHER OFFICIAL ACCESSORIES FOUND

NW Quad: 40" Pine stump with blaze (lower), no scribing visible but it is only 40" tree in area.
Approx. 40' West of Sec. 514 T6S,R33E.

PHOTO IDENTIFICATION DATA

Photo No. _____
Filed At. _____
Object Ident. _____
Ident. By _____
Signature

DESCRIBE CORNER LOCATION RELATIVE TO NEAR-BY FEATURES, ALSO HOW TO REACH CORNER

PLANE COORDINATE POSITION DATA

State _____ Zone _____
X _____
Y _____
Estab. By _____
Agency

Signature
B. Moore

Title

Division

Headquarters

7-27-79

Date

7100-52-(3/68)

CORNER RECORD (PERPETUATION)

MONUMENT: DESCRIBE NEW MONUMENT SET, OR WORK DONE TO PRESERVE EXISTING MONUMENT

ACCESSORIES : DESCRIBE NEW BT'S WITNESS OBJECTS ETC. ESTABLISHED, OR WORK DONE TO PRESERVE EXISTING EVIDENCE

Work Done By _____ **Title** _____ **Date** _____ **State Registration No.** _____
or Agency _____

Certified Cor. Record Prepared ? Yes No **Filed At:** _____ **Date** _____

REMARKS

Index File No. _____ **T.** _____ **R.** _____ **M.** _____ **Tract or Surv. No.** _____ **Cor.** _____

U.S. G.P.O. 1977-725-576/586